



**Lavender House, Bigfrith Lane, Cookham, Maidenhead SL6 9PH**

**welcome to**

**Lavender House, Bigfrith Lane, Cookham, Maidenhead**

Spacious 2,600 sq ft five bedroom, four bathroom semi-detached character home in a lovely semi-rural setting; requires some updating and has no chain.





## Bigfrith Lane, Cookham, Maidenhead, SL6

Approximate Area = 2540 sq ft / 235.9 sq m  
Limited Use Area(s) = 59 sq ft / 5.4 sq m  
Garage = 170 sq ft / 15.7 sq m  
Total = 2769 sq ft / 257 sq m

For identification only - Not to scale

Denotes restricted head height

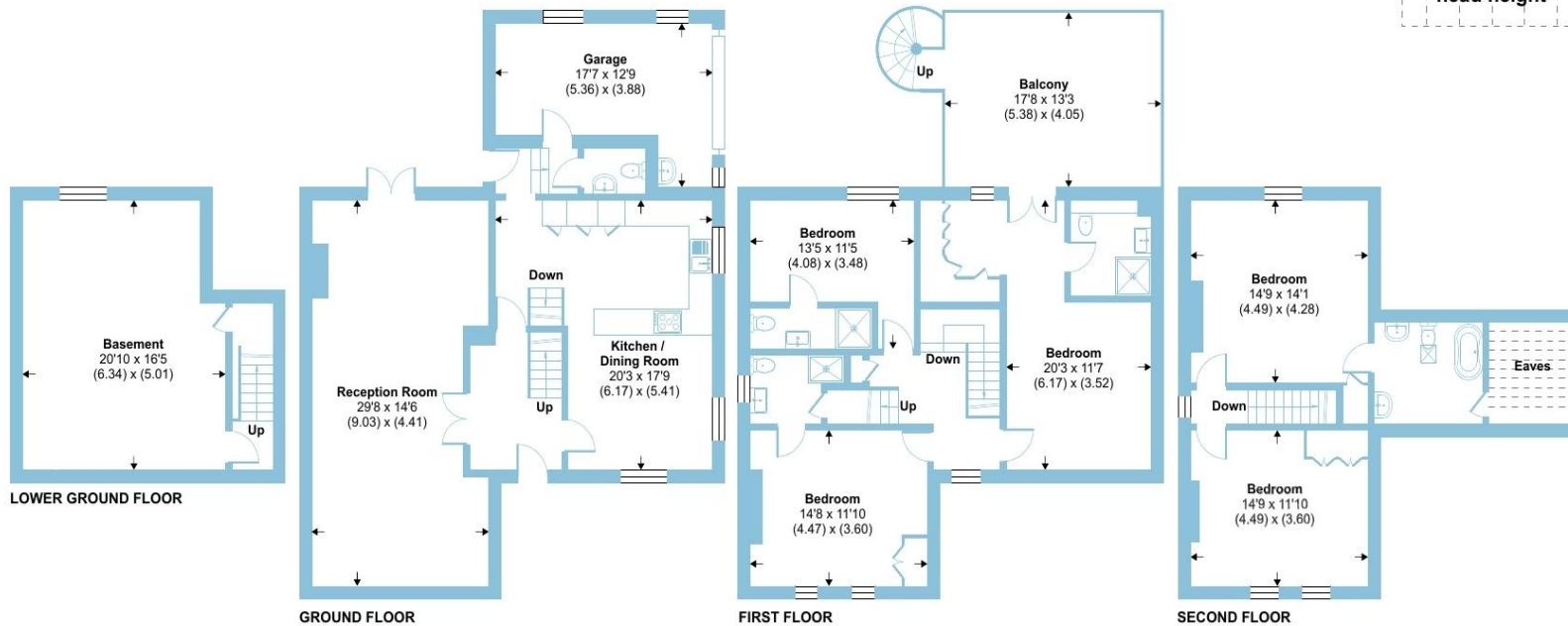

Occupying a delightful setting surrounded by open land, this impressive property provides generous living space ideal for modern family life.

Arranged over three floors, with the added benefit of a basement area, the home features a welcoming and spacious ground floor comprising a large sitting room, perfect for both relaxing and entertaining. The heart of the home is the superb open-plan kitchen and family area, offering excellent proportions and a sociable layout. A cloakroom and internal access to the large garage complete this level.

On the first floor, the principal bedroom suite enjoys a dressing area and a stylish en-suite bathroom, with doors opening onto a private balcony that takes full advantage of the stunning surrounding views. Two further well-proportioned double bedrooms, both with en-suite facilities, provide excellent accommodation for family or guests. The upper floor offers two additional double bedrooms along with a family bathroom, ensuring ample space and flexibility.

Externally, the property benefits from a pleasant garden, while to the front there is off-street parking and side access leading to the garage. This is a rare opportunity to acquire a spacious and characterful home in an enviable semi-rural setting.

welcome to

## Lavender House, Bigfrith Lane, Cookham

- CHARACTER SEMI-DETACHED HOUSE - 2,600 SQ FT
- FIVE DOUBLE BEDROOMS
- EN SUITE & ROOF TERRACE TO MAIN BEDROOM
- FOUR FURTHER DOUBLE BEDROOMS
- LARGE OPEN PLAN KITCHEN/FAMILY AREA
- LOVELY SEMI-RURAL LOCATION
- REQUIRES SOME UPDATING
- NO CHAIN

Tenure: Freehold EPC Rating: D  
Council Tax Band: G

**£900,000**



Please note the marker reflects the  
postcode not the actual property

check out more properties at [rogerplatt.co.uk](http://rogerplatt.co.uk)



Property Ref:  
MHD123887 - 0001

1. MONEY LAUNDERING REGULATIONS Intending purchasers will be asked to produce identification documentation at a later stage and we would ask for your co-operation in order that there is no delay in agreeing the sale. 2. These particulars do not constitute part or all of an offer or contract. 3. The measurements indicated are supplied for guidance only and as such must be considered incorrect. Potential buyers are advised to recheck measurements before committing to any expense. 4. We have not tested any apparatus, equipment, fixtures or services and it is in the buyers interest to check the working condition of any appliances. 5. Where an EPC, or a Home Report (Scotland only) is held for this property, it is available for inspection at the branch by appointment. If you require a printed version of a Home Report, you will need to pay a reasonable production charge reflecting printing and other costs. 6. We are not able to offer an opinion either written or verbal on the content of these reports and this must be obtained from your legal representative. 7. Whilst we take care in preparing these reports, a buyer should ensure that his/her legal representative confirms as soon as possible all matters relating to title including the extent and boundaries of the property and other important matters before exchange of contracts.

Roger Platt is a trading name of Sequence (UK) Limited which is registered in England and Wales under company number 4268443, Registered Office is Cumbria House, 16-20 Hockliffe Street, Leighton Buzzard, Bedfordshire, LU7 1GN. VAT Registration Number is 500 2481 05.

  
roger platt



**01628 773333**



[Maidenhead@rogerplatt.co.uk](mailto:Maidenhead@rogerplatt.co.uk)



25-29 Queen Street, MAIDENHEAD, Berkshire,  
SL6 1NB



[rogerplatt.co.uk](http://rogerplatt.co.uk)