



## Myers Lane, SE14

£275,000

Tucked away on a quiet residential cul-de-sac, this charming one-bedroom flat is ideally located to enjoy the best of the surrounding neighbourhoods, from fashionable Bermondsey to the green spaces and waterside appeal of Surrey Quays.

Ideally positioned, Verona Court offers easy access to Rotherhithe, Surrey Quays and fashionable Bermondsey, all home to an excellent selection of shops, cafés, restaurants and leisure amenities. Convenient transport links are available from nearby South Bermondsey and New Cross stations.

### Features

- Bright And Airy Flat
- 1 Bedroom Apartment
- Ample Storage
- Spacious reception room
- Sleek Kitchen
- Chain Free

# Myers Lane, London, SE14

## First Floor

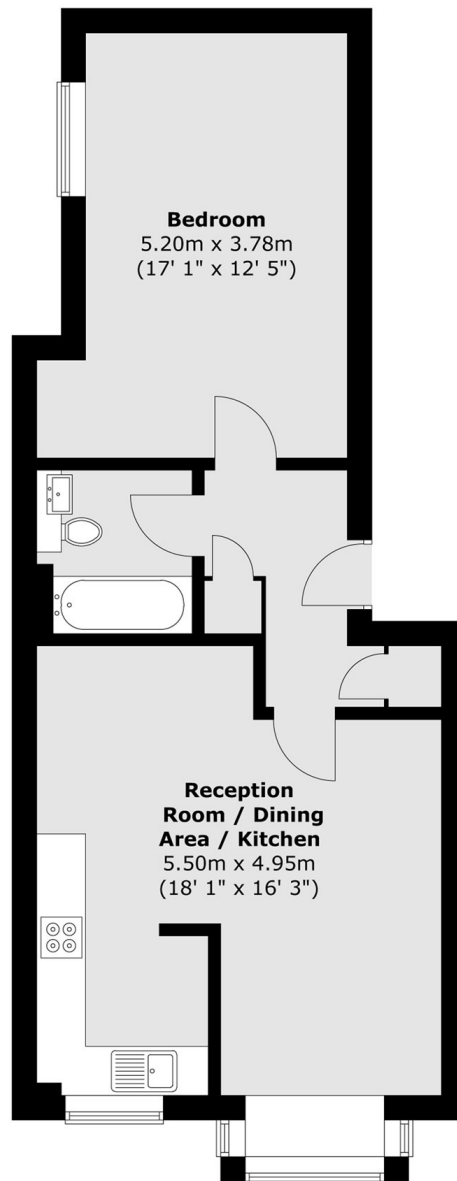

**Bedroom**  
5.20m x 3.78m  
(17' 1" x 12' 5")

**Reception  
Room / Dining  
Area / Kitchen**  
5.50m x 4.95m  
(18' 1" x 16' 3")

Total area (approx.) : 54.8 sq. m (590 sq. ft)