

Andrew Stevens

Estate & Letting Agents



22 Rowley Road, Tottenham, London, N15 3AX

£729,995

- Newly Renovated 4 Bedroom House
- Front and Rear Gardens
- New Fully Fitted Kitchen
- Close to Shops
- 2 Family Bathrooms

22 Rowley Road- N15 3AX

Approximate Gross Internal Area 98.0 m² ... 1054 ft² (excluding garden)

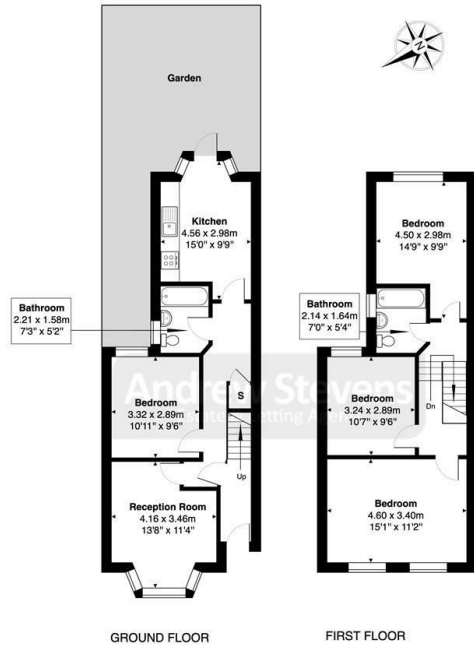

This Plan is for illustration purpose only and used as general indication of the proposed layout of the property. Dimensions are maximum and approximate and may vary.
Copyright One Square Space Ltd



Directions

Viewings

Viewings by arrangement only. Call 020 8363 8888 to make an appointment.

Council Tax Band

D

EPC Rating:

D

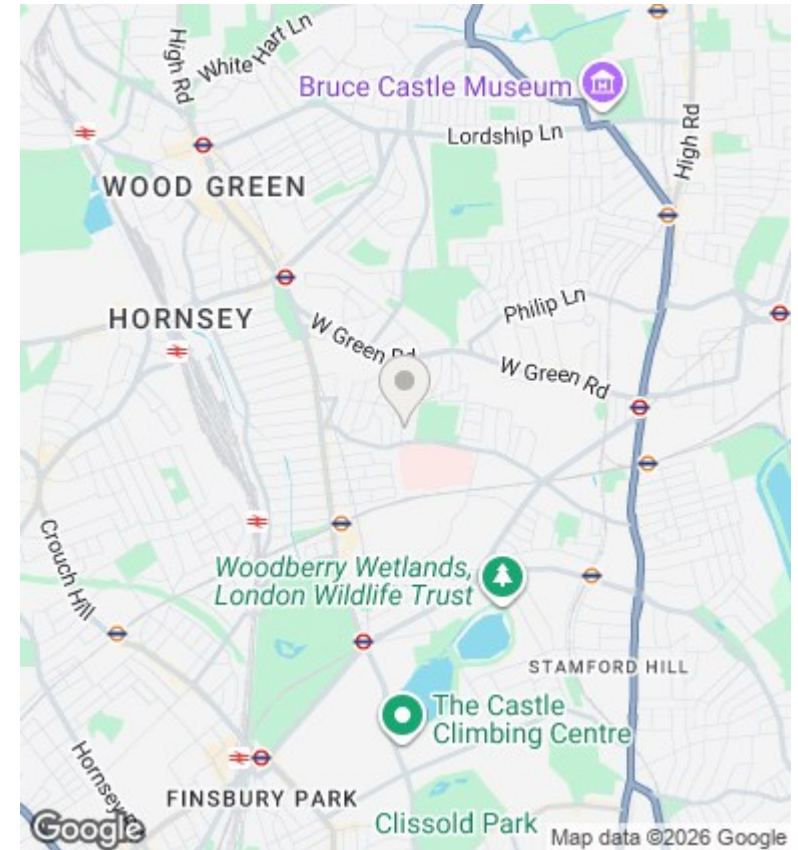

Energy Efficiency Rating

	Current	Potential
Very energy efficient - lower running costs		
(92 plus) A		
(81-91) B		87
(69-80) C		
(55-68) D	64	
(39-54) E		
(21-38) F		
(1-20) G		
Not energy efficient - higher running costs		
England & Wales	EU Directive 2002/91/EC	