

For Rent



People Make Places



Henrietta Street, Covent Garden WC2

1 bedroom | 581 sq ft

£895 pw





Finished to an exceptional standard, this stunning one bedroom flat is on the 4th floor of a period building just off Covent Garden's Piazza. The luxurious shower room features a marble sink while the kitchen is open-plan to the stylish reception room. Available furnished immediately.

What you need to know

- One bedroom
- One shower room
- Air cooling
- 4th floor, walk-up
- Off-site concierge service available
- Furnished
- Exceptional quality
- Superb location
- Available immediately
- Close to Leicester Square & Covent Garden station



Henrietta Street, Covent Garden WC2





Overview

Siemens appliances, Hans Grohe bathroom fittings and comfort cooling all feature in this ultra-modern one-bedroom apartment that forms part of the Covent Garden Estate. On the fourth floor, walk-up, of a handsome building in the heart of Covent Garden, roof lights in the reception room bathe the apartment with natural light, while the quiet bedroom allows for a comfortable sleeping environment. Ample storage is fitted throughout, and the overall finish is in keeping with Covent Garden Estate's quality and well-considered design, from finishes to furnishing, all backed up by a team of dedicated property managers, support staff and the estate security and facilities teams.

Residents benefit from a complimentary membership of Covent Garden Lifestyle Services, helping take the stress out of everyday life. The dedicated Covent Garden Lifestyle team are on hand to assist you with a vast array of both personal and work-related services. Whether it be access to tickets for sold-out events, restaurant bookings, event planning or services for your home. In addition, residents receive a digital lifestyle newsletter featuring all the latest news and updates on the Estate and further afield.

The apartment is available immediately on a furnished basis Westminster Council tax band: E.



Henrietta Street, Covent Garden WC2

People Make Places

London is a collection of inspiring urban villages and one of the most exciting places in the world to live, work & play.

We work with both property owners and their occupiers, sharing the story of these vibrant neighbourhoods, conveying the unique soul & energy to future custodians, the people who'll keep them buzzing.

And unlike many real estate businesses we're not just about buildings, because streets & buildings don't make a neighbourhood.

We're about building relationships, because **people make places**.

MISINTERPRETATION ACT (COPYRIGHT) DISCLAIMER: Tavistock Bow Ltd for themselves and for the vendor(s) of this property whose agents they are, given notice that: 1. These particulars do not constitute, not constitute any part of, an offer or contract. 2. None of the statements contained in these particulars as to the property are to be relied on as statements or representations of fact. 3. Any intending purchaser or lessee must satisfy themselves by inspection or otherwise as to the correctness of each of the statements contained in these particulars. 4. The vendor(s) or lessor(s) do not make or give and neither Tavistock Bow Ltd nor any person in their employment has any authority to make or give any representation or warranty whatever in relation to this property. Finance Act 1989, Unless otherwise stated all prices and rents are quote exclusive of VAT. Property Misrepresentation Act 1991; These details are believed to be correct at the time of compilation but may be subject to subsequent amendment.

Follow us:     @tavistockbow

Score	Energy rating	Current	Potential
92+	A		
81-91	B		
69-80	C		76 C
55-68	D		
39-54	E	50 E	
21-38	F		
1-20	G		

Henrietta Street, WC2

Approximate Gross Internal Area 54 sq m / 581 sq ft

Fourth Floor

 Under 1.5m head height

- 1 Kitchen / Dining / Reception Room
5.66 x 4.33M
18'7" x 14'2"
- 2 Bedroom
4.52 x 4.20M
14'10" x 13'9"

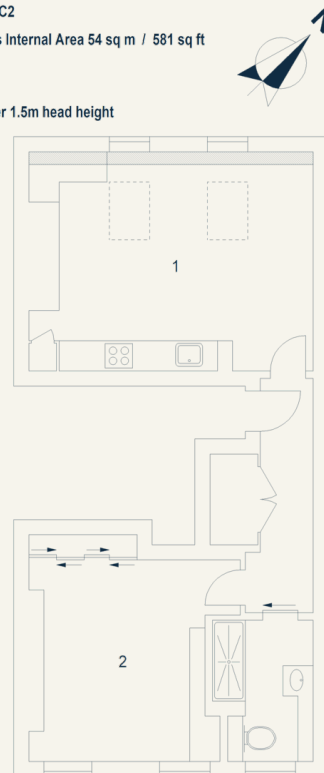

Floor Plan produced for Tavistock Bow by Mays Floorplans ©. Tel 020 3397 4584
Illustration for identification purposes only, not to scale.

tavistockbow

21 New Row, Covent Garden,
London, WC2N 4LE

t: 020 7477 2177
e: hello@tavistockbow.com
w: tavistockbow.com



Henrietta Street, Covent Garden WC2