

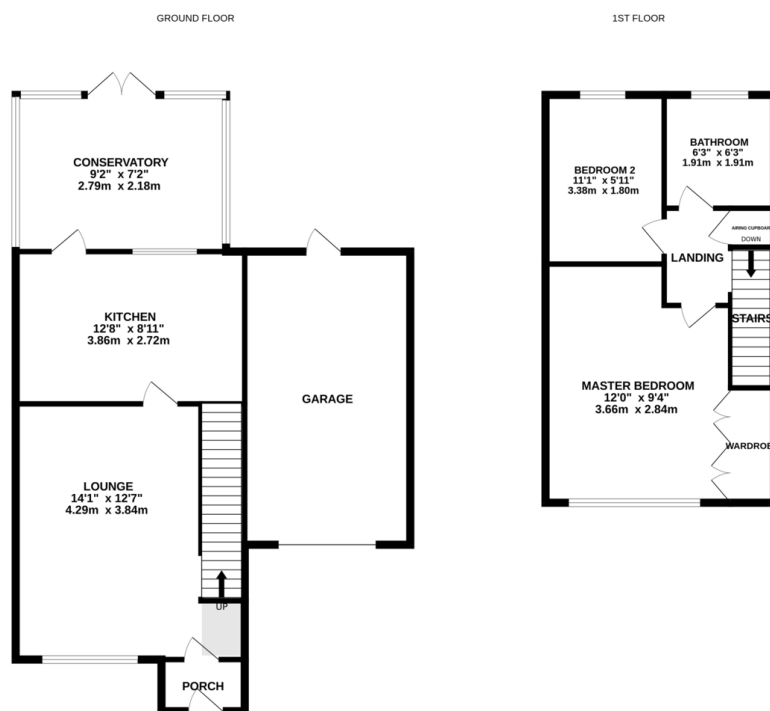

TO LET

2 Bed Semi-Detached House in Scalborough Close, Countesthorpe
£995 pcm

Well presented semi detached property for rent in Countesthorpe. The property is within walking distance of local amenities, bus routes and schools. The accommodation comprises porch, lounge, breakfast kitchen, conservatory, two bedrooms, bathroom, gardens to the front and rear, off road parking and garage.



Whilst every attempt has been made to ensure the accuracy of the floorplan contained here, measurements of doors, windows, rooms and any other items are approximate and no responsibility is taken for any error, omission or mis-statement. This plan is for illustrative purposes only and should be used as such by any prospective purchaser. The services, systems and appliances shown have not been tested and no guarantee as to their operation or efficiency can be given. Made with Metropix ©2025

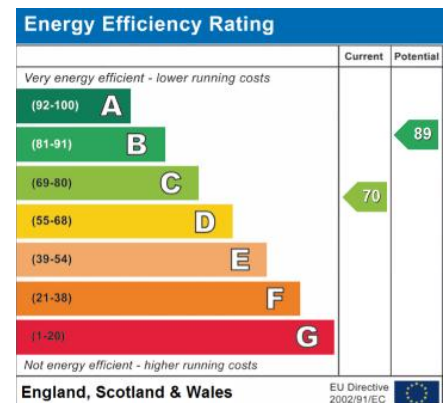

- Two Bedrooms
- Semi Detached
- Garage
- Conservatory
- Off Road Parking
- Corner Plot
- Popular Location
- Offered Unfurnished

Agents Note: Whilst every care has been taken to prepare these sales particulars, they are for guidance purposes only. All measurements are approximate are for general guidance purposes only and whilst every care has been taken to ensure their accuracy, they should not be relied upon and potential buyers are advised to recheck the measurements.

