



Guide Price
£195,000

Freehold

2x  1x  1x 

**Copperwood, Ashford,
Kent, TN24**

OVER 60?

Secure this property
for up to **59% less!**

Wards
Helping you move forwards



Main features

- Allocated parking space
- Located in a quiet cul-de-sac
- Perfect first time purchase investment opportunity
- Recently serviced boiler
- Within walking distance to the Ashford International train station and town centre

Accommodation

GROUND FLOOR

Entrance Hall

Kitchen : 12'8 x 7'8 (3.86m x 2.34m)

Lounge: 11'0 x 10'1 (3.36m x 3.08m)

FIRST FLOOR

Landing

Bedroom 1: 11'1 x 8'7 (3.38m x 2.62m)

Bedroom 2: 11'2 x 6'3 (3.41m x 1.91m)

Bathroom: 9'1 x 5'0 (2.77m x 1.53m)

OUTSIDE

Front and Rear Gardens

Allocated Parking

Ground Floor

Approx. 22.4 sq. metres (240.8 sq. feet)

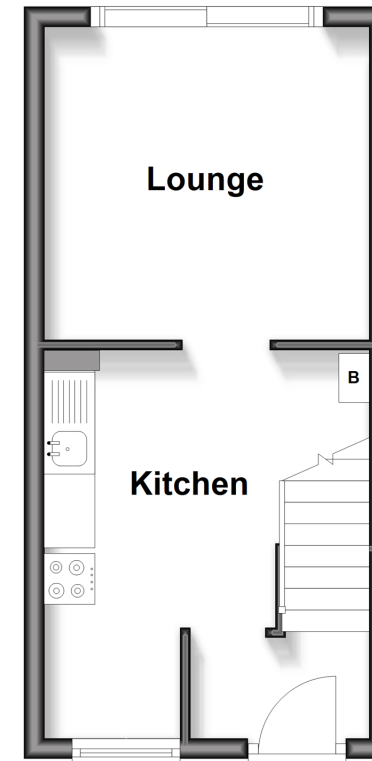

First Floor

Approx. 22.4 sq. metres (240.8 sq. feet)

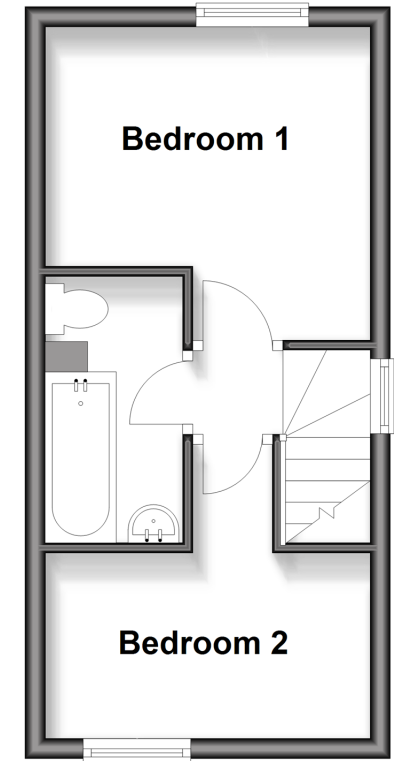

Call Ashford - 01233 639531 ■ wardsof Kent.co.uk

- Legal advice should be taken to verify fixtures/fittings, planning, alterations and/or lease details
- Appliances & services are untested, dimensions are approximate and floor plans are not to scale
- Through a Homewise Home For Life Plan people aged 60+ can secure this property for up to 50% less, by purchasing a Lifetime Lease.



12243378/20251008/RB/RB