



Berkeley Court, High Street, Cheltenham, GL52

£135,000

🛏️ 1 🚿 1 🚪 1



- Lounge/diner
- One bedroom apartment
- Modern bathroom
- Permit parking
- Close proximity to Cheltenham town centre
- Well-presented kitchen
- Large master bedroom
- Private outdoor space
- Walking distance to Sandford Park



A beautifully presented one bedroom apartment, ideally located just moments from Sandford Park and Cheltenham town centre.



Approximate Gross Internal Area 361 sq ft - 34 sq m

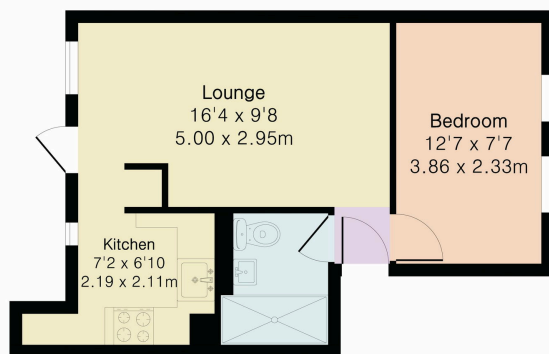

PINK PLAN

Floor plan produced in accordance with RICS Property Measurement 2nd Edition. Although Pink Plan Ltd ensures the highest level of accuracy, measurements of doors, windows and rooms are approximate and no responsibility is taken for error, omission or misstatement. These plans are for representation purposes only and no guarantee is given on the total square footage of the property within this plan. The figure form is for initial guidance only and should not be relied on as a basis of valuation.



Energy Efficiency Rating		Current	Potential
Very energy efficient - lower running costs			
(92 plus) A			
(81-91) B			
(69-80) C		75	77
(55-68) D			
(39-54) E			
(21-38) F			
(1-20) G			
Not energy efficient - higher running costs			
England & Wales		EU Directive 2002/91/EC	



Elliot Oliver Sales
 101 Promenade, Cheltenham GL50 1NW
 01242 321091
 www.eosales.co.uk

