



**Lavernock Point Holiday Estate, Fort Road, Lavernock,
Penarth, CF64 5XQ**

Welcome to

Lavernock Point Holiday Estate, Fort Road, Lavernock, Penarth

NO CHAIN A two bedroom chalet at Lavernock Point Holiday Park, offering spacious open-plan living room, a modern kitchen, bathroom and a large timber deck with sea views. Just a short walk from the coastal path and local beaches, it provides convenient access to Penarth, Cardiff and the Vale.

Open Plan Living Space

A generous open plan living space with plenty of space for lounging and dining, lit with a large double glazed bow window to front with views onto the deck. Open plan to the kitchen and doors leading to the two bedrooms and a bathroom. Wood panelling to dado height, feature fireplace and wood flooring.

Kitchen Area

Double glazed window to rear, contemporary range of floor and wall mounted kitchen units with work surfaces over, brick tiled splashbacks continuing to one wall, radiator, spaces for fridge/freezer, washing machine and cooker, spotlights.

Bathroom

Two double glazed windows to rear, tiled walls, WC, wash hand basin set into a vanity unit with storage cupboard under, panelled bath with shower screen and shower over, towel style radiator.

Bedroom 1

Double glazed window to rear, radiator.

Bedroom 2

Double glazed window to front and could be knocked through to bedroom 1 to create a larger double bedroom. Radiator.

Outside

To the front of the property is a large timber deck with spindle and balustrades, extending the full width of the property, from which you can enjoy the sea views. Large enough for dining and lounging this is a lovely and unusual feature for these properties. To the side of the property is a paved pathway leading to the back of the property, whilst to the side there is a useful paved area that could be used as a further seating area, or as storage area for beach/holiday equipment.

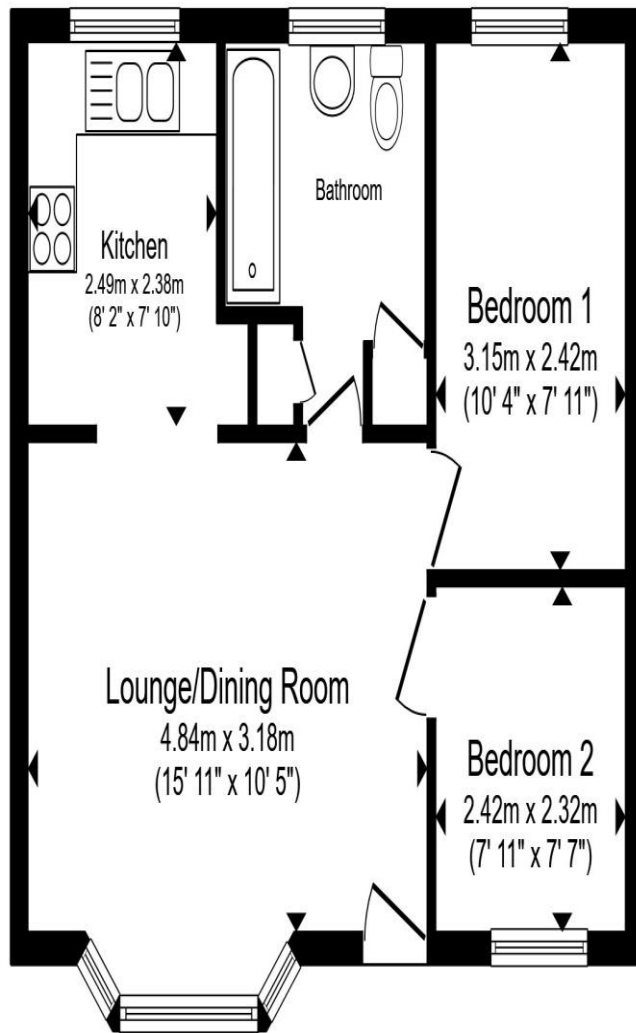

Total floor area 43.4 m² (467 sq.ft.) approx

This floor plan is for illustrative purposes only. It is not drawn to scale. Any measurements, floor areas (including any total floor area), openings and orientation are approximate. No details are guaranteed, they cannot be relied upon for any purpose and they do not form part of any agreement. No liability is taken for any error, omission or misstatement. A party must rely upon its own inspection(s). Powered by www.propertybox.io



Welcome to

Lavernock Point Holiday Estate, Fort Road, Lavernock, Penarth

- Two bedroom chalet in the peaceful setting of Lavernock Park Holiday Estate, boasting one of the best sites on the development.
- Distant sea views from the large timber deck at the front of the property which extends the full width of the property. Open-plan living and kitchen area
- Spacious open-plan living and dining area, open plan to a kitchen area replete with a contemporary kitchen.
- Access to on-site swimming pool and clubhouse, walking distance to coast and countryside trails
- An ideal second home for family holidays or as a buy-to-let investment

Tenure: EPC Rating: Exempt

directions to this property:

From the office on Stanwell Road (CF64 2AA), proceed to the lights and continue over into Stanwell Road. Take the first left onto Victoria Road and then take the third left onto Westbourne Road and proceed to the end of the road. At the T-junction turn left onto Lavernock Road and proceed for approximately 1 mile and then take a left turn onto Fort Road. Continue along Fort Road for approximately half a mile and the Marconi Holiday Village can be found on the right hand side. As you enter the development take the left past the 'concierge' and then take the first left, proceed down the hill and the property can be found on the left hand side.

view this property online allenandharris.co.uk/Property/PNR106965



Property Ref:
PNR106965 - 0002

1. MONEY LAUNDERING REGULATIONS Intending purchasers will be asked to produce identification documentation at a later stage and we would ask for your co-operation in order that there is no delay in agreeing the sale. 2. These particulars do not constitute part or all of an offer or contract. 3. The measurements indicated are supplied for guidance only and as such must be considered incorrect. Potential buyers are advised to recheck measurements before committing to any expense. 4. We have not tested any apparatus, equipment, fixtures or services and it is in the buyers interest to check the working condition of any appliances. 5. Where an EPC, or a Home Report (Scotland only) is held for this property, it is available for inspection at the branch by appointment. If you require a printed version of a Home Report, you will need to pay a reasonable production charge reflecting printing and other costs. 6. We are not able to offer an opinion either written or verbal on the content of these reports and this must be obtained from your legal representative. 7. Whilst we take care in preparing these reports, a buyer should ensure that his/her legal representative confirms as soon as possible all matters relating to title including the extent and boundaries of the property and other important matters before exchange of contracts.

Allen & Harris is a trading name of Sequence (UK) Limited which is registered in England and Wales under company number 4268443, Registered Office is Cumbria House, 16-20 Hockliffe Street, Leighton Buzzard, Bedfordshire, LU7 1GN. VAT Registration Number is 500 2481 05.

allen & harris



029 2070 5528



penarth@allenandharris.co.uk



6 Andrews Buildings, Stanwell Road, PENARTH,
Wales, CF64 2AA



allenandharris.co.uk