



12 Plymouth Street, Portsmouth, PO5 4HW

£1,200 Per Calendar Month Council Tax Band B Deposit £1,384



1 2

Tully's

Floor Plan

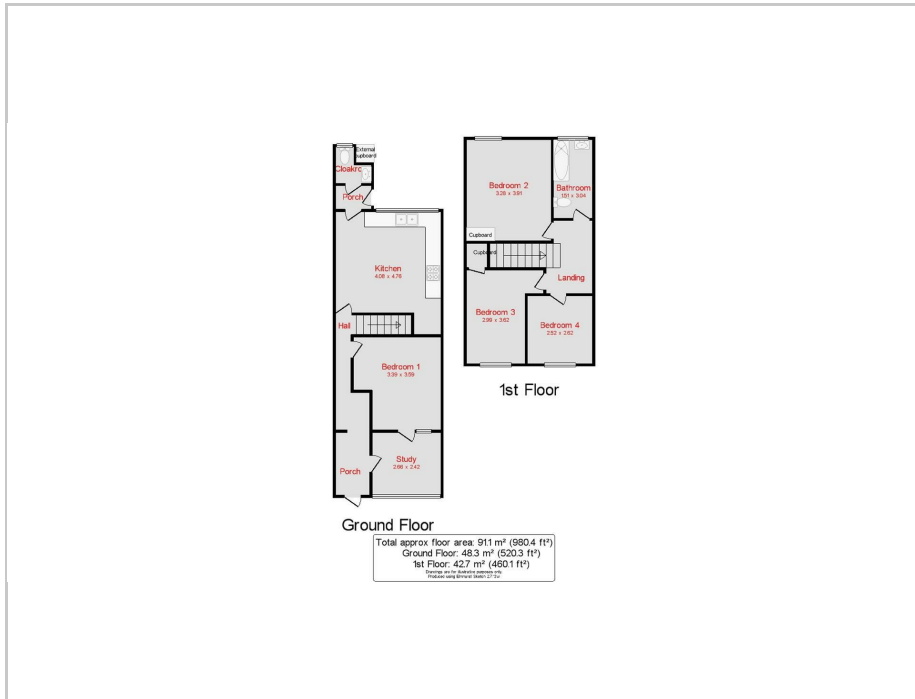

Area Map

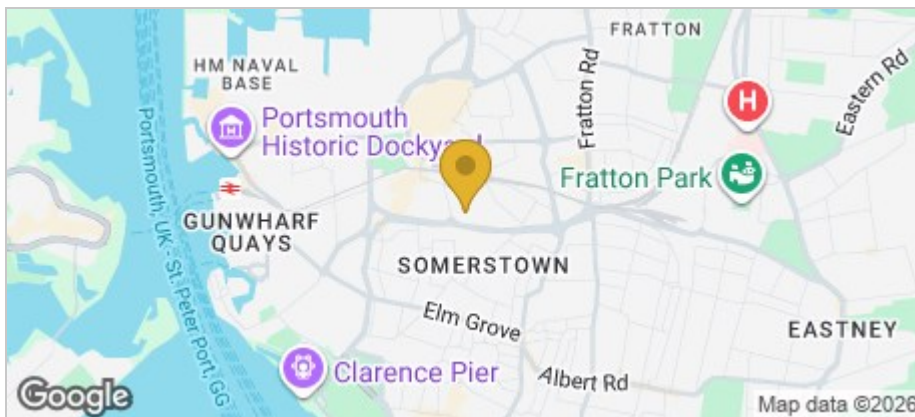

Accommodation

- Holding deposit - £276.00
- Deposit - £1384.00
- Available now
- Council Tax Band - B
- 3 Bedrooms
- 1 Reception
- large kitchen diner
- Gas Central Heating
- Double Glazing

Viewing

Please contact our Southsea Office on 023 9273 2241 if you wish to arrange a viewing appointment for this property or require further information.

Energy Efficiency Graph

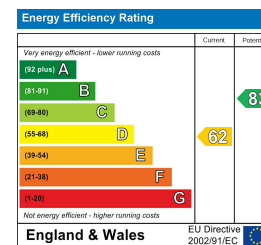

157-159 Albert Road, Southsea, Portsmouth, Hampshire, PO4 0JW
023 9273 2241 Email: tully@tullyand.co lettings@tullyand.co

Tully's