



10 Gill Avenue

Shevington, Wigan, WN6 8BB

Price £200,000



Sapphire Homes are delighted to offer For Sale for sale this 3 bedroom semi detached bungalow in a quiet cul de sac in the much sought after location of Shevington and is a few minutes walk to the heart of the Village. The property is also close to excellent transport links including bus routes, the M6 motorway as well as both Gathurst and Appley Bridge train stations. The accommodation in brief comprises of entrance / hallway, lounge with patio doors leading to the rear garden and separate fitted kitchen with door also leading to the rear garden. The hallway also provides access to three well appointed bedrooms and there is a family bathroom with three piece shower suite. The property is warmed by Gas Central Heating and also benefits from double glazing and whilst some modernisation is required, it offers lots of potential to a purchaser to make the property a home. Externally the property has a driveway with off road parking and a low maintenance front garden with brick perimeter wall. To the rear there is a low maintenance garden with patio area, shed, well stocked borders and perimeter fencing. The property is perfect for retirement or someone looking to downsize or needing ground floor living and early viewing is encouraged to appreciate in full. Offered to market with No Upward Chain.



GROUND FLOOR

Entrance / Hallway

Lounge

Kitchen / Diner

Bedroom 1

Bedroom 2

Bedroom 3

Bathroom

EXTERNAL

Rear Garden

Area Map

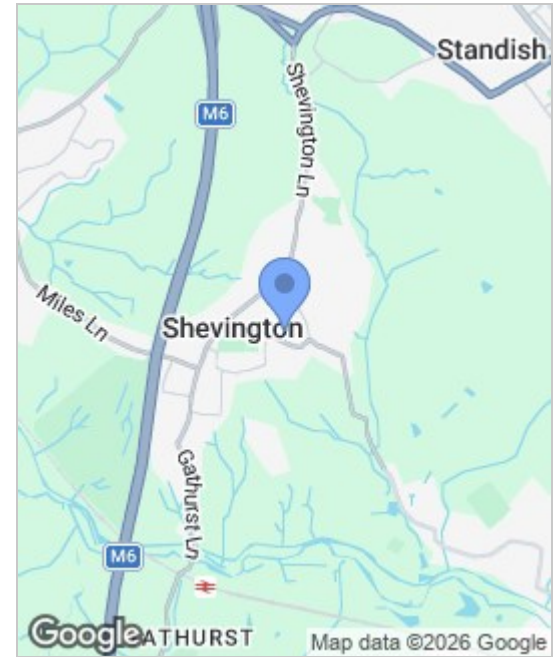

Floor Plans

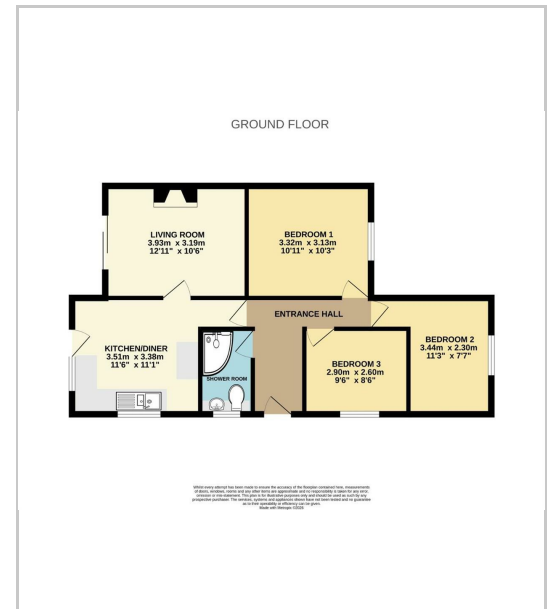

Energy Efficiency Graph

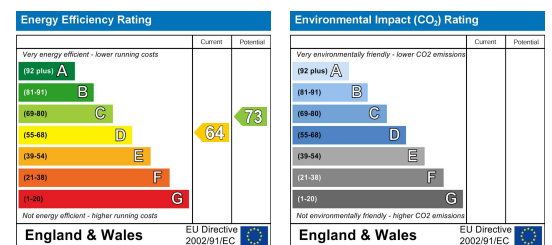

These particulars, whilst believed to be accurate are set out as a general outline only for guidance and do not constitute any part of an offer or contract. Intending purchasers should not rely on the representation of fact, but must satisfy themselves by inspection or otherwise as to their accuracy. No person in this firm's employment has the authority to make or give any representation or warranty in relation to the property.

