



## Castle Street, Stalybridge, SK15 1AP

**Price £135,000**

Nestled in the heart of Stalybridge on the desirable Castle Street, this modern fifth-floor apartment offers a perfect blend of comfort and convenience. Built in 2012, the property boasts contemporary design and is ideal for first-time buyers or as a lucrative rental investment.

Upon entering, you will find a well-appointed reception room that provides a welcoming space for relaxation and entertaining. The apartment features one spacious bedroom, ensuring a peaceful retreat at the end of the day. The bathroom is thoughtfully designed, catering to all your needs with modern fixtures and fittings.

One of the standout features of this property is the lift access, making it easily accessible for all. Additionally, residents will benefit from an allocated parking space in the secure underground car park, which is accessible via a coded entry system, providing both convenience and peace of mind.

With no chain involved, this apartment is ready for you to move in and make it your own. Its prime location offers easy access to local amenities, transport links, and the vibrant community of Stalybridge. Whether you are looking to invest or seeking your first home, this property presents an excellent opportunity not to be missed.

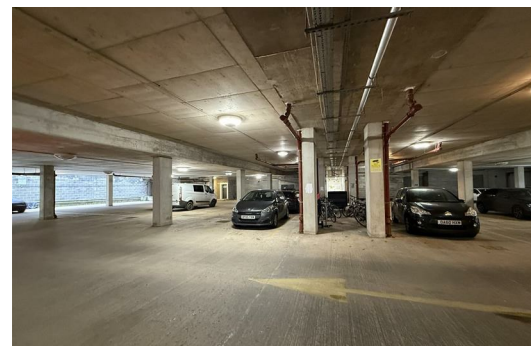

### Entrance Hall

10'2" x 5'10" (3.10m x 1.78m)

Open plan with doors leading to bathroom , living room , bedroom

### Living room/kitchen

20'1" x 11'6" (6.12m x 3.51m)

Open plan with balcony doors leading to balcony

### Bedroom

8'8" x 10'4" (2.64m x 3.15m)

Door leading to balcony

### Bathroom

7'1" x 6'8" (2.16m x 2.03m )

3 piece suite with bath and over head shower

### DISCLAIMER

Home Estate Agents believe all the particulars given to be accurate. They have not tested or inspected any equipment, apparatus, fixtures or fittings and cannot, therefore, offer any proof or confirmation as to their condition or fitness for purpose thereof. The purchaser is advised to obtain the necessary verification from the solicitor or the surveyor. All measurements given are approximate and for guide purposes only and should not be relied upon as accurate for the purpose of buying fixtures, floor-coverings, etc. The buyer should satisfy him/her self of all measurements prior to purchase.

[WWW.HOMEAA.CO.UK](http://WWW.HOMEAA.CO.UK)

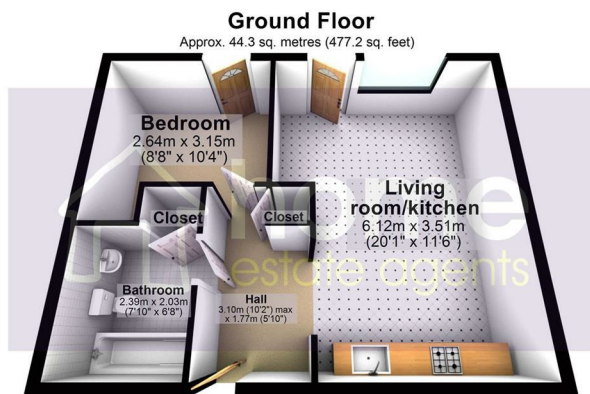

Total area: approx. 44.3 sq. metres (477.2 sq. feet)

