

**Need a Mortgage in principle to make offers?** Call us now for quick assistance!  
**0121 775 0101**



**Do you need to sell? Start your journey now!** Call us we can help.  
**0121 775 0101**



**SCAN FOR MORE INFO**  
**SIZE** - 1102 Sq Ft  
**TENURE** - Freehold  
**COUNCIL TAX** - Solihull Metropolitan Borough Council - E  
**BROADBAND** - Upload Max 1000Mbps Download Max 1800Mbps  
**MOBILE SERVICES** -EE - 85%, 3 - 85%, 02 - 81%, Vodafone - 80%  
**EPC** - D - 67  
**PARKING** - For at least 2 Cars & Garage  
**FLOODRISK** - Very Low  
**SERVICES** - Mains  
**COVENANTS** - N/A

## Winthorpe Drive

**Solihull, B91**  
**Offers in the Region of £485,000**

Situated on the popular Winthorpe Drive in Hillfield, this stylish three-bedroom detached home offers broad appeal for growing families seeking extra space and downsizers looking to remain in a well-connected and highly desirable area.

Perfectly positioned close to Solihull town centre, excellent local amenities and sought-after schools including Tudor Grange Academy, the location offers something for everyone.

Boasting generous living accommodation, a bright conservatory, three well-proportioned bedrooms and a private rear garden, this is a home designed for comfortable modern living in one of Solihull's most popular residential settings.

### FEATURES

- Modern Three Bedroom Detached Family Home
- No Upward Chain
- Sought-after Location In Hillfield
- Within Tudor Grange Academy Catchment
- Living Room & Conservatory
- Kitchen & Dining Area
- Conservatory Overlooking The Garden
- Principal Bedroom With En-suite
- Private Rear Garden
- Driveway Parking & Garage

**Are you an investor interested in expanding your portfolio?**

**Call 0121 775 0101 to provide your investment criteria for alerts.**

### Sneak Peeks

Every week, we unveil "Sneak Peeks," a feature showcasing exclusive properties before they hit Rightmove and other platforms.

### The Landlord Club

Join our Landlord Club for weekly updates on legislation, market trends, and our Letting Director's 'Investment Pick of the Week' for optimal ROI.

### HTSPMD

Tune into 'How's The Solihull Property Market Dom' weekly for a quick, insightful snapshot of the market.

### The Mortgage Update

Get weekly insights and the best deals with our Mortgage Update, your shortcut to navigating the complex mortgage landscape confidently.



**SCAN TO VIEW OUR WEEKLY FILMS & SUBSCRIBE**

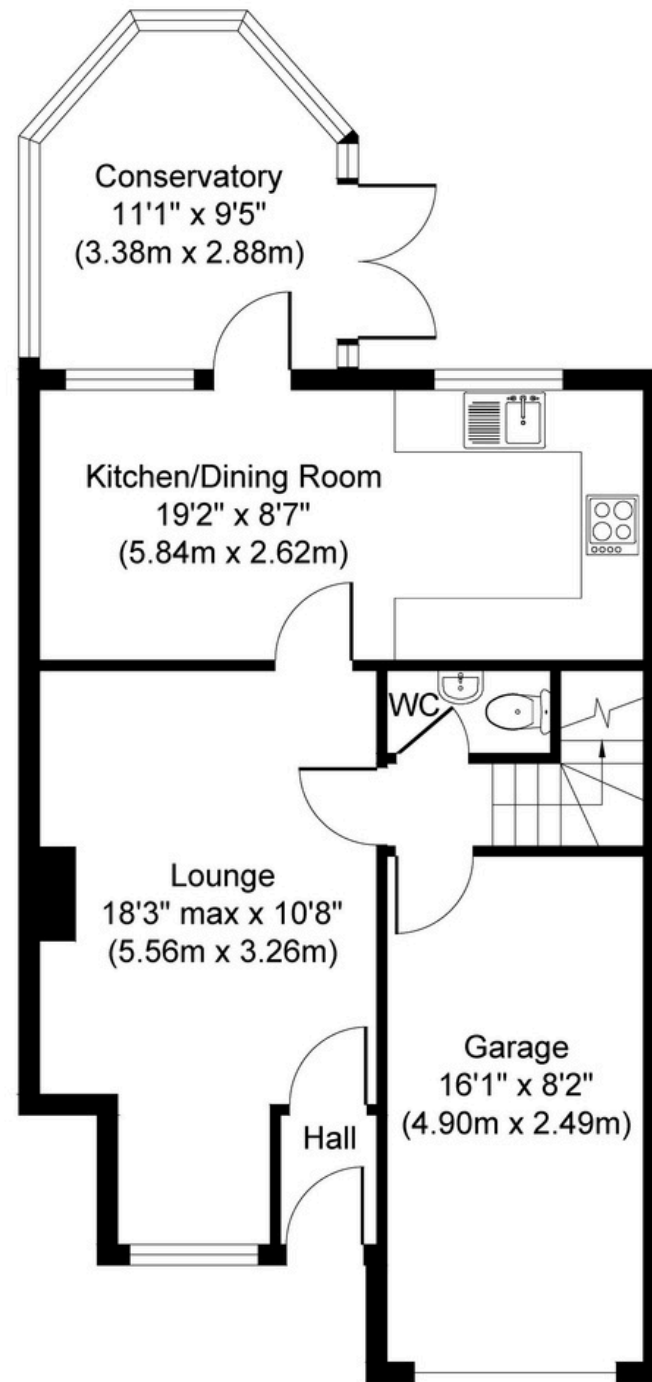

**Ground Floor**  
**Approximate Floor Area**  
**636 sq. ft**  
**(59.05 sq. m)**

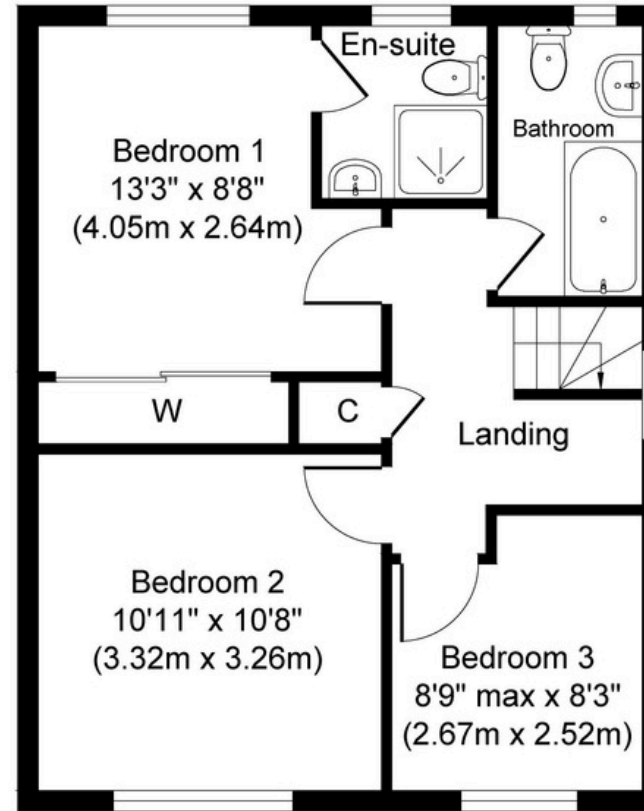

**First Floor**  
**Approximate Floor Area**  
**466 sq. ft**  
**(43.27 sq. m)**

Whilst every attempt has been made to ensure the accuracy of the floor plan contained here, measurements of doors, windows, rooms and any other items are approximate and no responsibility is taken for any error, omission, or mis-statement. The measurements should not be relied upon for valuation, transaction and/or funding purposes. This plan is for illustrative purposes only and should be used as such by any prospective purchaser or tenant.

The services, systems and appliances shown have not been tested and no guarantee as to their operability or efficiency can be given.