



Coppetts Road, N10

£375,000

Situated on the ground floor, is this generous sized two bedroom flat that offers an open plan kitchen/reception room and its own allocated parking space. This flat is located in a quite secluded development and has double glazing throughout.

Gilson Place is situated within easy reach of the shops and amenities in Muswell Hill with excellent green spaces including Alexandra Park close by. The development is also within the catchment areas for outstanding schools, perfect for family living.

Features

- Two Double Bedrooms
- Allocated Parking
- Ground Floor
- Modern Bathroom
- Gated Development
- Leasehold

Coppetts Road,
London, N10

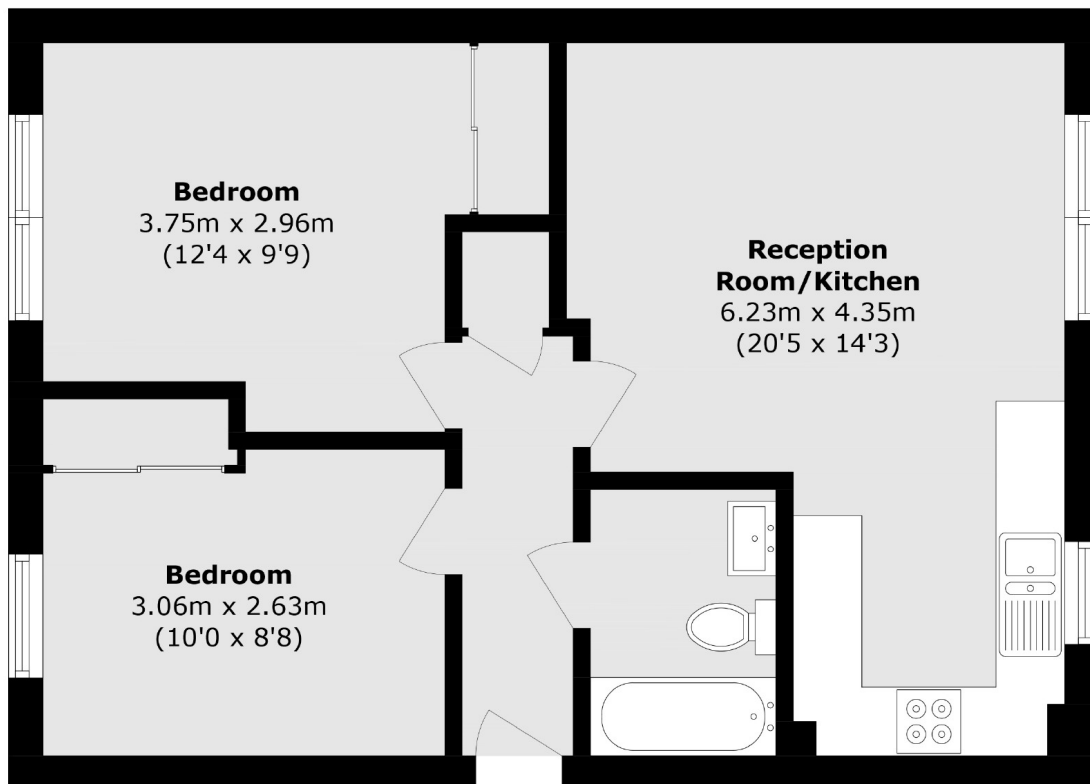

Total area (approx.): 55.5 sq.m (597.4 sq.ft)