



**Palmer Avenue, Aylesbury HP19 8EF**



**welcome to**

## **Palmer Avenue, Aylesbury**

Brown & Merry are delighted to present this three-bedroom family home, tucked away in a peaceful cul-de-sac just moments from the town centre (0.5 mile) and railway station (0.9 mile). This well-appointed property offers a warm and welcoming feel throughout, featuring double glazing, a gas central heating system with radiators, and a practical layout including an entrance hall, spacious living room, and a modern kitchen. Upstairs, you'll find three comfortable bedrooms, a family bathroom, and a separate WC. Outside, enjoy a private rear garden ideal for relaxing or entertaining, along with a driveway providing convenient off-road parking.



**Entrance Hall**

**Living Room**

**Kitchen**

**First Floor & Landing**

**Master Bedroom**

**Bedroom Two**

**Bedroom Three**

**Bathroom**

**Separate Wc**

**Outside**

**Rear Garden**

**Driveway**

Agents Note:  
Please note the property is currently tenanted.

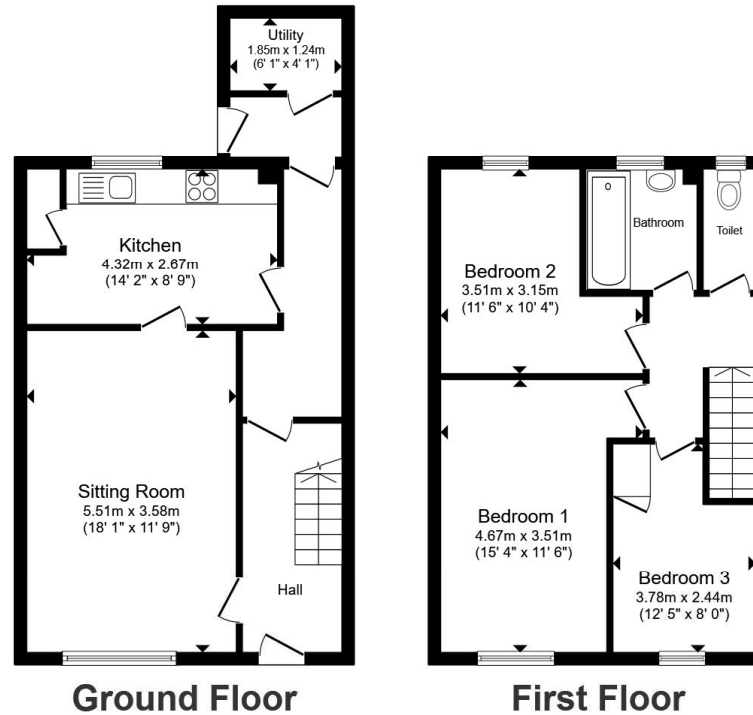

Total floor area 94.1 m<sup>2</sup> (1,012 sq.ft.) approx

This floor plan is for illustrative purposes only. It is not drawn to scale. Any measurements, floor areas (including any total floor area), openings and orientation are approximate. No details are guaranteed, they cannot be relied upon for any purpose and they do not form part of any agreement. No liability is taken for any error, omission or misstatement. A party must rely upon its own inspection(s). Powered by [www.propertybox.io](http://www.propertybox.io)

  
brown  
& merry



**view this property online** [brownandmerry.co.uk/Property/AYL116089](http://brownandmerry.co.uk/Property/AYL116089)



welcome to

## Palmer Avenue, Aylesbury

- CLOSE TO TOWN CENTRE
- CLOSE TO RAILWAY STATION
- THREE BEDROOMS
- DRIVEWAY PARKING
- NO UPPER CHAIN

Tenure: Freehold EPC Rating: C Council Tax Band: C

**£325,000**



Please note the marker reflects the  
postcode not the actual property

**view this property online** [brownandmerry.co.uk/Property/AYL116089](https://www.brownandmerry.co.uk/Property/AYL116089)



Property Ref:  
AYL116089 - 0003

1. MONEY LAUNDERING REGULATIONS Intending purchasers will be asked to produce identification documentation at a later stage and we would ask for your co-operation in order that there is no delay in agreeing the sale. 2. These particulars do not constitute part or all of an offer or contract. 3. The measurements indicated are supplied for guidance only and as such must be considered incorrect. Potential buyers are advised to recheck measurements before committing to any expense. 4. We have not tested any apparatus, equipment, fixtures or services and it is in the buyers interest to check the working condition of any appliances. 5. Where an EPC, or a Home Report (Scotland only) is held for this property, it is available for inspection at the branch by appointment. If you require a printed version of a Home Report, you will need to pay a reasonable production charge reflecting printing and other costs. 6. We are not able to offer an opinion either written or verbal on the content of these reports and this must be obtained from your legal representative. 7. Whilst we take care in preparing these reports, a buyer should ensure that his/her legal representative confirms as soon as possible all matters relating to title including the extent and boundaries of the property and other important matters before exchange of contracts.

Brown & Merry is a trading name of Sequence (UK) Limited which is registered in England and Wales under company number 4268443, Registered Office is Cumbria House, 16-20 Hockliffe Street, Leighton Buzzard, Bedfordshire, LU7 1GN. VAT Registration Number is 500 2481 05.

  
brown & merry



**01296 488111**



[Aylesbury@brownandmerry.co.uk](mailto:Aylesbury@brownandmerry.co.uk)



5-7 Market Street, AYLESBURY,  
Buckinghamshire, HP20 2PN



**[brownandmerry.co.uk](https://www.brownandmerry.co.uk)**