



Horseshoe Close

Bourne End



Offers In Excess Of £600,000

entrance hall | WC | living room | kitchen/dining room | three first floor bedrooms | family bathroom | second floor bedroom with ensuite | rear garden | driveway parking

Occupying a desirable position within the sought-after hamlet of Bourne End, this beautifully presented four-bedroom semi-detached family home offers an exceptional blend of contemporary comfort, practical living space and a highly convenient location between Berkhamsted and Hemel Hempstead.





Extending to approximately 1,245 sq ft, the property has been thoughtfully designed to suit modern family life, with well-balanced accommodation arranged across three floors. The welcoming ground floor features underfloor heating throughout and includes a comfortable living room, a convenient WC, and a stylish fitted kitchen/dining room complete with integrated appliances, creating an ideal space for both everyday living and entertaining.

The first floor provides three well proportioned bedrooms served by a contemporary family bathroom, while the principal bedroom occupies the entire second floor, offering a private retreat with its own en-suite shower room.

Outside

The property benefits from driveway parking for two cars and a well-maintained rear garden, offering a pleasant space for relaxation, outdoor dining and children's play. The home enjoys a peaceful setting within this highly regarded residential location.

Tenure

Freehold.

Services

Gas fired boiler serving domestic hot water and heating.
Mains water, electricity and drainage.

Council tax band E (Dacorum).

Service Charge of £250 per year to cover Estate maintenance.

Situation



Horseshoe Close is located in the charming and picturesque village of Bourne End one of the area's most desirable locations, within easy reach of the towns of Berkhamsted and Hemel Hempstead, both of which offer excellent shopping, sporting and educational facilities. For commuters, the A41 bypass offers good connections to both the M1 and M25 and the mainline stations at Hemel Hempstead and Berkhamsted provide fast and frequent services to London (Euston).



Horseshoe Close

Bourne End

Approximate Gross Internal Area
 Ground Floor = 45.0 sq m / 484 sq ft
 First Floor = 44.6 sq m / 480 sq ft
 Second Floor = 26.1 sq m / 281 sq ft
 Total = 115.7 sq m / 1,245 sq ft



Ground Floor

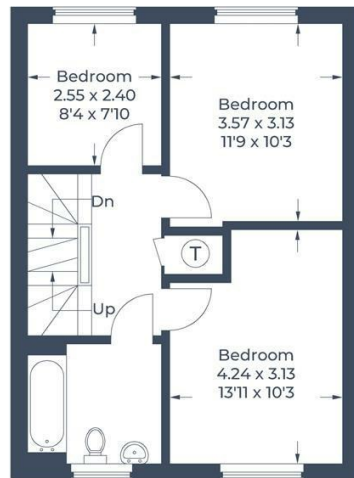

First Floor



Second Floor

Illustration for identification purposes only, measurements are approximate, not to scale.
 © CJ Property Marketing



Energy Efficiency Rating		Current	Potential
Very energy efficient - lower running costs			
(92 plus) A			95
(81-91) B		85	
(69-80) C			
(55-68) D			
(39-54) E			
(21-38) F			
(1-20) G			
Not energy efficient - higher running costs			
England & Wales		EU Directive 2002/91/EC	



These particulars are produced in good faith, are set out as a general guide only and do not constitute any part of a contract. None of the statements are to be relied on as a statement of fact. Areas, measurements or distances are given as a guide only. We have not tested any of the equipment, appliances or services to this property nor do we have knowledge of any defects.

Relax... you're with Oakleys

151 High Street Berkhamsted Hertfordshire HP4 3HH 01442 386555 www.oakleystate.co.uk

