

Talbot Square, W2

£750,000

A modern and stylishly refurbished raised ground floor apartment in a white stucco fronted conversion on a garden square. With two double bedrooms, two bathrooms (one en suite) and an open plan reception and high specification kitchen. There's wooden floors, high ceilings and luxury fittings throughout.

Talbot Square is a garden square in the heart of Paddington, within short walking distance of Paddington Station (giving access across and out of London and to Heathrow). The green spaces of Hyde Park are close by, as are a choice of local shops and restaurants.

Features

- Two Double Bedrooms
- Two Bathrooms
- Open Plan
- High Ceilings
- High Specification
- Hyde Park

Talbot Square, London, W2

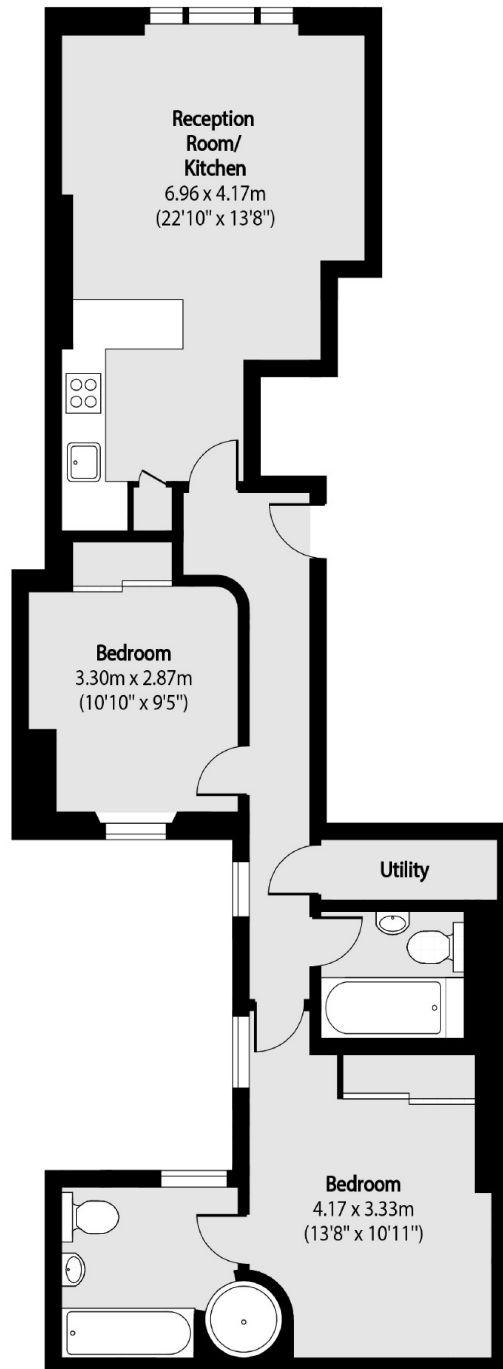

Total area (approx): 69.39 sq m (747 sq. ft)