



## Streatham High Road, SW16

£375,000

A one double bedroom property filled with natural light is a perfect first time purchase. The open-plan living accommodation has a modern fitted kitchen and space for both lounging and dining. The large bedroom has a fitted wardrobe, whilst the handy utility cupboard in the hallway creates extra storage. The development benefits from a communal resident's courtyard which can be accessed via the private patio as well as a 24/7 concierge and security. There is also a private parking space that comes with the property.

Derry Court is within walking distance to Streatham Station, providing direct access into the City via Thameslink. Streatham Common Station is also nearby and provides access to London Bridge and Victoria via Southern Railway. There are many local amenities including supermarkets, gym and leisure centre as well as the open space of Streatham Common. Streatham High Road benefits from a wide variety of restaurants and shops.

### Features

- Private Terrace
- Communal Courtyard
- Open-Plan Living
- Modern Development
- Close to Station
- Car Parking Space

# Streatham High Road, London, SW16

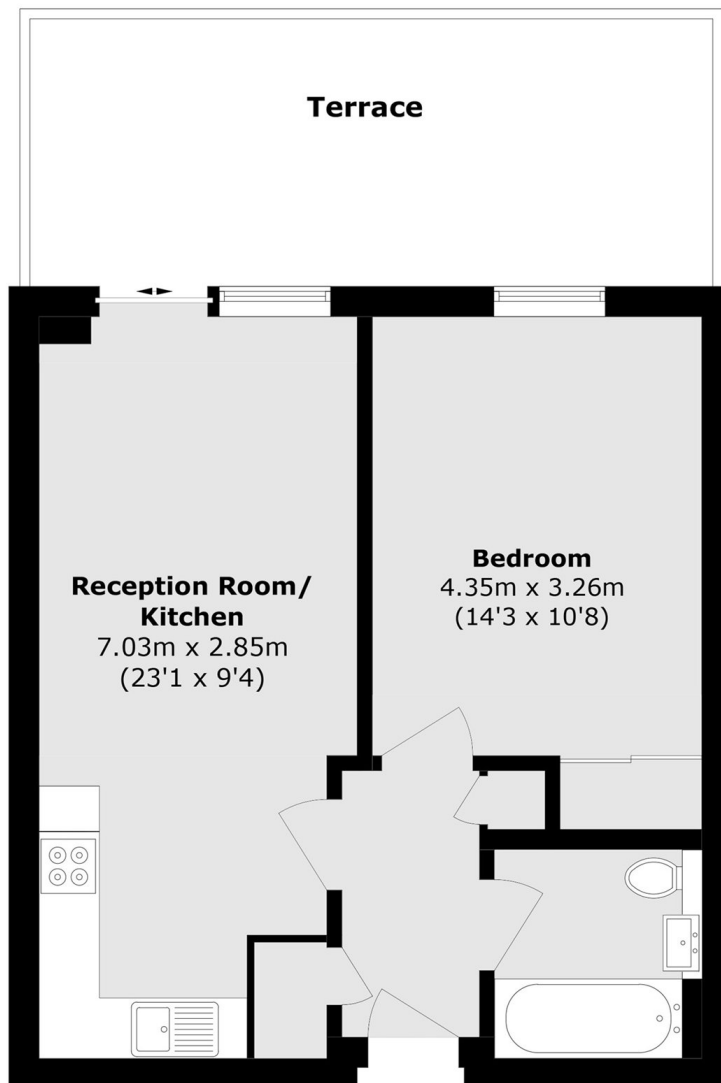

Total area (approx.): 47.7 sq. m (513.4 sq. ft)  
Terrace area (approx.): 17.9 sq. m (192.6 sq. ft)