



22 Haltwhistle Road, South Woodham Ferrers, Essex CM3 5ZF £800 Per month

This first floor flat is a modern and cosy one bedroom property. This property has everything you need: a stylish kitchen, a good size living room and a shower room. The flat comes with a designated parking spot and a visitor space. You can easily access South Woodham Ferrers Train Station and enjoy the scenic walks around the Nature Reserve. Church & Hawes are proud to present this wonderful opportunity to you. Council Tax Band: A - EPC Rating: TBC



Accommodation

Lounge: 11'8" x 15'7">10'4"

Kitchen: 7'1" x 5'11"

Three pc Shower Room

Bedroom: 12'11" x 7'5"

Allocated Parking

TENANTS LETTING INFORMATION

You will be required to complete a PRE-LET APPLICATION and once this has been supplied we will contact you to arrange a viewing if required, usually by agreement with the owner or present tenant.

A credit reference agency will carry out relevant checks, this will include details of your bank, employment, (accountant, if you are self employed), they will also carry out a credit check THIS WILL BE CARRIED OUT ONLINE.

So as to satisfy the RIGHT TO RENT and ANTI-MONEY LAUNDERING REGULATIONS (AML) and FINANCIAL SANCTIONS, please supply your UK/EU PASSPORT, NON EU PASSPORT and RIGHT TO STAY VISA IF NON EU PASSPORT, DRIVING LICENCE and also a UTILITY BILL (not more than three months old) showing your current address.

Before the application can begin we will need the above along with the PRE LET QUESTIONNAIRE, PET /ALTERATIONS/WORKS request forms, returned fully completed and signed, without these we are unable to proceed with your proposed rental. COMPANY LETS ARE CHARGED AT £250 PER REFERENCE and a £160 CHARGE FOR THE PREPARATION OF THE TENANCY AGREEMENT. Your application will then be processed by a Reference Agency.

Church & Hawes require a holding deposit of one weeks rent in order to proceed with the application. In the event of the parties proceeding with the tenancy, the holding deposit will form part of the move in monies payable by you before you move in. Unless informed otherwise, it will be taken against the Rent payable. This will be requested via our Platform partner Goodlord.

One weeks holding deposit is the rent multiplied by 12 months and then divided by 52. For example (Rent of £1,000 pcm x 12 = £12,000 divided by 52 = £230.77 holding deposit.

If the tenancy does not proceed due to no fault of your own (IE landlord deciding not to rent the property, the holding deposit will be returned) If the tenancy does not proceed due to your own circumstances including reference refusal, then the holding deposit will not be returnable.

A security deposit, equal to 5 weeks of the total rent for the property, which is held during the tenancy as security for the rent and property condition by Church and Hawes as stakeholder for security breaches of the tenancy agreement, therein, Church and Hawes are members of the tenancy deposit scheme. N.B. Both the deposit together with the first month's rent, in advance are payable upon signing the Tenancy Agreement and must be cleared funds made by Electronic transfer (please ask for our bank details). You cannot collect the keys until monies are received.

CASH IS NOT ACCEPTABLE. PLEASE DO NOT SEND FUNDS UNLESS REQUESTED TO DO SO.

Reference Checks are not carried out within the office. Please complete the relative forms and return them to this office. Our Lettings Management office can be contacted at 4 High Street, Maldon, CM9 5PJ. 01621 878417 or lettings@churchandhawes.com.

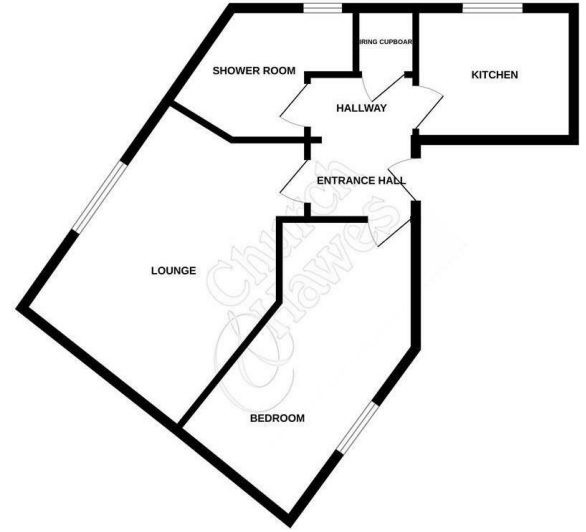

Whilst every attempt has been made to ensure the accuracy of the floorplan contained here, measurements of plans, windows, doors and any other items are approximate and no responsibility is taken for any error, omission or mis-statement. This plan is for illustrative purposes only and should be used as such by any prospective purchaser. The services, fixtures and appliances shown here have been tested and are guaranteed to be in working order at the time of completion of the sale.
Map data ©2026 Google

