



Spinney Gardens, SE19 | Offers Over £625,000

020 8702 9333

crystalpalace@pedderproperty.com

pedder
We live local



In General

- Two bedroom house
- Neatly planted garden
- Modern kitchen
- Double-height winter garden
- Leafy woodland development
- Highly convenient location
- Freehold
- Bathroom with walk-in shower

In Detail

A fresh and vibrant two double bedroom Freehold house forming part of a leafy woodland development close to central Crystal Palace.

Tucked away in green surroundings, this small community-orientated enclave is a sanctuary for those who appreciate quiet calmness, yet still have ease of access to transport links and a variety of amenities close by.

The accommodation has been partially remodelled and completely upgraded to offer an immediately enjoyable space. The entrance level comprises of a 17ft lounge / diner with smart tiled flooring, which is open to a modernised kitchen with contemporary cabinetry. A double-height winter garden allows for lots of natural light and provides two useable spaces accessed via the main living area and bedrooms above, overlooking the garden. Both of the bedrooms are of similar proportion, whilst a tastefully finished bathroom with a walk-in shower completes the first floor.

Externally the garden is low maintenance retreat which boasts a south-westerly aspect and a variety of mature planting - a pleasant place to escape to and relax with friends and family. There is also residents parking.

Spinney Gardens is close to both Crystal Palace and Gipsy Hill rail links, as well as the many independent shopping and leisure options that are clustered around the Triangle.

The development has been awarded a number of accolades since build completion for design and energy efficiency, and is a more interesting place to call home.

EPC: C | Council Tax Band: D



Floorplan

Spinney Gardens, SE19

Approximate Gross Internal Area
(Including Winter Garden / Excluding Void / Shed)
68.4 sq m / 736 sq ft

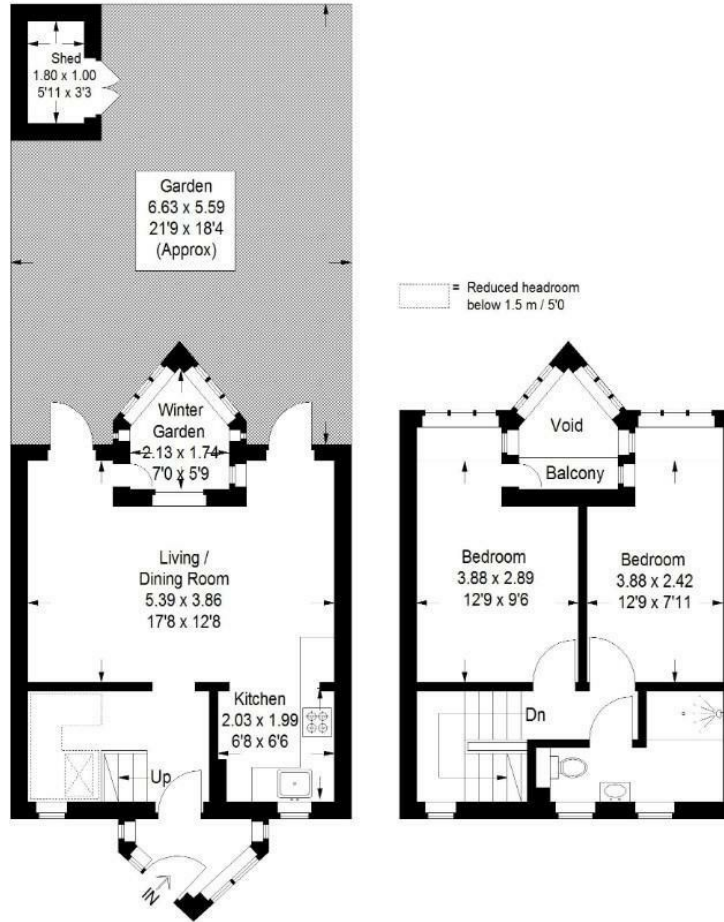

Ground Floor

First Floor

Copyright www.pedderproperty.com © 2026

These plans are for representation purposes only as defined by RICS - Code of Measuring Practice. Not drawn to Scale. Windows and door openings are approximate. Please check all dimensions, shapes and compass bearings before making any decisions reliant upon them.

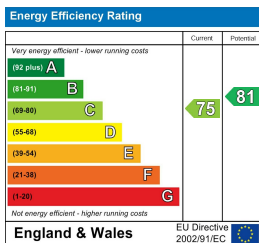

Pedder Property Ltd trading as Pedder for themselves and for the vendor/landlord of this property whose agents they are, give notice that (1) these particulars do not constitute any part of an offer or contract, (2) all statements contained within these particulars are made without responsibility on the part of Pedder or the vendor/landlord, (3) whilst made in good faith, none of the statements contained within these particulars are to be relied upon as a statement of representation or fact, (4) any intending purchaser/tenant must satisfy him/herself by inspection or otherwise as to the correctness of each of the statements contained within these particulars, (5) the vendor/landlord does not make or give either Pedder or any person in their employment any authority to make or give representation or warranty whatsoever in relation to this property.