

Hawthorn Way, St. Ives, PE27 3YP

Offers Over £300,000

3 1 1



- A three bedroom semi-detached home on Hawthorn Way
- Comfortable sitting room and generous kitchen/dining room
- Versatile additional ground floor room with lots of potential
- Garage and driveway providing plenty of parking and storage
- Virtual tour available upon request
- A great opportunity to put your own stamp on a property
- Generous kitchen/dining room ideal for everyday family life
- Good sized rear garden with plenty of space to sit out and entertain
- Well placed for St Ives town centre and the guided busway
- EPC Rating D/64

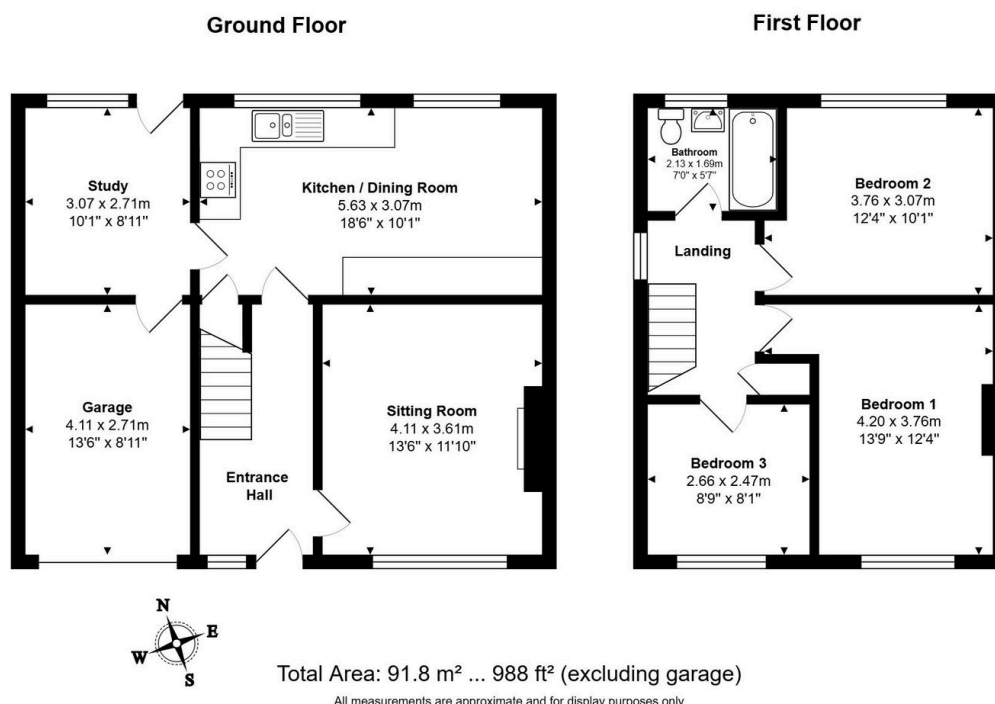

A three bedroom semi-detached home in St Ives with a garage, driveway and plenty of potential to make it your own!