

15-17 Eastgate Street, Bury St. Edmunds, Suffolk, IP33 1XX
Tel: 01284 760770
bury@shiresestateagents.co.uk
www.shiresresidential.com

shires

Estate & Letting Agents



Salter Close, Bury St. Edmunds, Suffolk, IP32 7EQ

Rent - £1,200 PCM Deposit - £1,384

An excellent terraced home located on the popular Moreton Hall with a pleasant outlook over a green area to the front with footpath links to local schools and shops. The property has gas fired central heating to accommodation of Entrance Hall, Kitchen, Sitting/Dining Room with doors to rear garden, Two Bedrooms, Bathroom with shower over bath. The property has an allocated parking space and rear Garden with Shed and gate leading to parking area. The property is offered in good order and viewing is highly recommended. Please note our photographs are from a previous tenant living at the property.

- MODERN TERRACED HOUSE
- 2 BEDROOMS
- BATHROOM WITH SHOWER OVER BATH
- PARKING SPACE & GARDEN
- CLOSE TO THE CENTRE OF BURY ST EDMUNDS
- GAS HEATING & ENERGY RATING - C
- COUNCIL TAX BAND - B
- AVAILABLE FROM MID JULY



Council Tax Band: B - EPC Rating: C 73

GROUND FLOOR

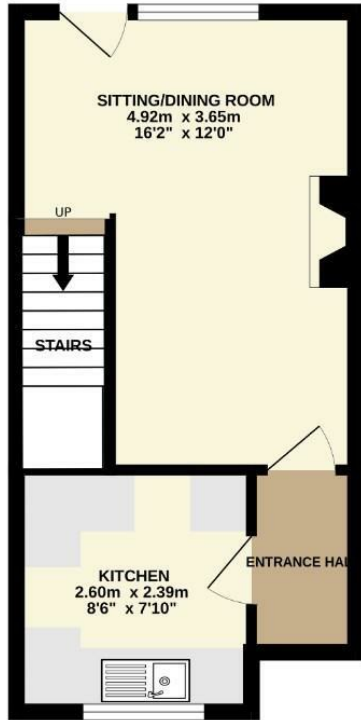

1ST FLOOR

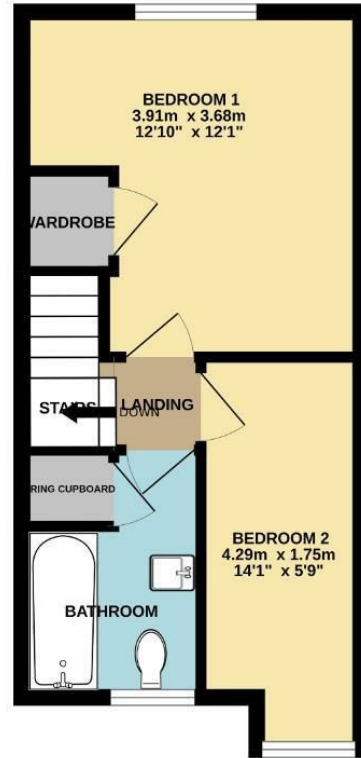

Whilst every attempt has been made to ensure the accuracy of the floorplan contained here, measurements of doors, windows, rooms and any other items are approximate and no responsibility is taken for any error, omission or mis-statement. This plan is for illustrative purposes only and should be used as such by any prospective purchaser. The services, systems and appliances shown have not been tested and no guarantee as to their operability or efficiency can be given.
Made with Metropix ©2025

