



16e Union Street, Melksham, Wiltshire, SN12 7PR

£900 PCM



- Two bedroom end of terrace property
- Enclosed rear garden
- Upvc double glazing
- Long term let
- Gas central heating
- Viewing Day - 8th July

Discover Melksham: A Charming Wiltshire Town with Excellent Connectivity

Nestled along the banks of the River Avon, Melksham is a market town that blends historical charm with modern conveniences. It offers a welcoming community atmosphere complemented by a range of amenities.

Local Amenities and Lifestyle

Melksham boasts a high street filled with independent shops, cafes, and traditional pubs. For leisure and recreation, the town offers several parks and green spaces, including King George V Playing Field, which features a playground, skate park and is home to Melksham Parkrun. The nearby Melksham Community Campus enhances the town's leisure offerings with swimming pool, sports hall, gym and cafe.

THE PROPERTY

Blueleaf Property are delighted to offer this end of terrace two bedroom property located close to the town centre.

The ground floor accommodation comprises kitchen, cloakroom and lounge with under stairs storage cupboard and patio doors onto the rear garden.

The first floor accommodation comprises two bedrooms and family bathroom.

The property further benefits from gas central heating, upvc double glazing and enclosed rear garden with shed and gated side access.

The landlord would prefer a longer term tenancy. Please note the photos were taken prior to the current tenancy.

We have a viewing day set for Wednesday 8th July

All room measurements are approx.;

Kitchen: 3.65m x 2.27m
 Cloakroom: 0.97m x 1.75m
 Lounge: 2.87m x 3.63m
 Bedroom One: 3.66m x 2.03m
 Bedroom Two: 3.66m x 2.18m
 Bathroom: 1.69m x 1.91m

SITUATION

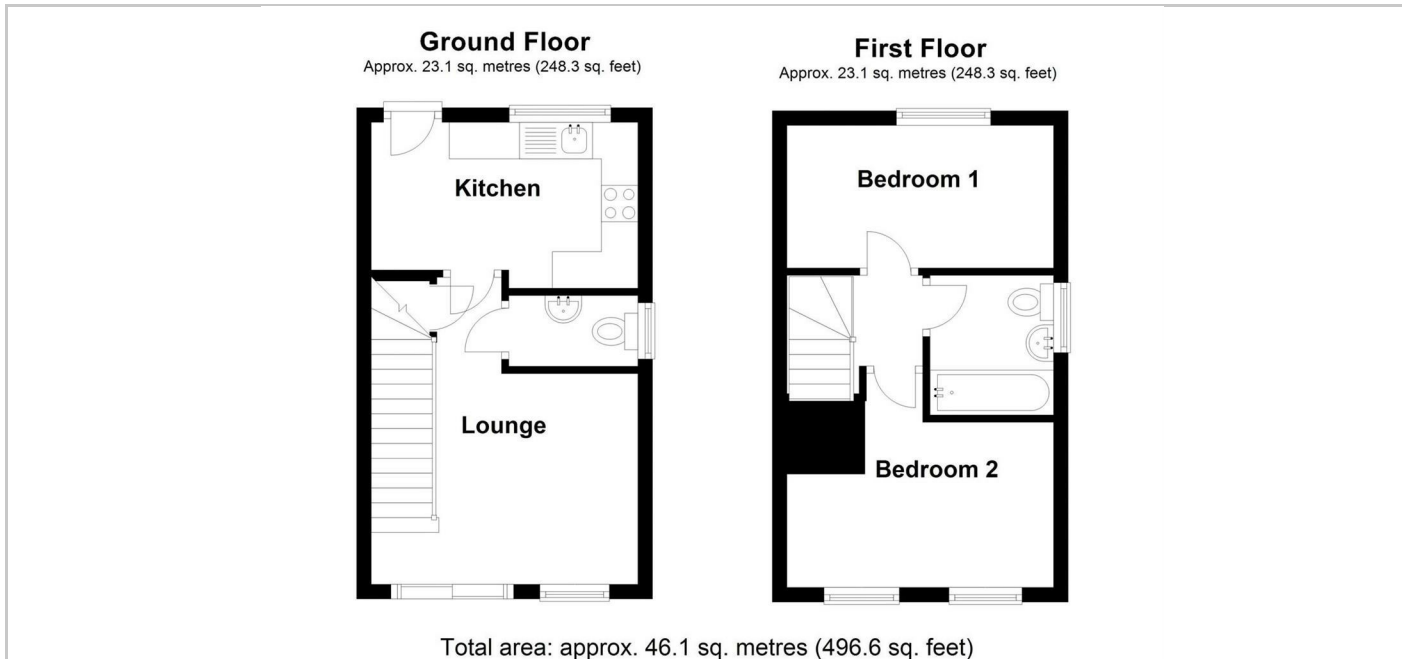

Directions