



**jordan fishwick**

17-19 ALEXANDRA ROAD SALE M33 3EF  
Per Month £1,200 Per Month

## 17-19 ALEXANDRA ROAD SALE M33 3EF

Nestled in the desirable area of Alexandra Road, Sale, this charming two-bedroom house presents an excellent opportunity for those seeking a comfortable and inviting home. The property boasts an attractive exterior, which is sure to catch the eye of passers-by.

Inside, you will find a well-proportioned reception room that offers a warm and welcoming space, perfect for relaxation or entertaining guests. The two bedrooms are thoughtfully designed, providing ample space for rest and personalisation. The bathroom is conveniently located, ensuring ease of access for all residents.

One of the notable features of this property is the parking space available for one vehicle, a valuable asset in this popular location. The surrounding area is known for its vibrant community and excellent amenities, making it an ideal choice for families and professionals alike.

This delightful house is available for rent now, offering a fantastic opportunity to settle into a lovely home in a sought-after neighbourhood. Do not miss the chance to make this property your own.

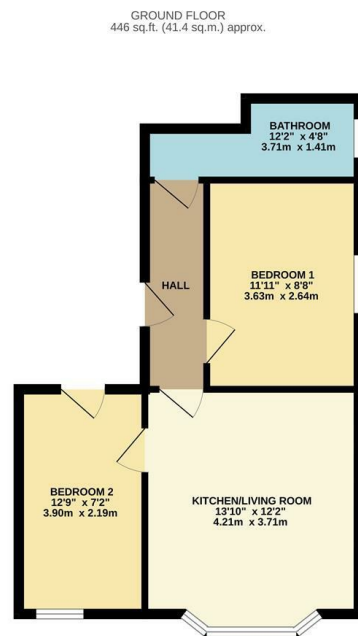

TOTAL FLOOR AREA: 446 sq. ft. (41.4 sq.m.) approx.  
Measurements are approximate. See to scale. Illustrations represent only.  
Made with Metaphor 02/20

- Available Now
- EPC Rating TBC
- Council Tax Band A



Energy Efficiency Rating		Current	Potential
Very energy efficient - lower running costs	(92 plus) <b>A</b>		
(81-91)	<b>B</b>		
(69-80)	<b>C</b>		
(55-68)	<b>D</b>		
(39-54)	<b>E</b>		
(21-38)	<b>F</b>		
(1-20)	<b>G</b>		
Not energy efficient - higher running costs			
<b>England &amp; Wales</b>		EU Directive 2002/91/EC	

Environmental Impact (CO <sub>2</sub> ) Rating		Current	Potential
Very environmentally friendly - lower CO <sub>2</sub> emissions	(92 plus) <b>A</b>		
(81-91)	<b>B</b>		
(69-80)	<b>C</b>		
(55-68)	<b>D</b>		
(39-54)	<b>E</b>		
(21-38)	<b>F</b>		
(1-20)	<b>G</b>		
Not environmentally friendly - higher CO <sub>2</sub> emissions			
<b>England &amp; Wales</b>		EU Directive 2002/91/EC	