





35 Honeysuckle Close, Bessacarr, Doncaster, DN4 7DJ

Guide Price £230,000

3 2 1





Guide Price: £230,000- £240,000

Welcome to Honeysuckle Close, a superb three bedroom town house, offering accommodation arranged over three floors. Situated in a sought-after location, this property is perfect for families looking for a blend of style, comfort, and convenience.

Stepping inside, you are greeted by a welcoming entrance hallway with cloakroom WC, leading to a combined lounge dining room with feature bay and French doors opening onto the rear garden, perfect for entertaining. The modern kitchen at the front of the home has a range of attractive fitments, ample work-surfaces and integrated cooking appliances.

On the first floor, you'll find two bedrooms and a spacious family bathroom, whilst the top floor boasts a generous master bedroom with en suite shower room.

Externally, there is an open plan front garden and a secure enclosed rear garden, ideal for outdoor relaxation. The added benefit of a garage and driveway ensures secure off-road parking.

Located close to excellent local amenities, schools, and transport links, this home ticks all the boxes for modern family living.



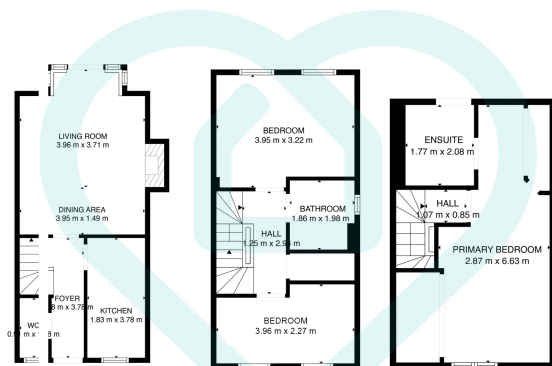

TOTAL: 93 m<sup>2</sup>  
GROUND FLOOR: 35 m<sup>2</sup>, FIRST FLOOR: 33 m<sup>2</sup>, SECOND FLOOR: 25 m<sup>2</sup>  
EXCLUDED AREAS: FIREPLACE: 1 m<sup>2</sup>, LOW CEILING: 1 m<sup>2</sup>  
WALLS: 8 m<sup>2</sup>

This floor plan is for illustrative purposes only. All measurements and layouts are approximations and do not necessarily capture the precise specifications of the property. No responsibility is taken for any error, omission, or misstatement. We always recommend viewing in person to confirm the exact floor plan of a property. Made with Metropix.



- End Town House
- Three Bedrooms
- Two Bathrooms
- Cloakroom WC
- Attractive Kitchen Fitments
- Spacious Lounge / Dining Room
- Enclosed Garden
- Detached Garage & Parking space
- Cul De Sac Position
- Sought After Location

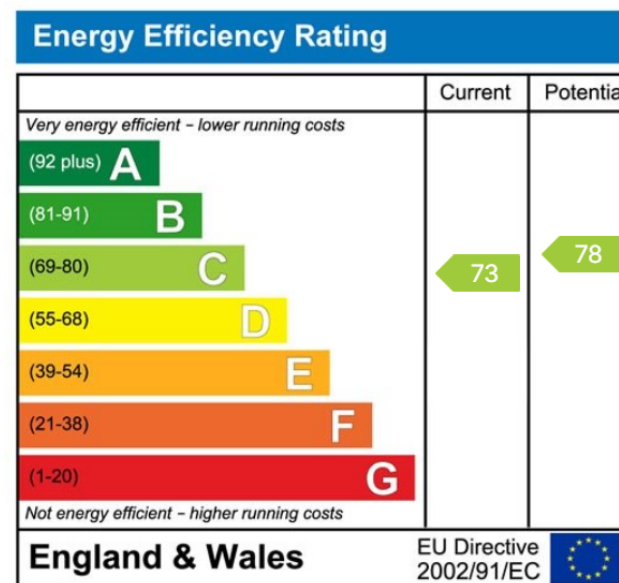

## Sales | Lettings | New Homes

VAT Reg Number: 191 3588 84  
Company Reg Number: 08610489  
Company Reg Address: 67 Middlewood Road, Hillsborough, Sheffield, S6 4GX.

The MorfittSmith Building  
67 Middlewood Road  
Hillsborough  
Sheffield  
S6 4GX

## Get in touch - arrange an appointment



0114 232 1764  
sales@morfittsmith.co.uk  
lettings@morfittsmith.co.uk  
newhomes@morfittsmith.co.uk  
www.morfittsmith.co.uk



@MorfittSmith  
@MorfittSmith  
MorfittSmith  
Estate & Letting Agent