

Towers Wills

Town & Country

📞 01935 577 032 | 01460 298 530 | ✉ info@towerswills.co.uk



20, Lime Tree Avenue, Yeovil, Somerset BA20 2PS

£240,000

Towers Wills are delighted to market this well-presented three-bedroom semi-detached family home, situated in this highly regarded residential location, conveniently positioned close to well regarded schools, local amenities, and Yeovil town centre.

Accommodation:

The property is offered in good decorative order throughout and benefits from a particularly spacious lounge, providing a comfortable and inviting living space. The kitchen diner has been finished to a good standard under the current ownership and offers an excellent area for family dining and entertaining.

Upstairs, the accommodation comprises three well-proportioned bedrooms, all served by a modern family bathroom.

Outside:

To the rear, the property enjoys a low-maintenance enclosed garden, predominantly laid to paved terracing and bordered by timber fencing, with gated side access leading to and from the front of the property.

Further benefits include a single garage and an allocated parking space conveniently located close to the property.

Viewing is highly recommended to fully appreciate this attractive family home located in the popular Lime Tree Avenue area.

Key Features

- Sought-after Location
- Semi Detached
- Three Bedrooms
- Low Maintenance Rear Garden
- Off Road Parking
- Garage in a Block
- Solar Panels

Contact Us

Towers Wills Estate Agents - Yeovil

114, Hendford Hill
Yeovil

Somerset

BA202RF

T: 01935 577032

E: info@towerswills.co.uk

Energy Efficiency

Score	Energy rating	Current	Potential
92+	A		
81-91	B		
69-80	C		72 C
55-68	D	62 D	
39-54	E		
21-38	F		
1-20	G		



Floor Plan

GROUND FLOOR

1ST FLOOR

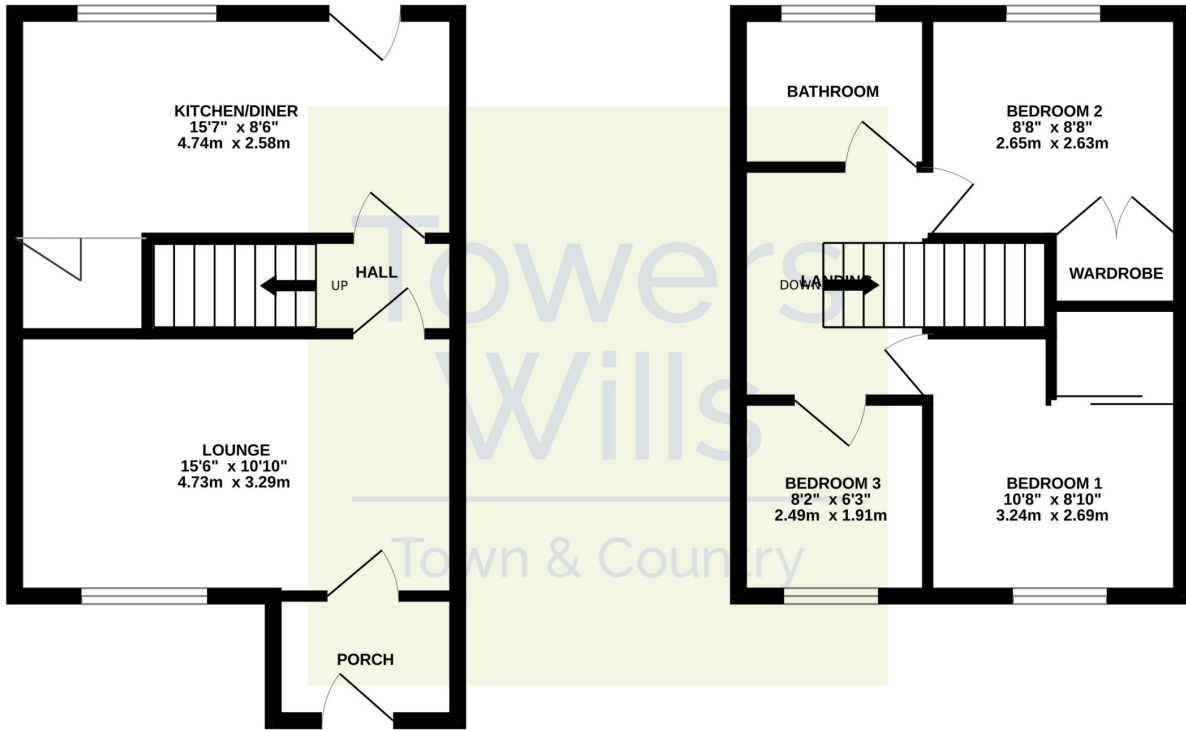

Whilst every attempt has been made to ensure the accuracy of the floorplan contained here, measurements of doors, windows, rooms and any other items are approximate and no responsibility is taken for any error, omission or mis-statement. This plan is for illustrative purposes only and should be used as such by any prospective purchaser. The services, systems and appliances shown have not been tested and no guarantee as to their operability or efficiency can be given.
Made with Metropix ©2026

Please Note No tests have been undertaken of any of the services and any intending purchasers should satisfy themselves in this regard. Towers Wills Ltd for themselves and for the vendor of this property whose agents they are, give notice that, (i) these particulars do not constitute any part of an offer or contract, (ii) all statements contained within these particulars are made without responsibility on the part of Towers Wills or the vendor, (iii) whilst made in good faith, none of the statements contained within these particulars are to be relied upon as a statement of representation or fact, (iv) any intending purchaser must satisfy him/herself by inspection or otherwise as to the correctness of each of the statements contained within these particulars, (v) the vendor does not make or give either Towers Wills or any person in their employment any authority to make or give representation or warranty whatsoever in relation to this property.

Photographs / Floor Plans Photographs are reproduced for general information and it must not be inferred that any item is included for sale with this property. Please note floor plans are not to scale and are for identification purposes only. The photographs used in these particulars may have been taken with the use of a wide angle lens. If you have any queries as to the size of the accommodation or plot, please address these with the agent prior to making an appointment to view

Towers Wills

The White House, 114 Hendford Hill, Yeovil BA20 2RF

Yeovil 01935 577032 / South Petherton 01460 298530

info@towerswills.co.uk | www.towerswills.co.uk