



Old Brompton Road, SW7

£850,000

Set within a highly sought-after location on Old Brompton Road, this stunning split-level two-bedroom flat offers stylish and spacious living throughout.

Located just moments from all of the amenities of Old Brompton Road, making it an ideal and convenient location. South Kensington underground is the closest tube, with the A4 making it convenient for car access in and out of London.

Features

- Two Double Bedrooms
- Long Lease
- Duplex Apartment
- Newly Refurbished
- Roof Terrace
- South Kensington Station



Old Brompton Road, SW7

The property boasts a bright and airy reception room with ample space for both relaxing and dining, a modern kitchen, and a private terrace perfect for entertaining or unwinding. Beautifully presented and filled with natural light, the flat also benefits from generous bedrooms and plenty of storage.

Offered with no onward chain, this is an ideal opportunity for first-time buyers, professionals, or investors looking for a well-located home in the heart of Central London.



Old Brompton Road, London, SW7

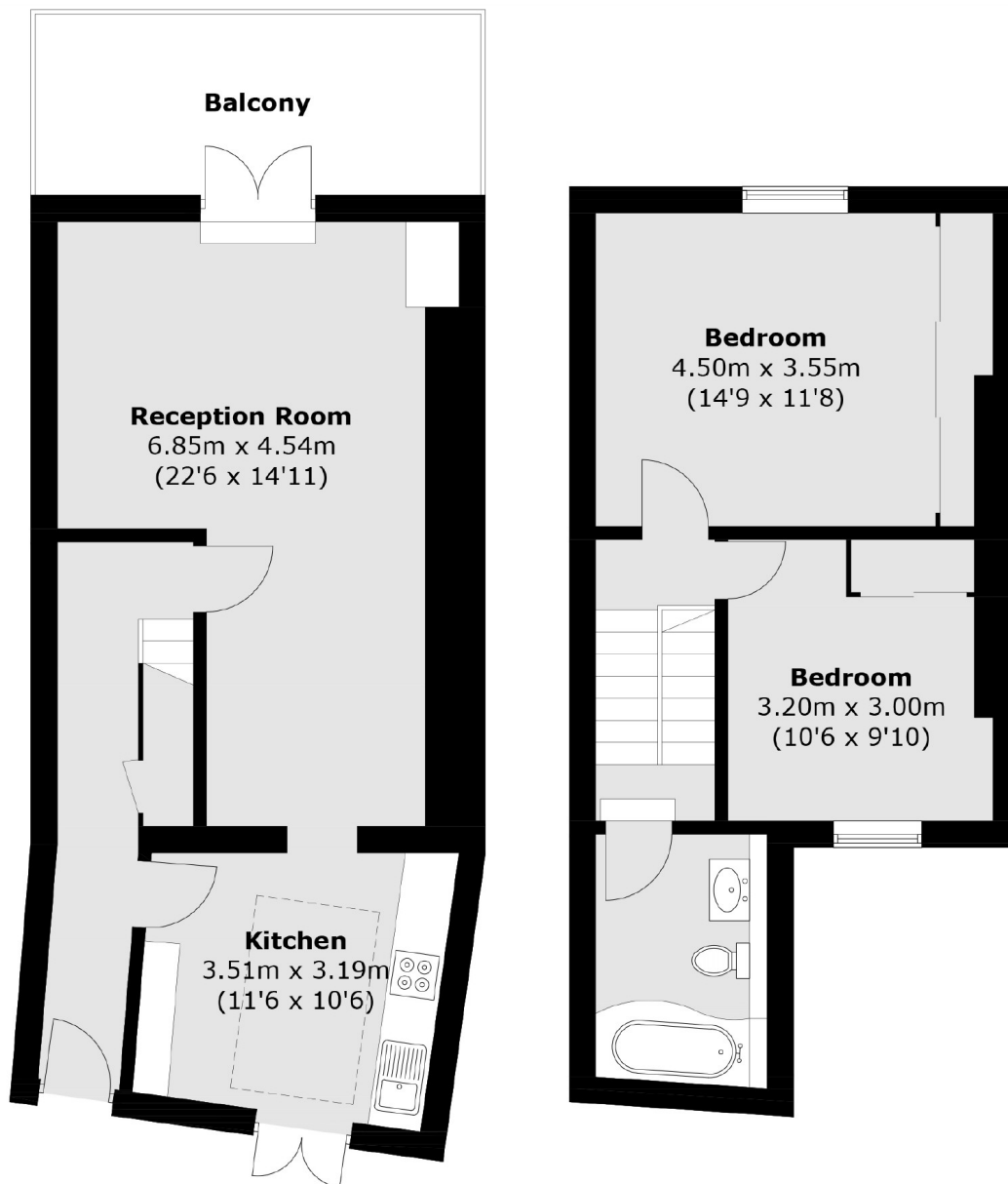

First Floor

Second Floor

Total area (approx.): 82.5 sq. m (888.0 sq. ft)

Balcony: 10.3 sq. m (110.9 sq. ft)