



St Johns Road | Laughton-en-le-Morthen | S25 1YL

Guide Price £180,000 to £190,000

Bell & Co Estates are delighted to present 55a St Johns Road. Beautifully presented throughout, this modern two-bedroom mid-town house enjoys a sought-after position within the heart of the ever-popular village of Laughton-en-le-Morthen, offering stylish accommodation set across three spacious floors. Perfect for first-time buyers, professionals or investors alike, the property combines contemporary living with practicality, all within close proximity to local amenities, countryside walks and excellent transport links. Upon entering the home, you are welcomed into a bright entrance hallway leading into the impressive open-plan kitchen diner. Modern in design, the kitchen offers a range of fitted wall and base units with ample worktop space, creating the perfect setting for both everyday living and entertaining. To the lower ground floor resides a substantial lounge, beautifully presented and offering a cosy yet spacious living area, ideal for relaxing evenings with bi-folding doors opening on to the garden. To the first floor, the property boasts two well-proportioned bedrooms, including a generous principal bedroom complete with fitted wardrobes. A contemporary shower room completes the accommodation, finished with modern fixtures and fittings. To the front of the property is a stoned area with path leading to the front door and to the rear is a low maintenance, enclosed garden with artificial grass and patio, with access to the garage and off-road parking. Early viewing is highly recommended to fully appreciate the accommodation and location on offer.



BASEMENT
275 sq.ft. (25.5 sq.m.) approx.

GROUND FLOOR
275 sq.ft. (25.5 sq.m.) approx.

1ST FLOOR
275 sq.ft. (25.5 sq.m.) approx.

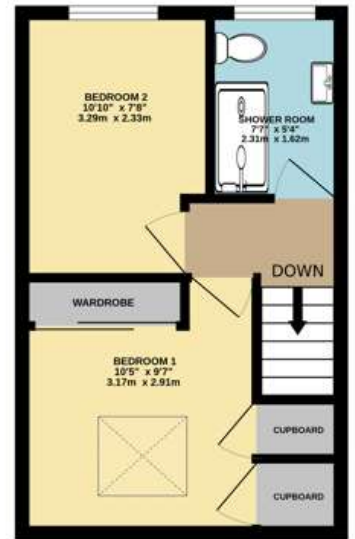
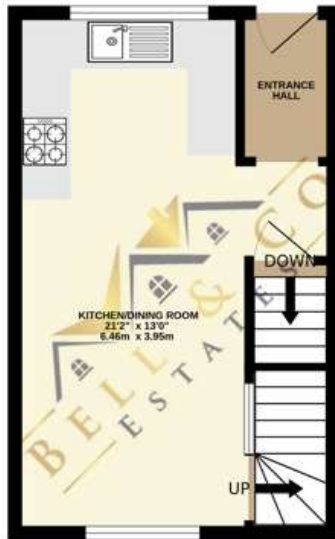
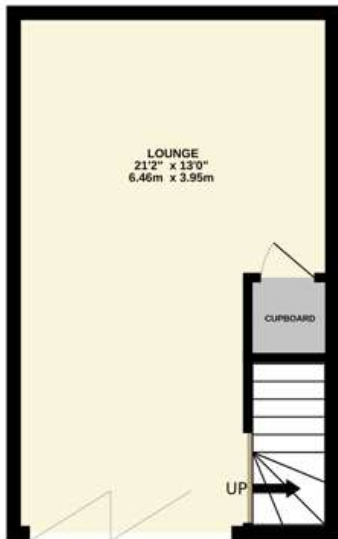

Contact Details

79 Wales Road
Kiveton Park
Sheffield
South Yorkshire
S26 6RA

www.bellcoestates.com
info@bellcoestates.com
03333 580590

55a, St. Johns Road
Laughton
SHEFFIELD
S25 1YL

Energy rating

C

Valid until
23 July 2030

Certificate number
8730-7123-7620-3137-5226

Property type

Mid-terrace house

Total floor area

64 square metres

Agents Note: Whilst every care has been taken to prepare these sales particulars, they are for guidance purposes only. All measurements are approximate and for general guidance purposes only and whilst every care has been taken to ensure their accuracy, they should not be relied upon and potential buyers are advised to recheck the measurements