



Plant Farm Crescent, Waterlooville PO7 3DB

welcome to

Plant Farm Crescent, Waterloo

An immaculately presented two-bedroom top-floor apartment offering open-plan living, a private balcony with far-reaching views, and allocated parking. Long lease and internal viewing highly recommended.

Entrance

Via communal door. Secure buzzer entry.

Entrance Hall

Storage cupboard. Door to utility room, bedrooms and lounge/kitchen.

Utility / Storage Space

Space for washing machine.

Lounge / Kitchen

The kitchen area has a double glazed window, laminate flooring, a range of cupboards with work surface over incorporating sink unit. Breakfast bar, built-in fridge/freezer, low level oven, gas hob with extractor hood over and dishwasher. The lounge area has double glazed French doors opening on to the balcony, laminate flooring, radiator.

Bedroom One

Double glazed windows, built-in wardrobes. Carpet flooring, radiator.

Bedroom Two

Double glazed windows, built-in wardrobes. Carpet flooring, radiator.

Bathroom

Double glazed window. Panel enclosed bath with shower over, low level WC and wash hand basin. Extractor fan.

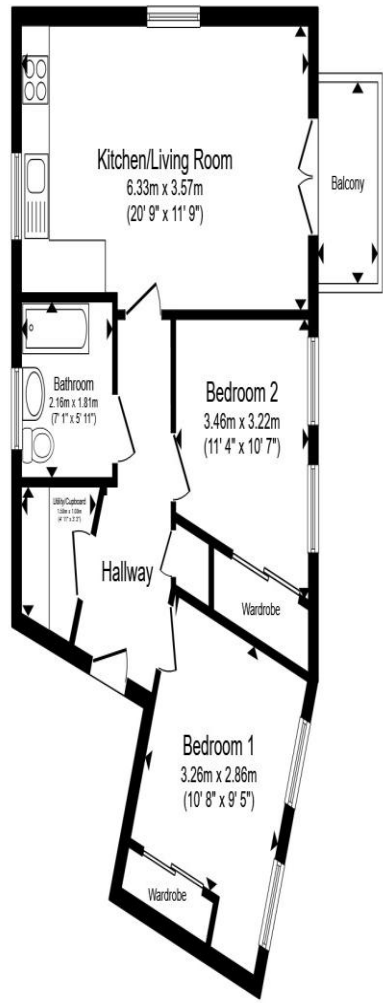

Third Floor

Total floor area 54.9 m² (591 sq.ft.) approx

This floor plan is for illustrative purposes only. It is not drawn to scale. Any measurements, floor areas (including any total floor area), openings and orientation are approximate. No details are guaranteed, they cannot be relied upon for any purpose and they do not form part of any agreement. No liability is taken for any error, omission or misstatement. A party must rely upon its own inspection(s). Powered by www.propertybox.io



welcome to
**Plant Farm Crescent,
Waterlooville**

- Immaculate Top Floor Flat
- Integrated Kitchen Appliances
- Private Balcony with Views
- Security Entry System
- Allocated Parking & Visitor Spaces

Tenure: Leasehold EPC Rating: B
Council Tax Band: B Service Charge: Ask Agent
Ground Rent: Ask Agent

This is a Leasehold property with details as follows; Term of Lease 999 years from 01 Jan 2018. Should you require further information please contact the branch. Please Note additional fees could be incurred for items such as Leasehold packs.

offers in excess of
£220,000



view this property online fox-and-sons.co.uk/Property/WLV109729



Property Ref:
WLV109729 - 0003

1. MONEY LAUNDERING REGULATIONS Intending purchasers will be asked to produce identification documentation at a later stage and we would ask for your co-operation in order that there is no delay in agreeing the sale. 2. These particulars do not constitute part or all of an offer or contract. 3. The measurements indicated are supplied for guidance only and as such must be considered incorrect. Potential buyers are advised to recheck measurements before committing to any expense. 4. We have not tested any apparatus, equipment, fixtures or services and it is in the buyers interest to check the working condition of any appliances. 5. Where an EPC, or a Home Report (Scotland only) is held for this property, it is available for inspection at the branch by appointment. If you require a printed version of a Home Report, you will need to pay a reasonable production charge reflecting printing and other costs. 6. We are not able to offer an opinion either written or verbal on the content of these reports and this must be obtained from your legal representative. 7. Whilst we take care in preparing these reports, a buyer should ensure that his/her legal representative confirms as soon as possible all matters relating to title including the extent and boundaries of the property and other important matters before exchange of contracts.

Fox & Sons is a trading name of Sequence (UK) Limited which is registered in England and Wales under company number 4268443, Registered Office is Cumbria House, 16-20 Hockliffe Street, Leighton Buzzard, Bedfordshire, LU7 1GN. VAT Registration Number is 500 2481 05.



023 9226 2447



Waterlooville@fox-and-sons.co.uk



81B London Road, WATERLOOVILLE,
Hampshire, PO7 7ES



fox-and-sons.co.uk