

for sale

£368,500



Witham Close Taunton TA1 2RR

AN INDIVIDUALLY DESIGNED and recently built three-double bedroom detached family home, is presented in PRISTINE ORDER throughout. Situated in an enviable end-of-cul-de-sac position within the highly favoured Blackbrook area, this impressive property is offered with NO ONWARD CHAIN.



Witham Close Taunton TA1 2RR

Front Door

Leading to...

Entrance Porch

Double glazed door through to the...

Living / Dining Area

A bright and spacious dual-aspect room featuring double glazed windows to the front and rear, with large double glazed sliding doors opening directly onto the patio. Complete with inset lighting and a useful under-stairs storage cupboard.

Kitchen

Equipped with a modern range of wall and base mounted units with complementary work surfaces over. Includes a one and a half bowl sink and drainer unit with a mixer tap, downlighters, an integrated electric oven and grill, a hob with a splashback and cooker hood over, an integrated dishwasher, and a built-in wine rack.

Utility Area

Continuing seamlessly in the style of the kitchen, featuring a work surface, plumbing for an automatic washing machine, and inset lighting. Doorway through to the garage.

Cloakroom



A recessed cloakroom fitted with a modern suite comprising a low-level WC and a wash hand basin with a mixer tap. Features a heated towel rail and an extractor fan.

First Floor Landing

Access to the attic via a hatch. Features a recessed airing cupboard housing the combination boiler.

Bedroom One

A spacious master double bedroom with a double glazed window to the front aspect and a recessed wardrobe.

Bedroom Two

A second double bedroom with a double glazed window to the front aspect and a recessed cupboard.

Bedroom Three

A further double bedroom with a double glazed window to the rear aspect.

Family Bathroom

A contemporary white suite comprising a low-level WC, a wash hand basin set into a vanity cupboard, and a bath with a mixer tap. Large walk-in corner shower cubicle. Features an obscure double glazed window to the rear aspect, inset lights, an extractor fan, and a heated towel rail.

Rear Garden

A secluded and enclosed rear garden blessed with a pitch-roofed covered seating area, ideal for barbecues and outdoor entertaining. Initially laid to a patio, the garden also features a raised shrub bed, an outside water tap, a weatherproof double

electrical socket, and security lighting. Gated side pedestrian access leads to the front, and there is a large additional storage area laid to stone chippings on the opposite side of the property.

Garage & Parking

An integral garage with internal access. To the front of the property, there is a private driveway with the facility to comfortably park two cars as well as an open fronted bike shed.



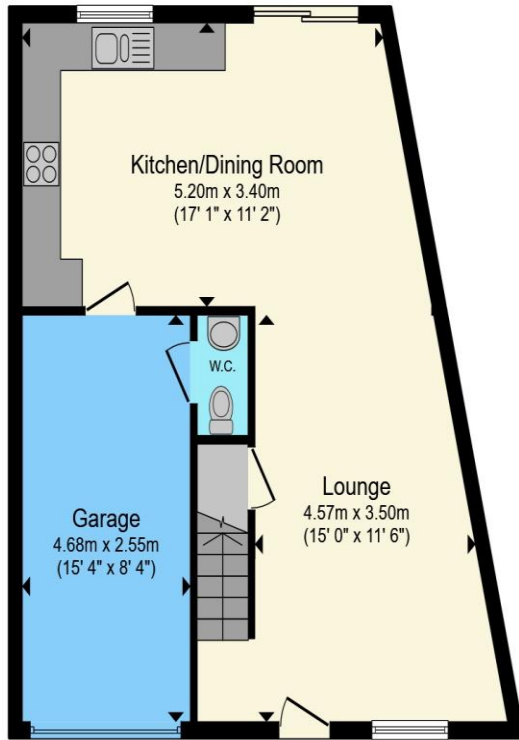

Ground Floor

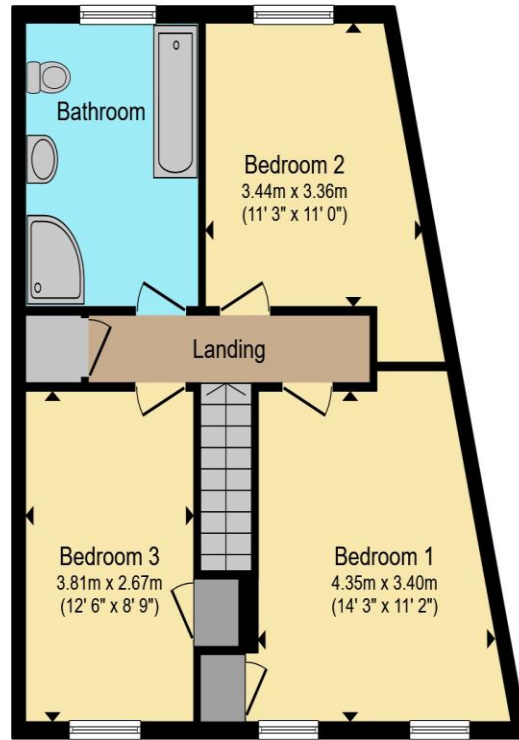

First Floor

Total floor area 115.7 m² (1,245 sq.ft.) approx

This floor plan is for illustrative purposes only. It is not drawn to scale. Any measurements, floor areas (including any total floor area), openings and orientation are approximate. No details are guaranteed, they cannot be relied upon for any purpose and they do not form part of any agreement. No liability is taken for any error, omission or misstatement. A party must rely upon its own inspection(s). Powered by www.propertybox.io



To view this property please contact Connells on

T 01823 334 433
E taunton@connells.co.uk

53 High Street
 TAUNTON TA1 3PR

Property Ref: TTN308100 - 0007

Tenure:Freehold EPC Rating: B

Council Tax Band: D

view this property online
connells.co.uk/Property/TTN308100



1. MONEY LAUNDERING REGULATIONS Intending purchasers will be asked to produce identification documentation at a later stage and we would ask for your co-operation in order that there will be no delay in agreeing the sale. 2. These particulars do not constitute part or all of an offer or contract. 3. The measurements indicated are supplied for guidance only and as such must be considered incorrect. Potential buyers are advised to recheck measurements before committing to any expense. 4. We have not tested any apparatus, equipment, fixtures, fittings or services and it is in the buyers interest to check the working condition of any appliances.

Connells Residential is registered in England and Wales under company number 1489613, Registered Office is Cumbria House, 16-20 Hockliffe Street, Leighton Buzzard, Bedfordshire, LU7 1GN. VAT Registration Number is 500 2481 05.

see all our properties at www.connells.co.uk | www.rightmove.co.uk | www.zoopla.co.uk