



## Empire Square West, SE1

£2,100 Per week

Immaculately presented one bedroom apartment in Empire Square. Situated on the fourth floor the property features an open-plan living space, excellent storage, 24hr onsite concierge and use of a private residents garden.

Empire Square is enviably located at the top of Long Lane, adjacent to Borough High Street & Borough tube, with London Bridge, Borough Market, the Shard, Southbank and Bermondsey Street all moments away.

### Features

- One Bedroom Apartment
- Open Plan Living
- 24hr Concierge
- Private Resident Garden
- Furnished

# Empire Square West, London, SE1

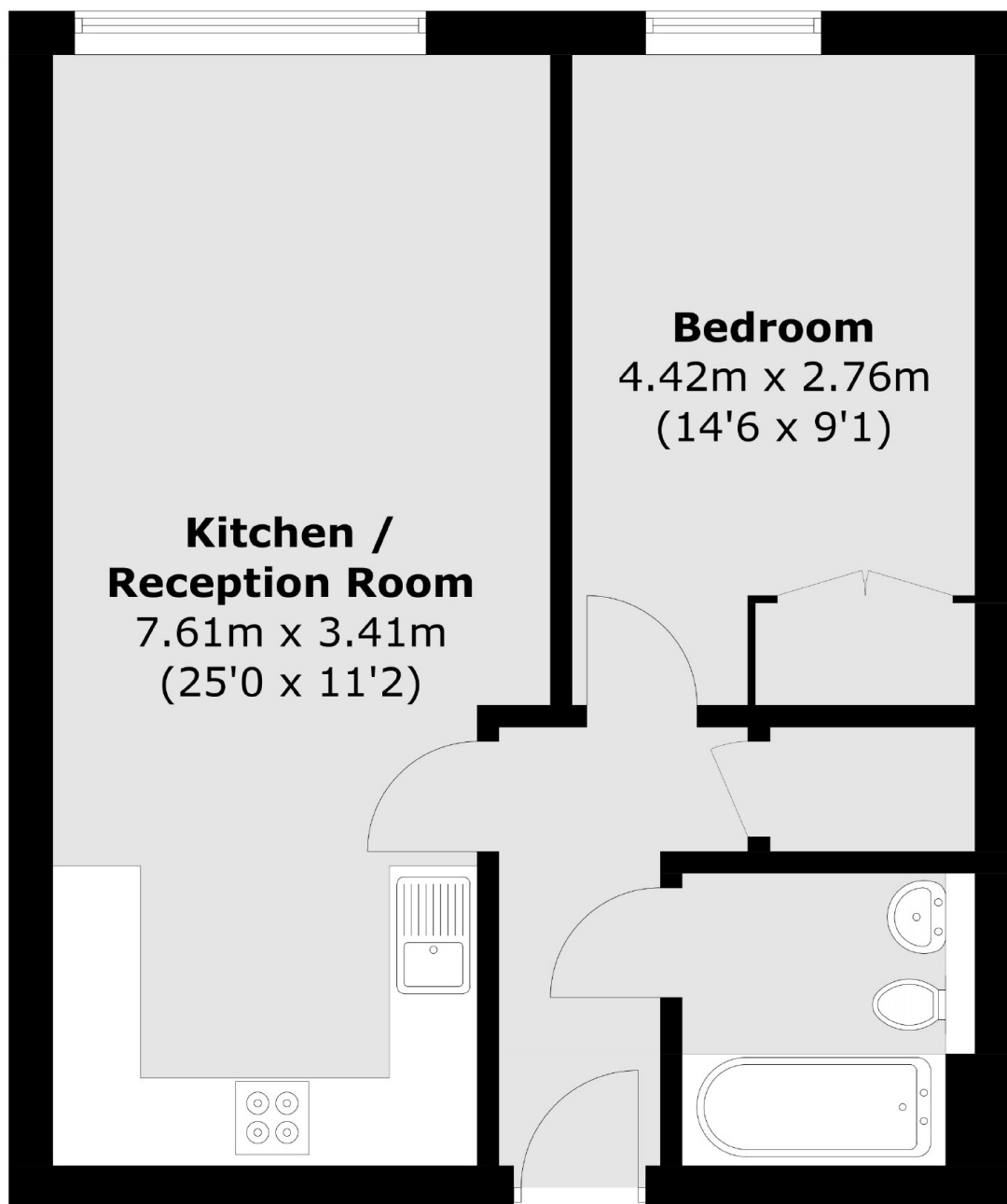

Total area (approx.): 48.0 sq. m (516.7 sq. ft)

**Dexters**

London Bridge  
54 Borough High Street  
London  
SE1 1XL  
Lettings  
020 7650 5101

Energy Rating: D. We aim to make our particulars both accurate and reliable. However they are not guaranteed; nor do they form part of an offer or contract. If you require clarification on any points then please contact us, especially if you're traveling some distance to view. Please note that appliances and heating systems have not been tested and therefore no warranties can be given as to their good working order.

 **RICS** | Regulated  
Estate Agent  
and Letting Agent

dexters.co.uk