



EVELYN STREET, SE8

£350,000

Modern apartment
Two double bedrooms
Balcony
Close to stations
Allocated parking
Energy rating: c

@marshandparsons
marshandparsons.co.uk

MARSH &
PARSONS



ABOUT THE PROPERTY

Set within the heart of vibrant Deptford, this attractive two double bedroom apartment in the highly sought after Drakes Building offers stylish and practical living. Well suited to first-time buyers or investors, the property features a bright open plan living and kitchen area. The apartment comprises two bedrooms, both enhanced by tall windows that allow plenty of natural light, along with a contemporary bathroom suite.

Ideally positioned for convenience with excellent transport links into central London via Deptford station and several bus routes located just outside. Additional benefits include secure entry, allocated parking and close proximity to the characterful Deptford High Street.



STEP INSIDE EVELYN STREET

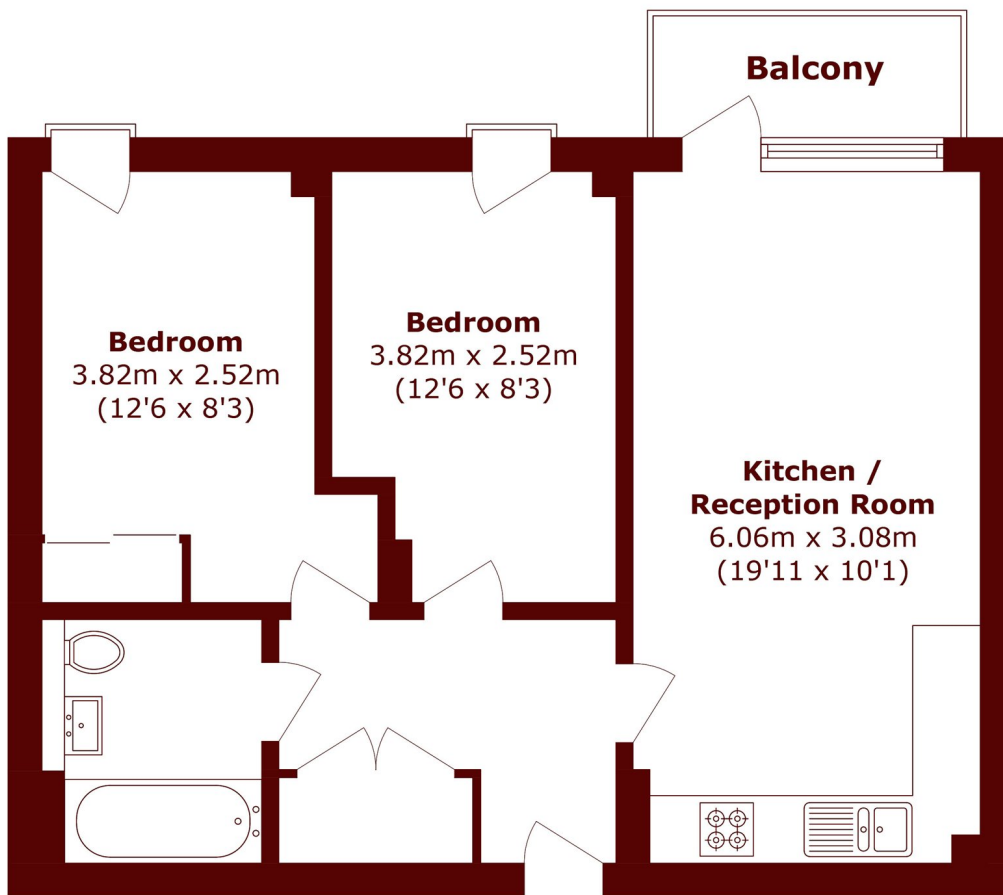

Total area (approx.): 51.0 sq. m (548.9 sq. ft)
Balcony area (approx.): 3.1 sq. m (33.3 sq. ft)

Greenwich
020 8312 8312

Energy Rating: C We aim to make our particulars both accurate and reliable. However, they are not guaranteed; nor do they form part of an offer or contract. If you require clarification on any points then please contact us, especially if you're traveling some distance to view. Please note that appliances and heating systems have not been tested and therefore no warranties can be given as to their good working order

MARSH &
PARSONS