



BROOKLYN BUILDING, SE10

£2,100 per month

Modern apartment
Two bedrooms
One bathroom
Lap pool and gym
24-hour concierge
Energy rating: b

@marshandparsons
marshandparsons.co.uk

MARSH &
PARSONS



ABOUT THE PROPERTY

A well presented two bedroom apartment located in the desirable development, Deals Gateway offering a 24-hour concierge, resident only gym and lap pool. The interior boasts a spacious open plan kitchen and living room.

Both bedrooms are generous doubles, with the master bedroom featuring built-in storage. A modern bathroom includes tiled flooring, a shower and a bathtub.

Throughout the property, there is ample storage, including hallway storage cupboards.

Ideally located with Deptford Bridge DLR station being adjacent to the development providing swift access to Canary Wharf and City. Greenwich station and Greenwich royal park are also within walking distance.



STEP INSIDE BROOKLYN BUILDING

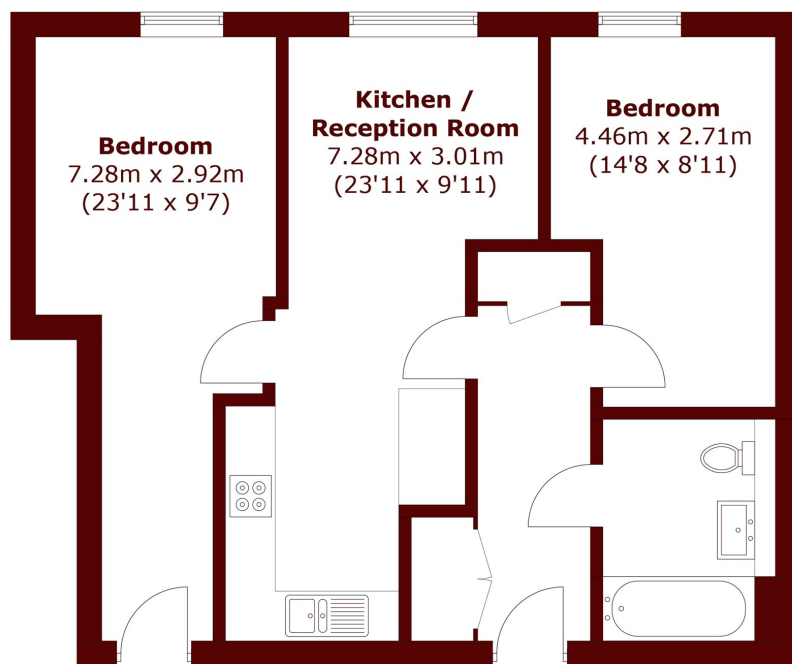

Total area (approx.): 62.1 sq. m (668.4 sq. ft)

Greenwich
020 8815 2230

Energy Rating: B We aim to make our particulars both accurate and reliable. However, they are not guaranteed; nor do they form part of an offer or contract. If you require clarification on any points then please contact us, especially if you're traveling some distance to view. Please note that appliances and heating systems have not been tested and therefore no warranties can be given as to their good working order

**MARSH &
PARSONS**