

West Drive

Brighton

LEXTONS / SALES
LETTINGS
AUCTIONS
COMMERCIAL



About the property

GUIDE PRICE £385,000 - £400,000

This beautifully presented three-bedroom apartment offers bright, generously proportioned accommodation with a practical and thoughtfully designed layout throughout.

A welcoming entrance hall with fresh carpeting provides access to all principal rooms, along with a useful utility room with plumbing for a washing machine and space for a separate tumble dryer. An additional airing cupboard offers excellent storage.

The main bathroom is finished to a modern standard, featuring a double shower cubicle with rainfall shower and separate attachment, pedestal basin, low-level W.C., chrome heated towel rail, strong extractor fan and contemporary tiled flooring.

There are three well-sized double bedrooms, all carpeted for comfort. Bedroom one enjoys a south-facing wooden double-glazed sash window overlooking the gardens of West Drive, Queens Park, allowing for plenty of natural light. Bedroom three benefits from a west-facing sash window and includes a cupboard housing the boiler. Bedroom two is similar in size to bedroom one and offers flexible use as a principal bedroom, with the added advantage of a south-facing window and a stylish en-suite shower room. The en-suite comprises a large walk-in shower with powerful shower and handheld attachment, generous wash basin with storage below, low-level W.C., and extractor fan.

The kitchen/living area is a particularly sociable and well-configured space. The contemporary kitchen features granite worktops, eye- and base-level units, integrated dishwasher and fridge freezer, AEG induction hob and electric oven. The living and dining area is set on solid wood flooring and comfortably accommodates a large sofa and dining table. Double wood and glass doors open onto a west-facing balcony, providing excellent afternoon light.

West Drive Brighton



3

BEDROOM

1

RECEPTION

2

BATHROOM









SCAN HERE TO OFFER ON THIS PROPERTY

Third Floor

Approx. 68.3 sq. metres (735.0 sq. feet)

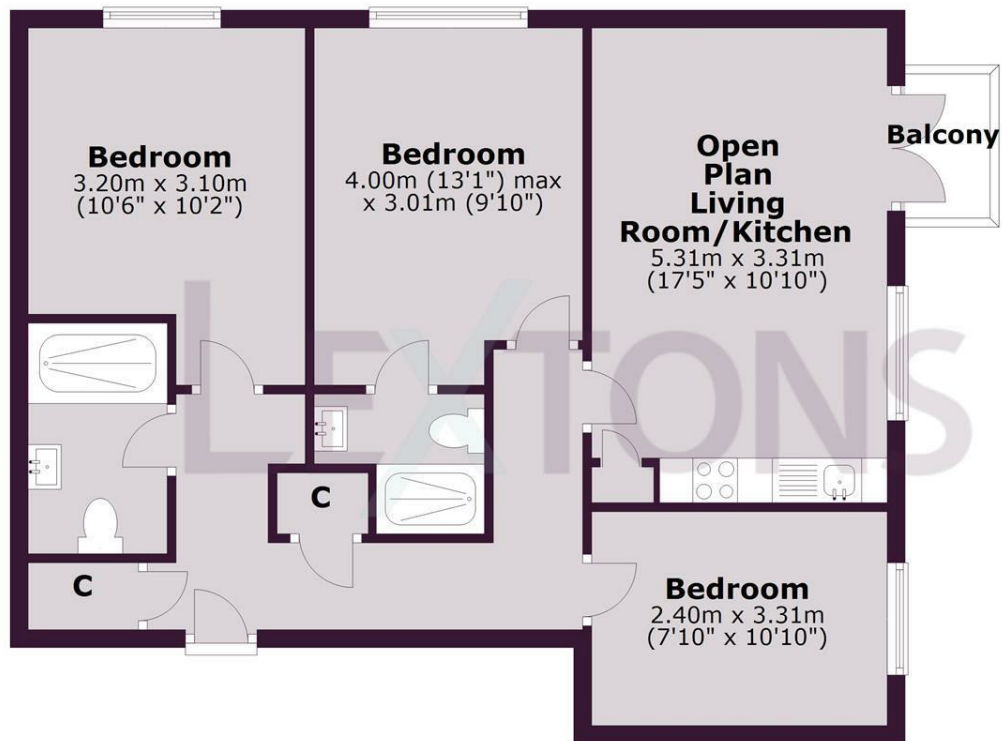

Total area: approx. 68.3 sq. metres (735.0 sq. feet)

Whilst every care has been taken to ensure accuracy, dimensions are approximate and for illustrative purposes only.

Created for exclusive use for Lextons. All rights reserved.
Plan produced using PlanUp.

Energy Efficiency Rating		Current	Potential
Very energy efficient - lower running costs			
(92 plus) A			
(81-91) B			
(69-80) C		77	79
(55-68) D			
(39-54) E			
(21-38) F			
(1-20) G			
Not energy efficient - higher running costs			
England & Wales		EU Directive 2002/91/EC	