



#### OFFICE HOURS:

Monday to Friday	9 am	to	5 pm
Saturday	9 am	to	2 pm
Sunday and Bank Holidays	12 noon	to	2 pm

## 10 good reasons to choose DMA

- \* Open 7 days a week.
- \* Filey's longest established family run independent estate agency.
- \* Prompt efficient friendly service.
- \* 360° virtual tours and floor plans.
- \* Free advertising: no sale - no charge.
- \* Free no obligation market valuation.
- \* Free accompanied viewing.
- \* Dedicated sales progression.
- \* Prominent town centre location.
- \* Modern walk-round self selection display.

RESIDENTIAL  
SALES

**DMA** ESTATE  
AGENTS

COMMERCIAL  
SALES



Proprietors: **David Mansfield ATTON FNAEA.**  
**Samantha ADDISON**  
[www.dmaestateagents.co.uk](http://www.dmaestateagents.co.uk)  
**ESTABLISHED 1992**



These particulars are intended only to give a fair description of the property, as a guide to prospective buyers. Accordingly a) their accuracy is not guaranteed and neither DMA Estate Agents nor the vendor(s) accept any liability in respect of their contents; b) they do not constitute an offer or contract of sale, and c) any prospective purchaser should satisfy themselves by inspection or otherwise as to the correctness of any statement or information in these particulars.

# DMA

ESTATE  
AGENTS



29 PLANE TREE WAY, FILEY YO14 9PA



**Freehold £179,950**

#### FEATURES

- \* Well presented two bedroom town house.
- \* Located on a quiet cul-de sac on the popular country park estate.
- \* Gas central heating.
- \* Upvc double glazing.
- \* Modern kitchen and shower room.
- \* Enclosed rear garden.
- \* Garage and parking.
- \* **EPC Rating: D.**
- \* Viewing is highly recommended.

#### ACCOMMODATION IN BRIEF

GROUND FLOOR: Front Door to Entrance Lobby. Lounge. Dining Kitchen.  
 FIRST FLOOR: Two Bedrooms. Shower Room.  
 OUTSIDE: Front garden. Enclosed rear garden. Garage and parking in adjacent parking area.

**26 Belle Vue Street, FILEY, North Yorks. YO14 9HY. Telephone: 01723 515527**  
[www.dmaestateagents.co.uk](http://www.dmaestateagents.co.uk) / [www.rightmove.co.uk](http://www.rightmove.co.uk)



## Floor Plan:

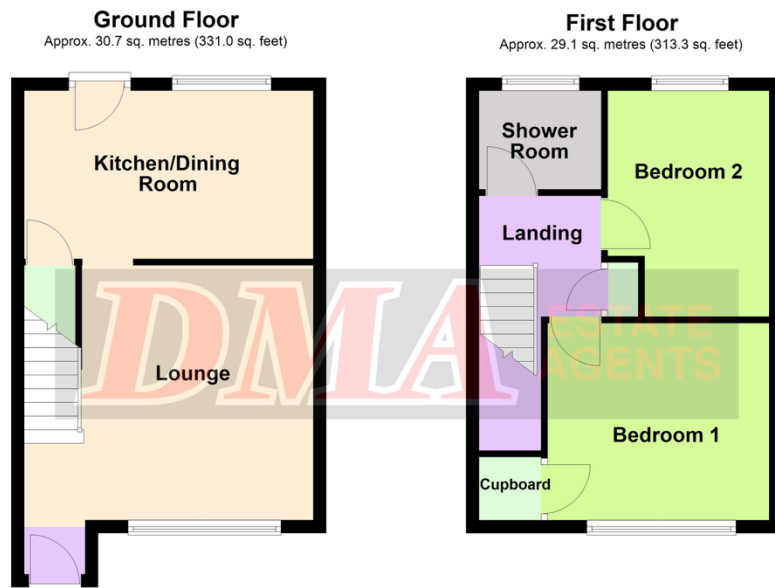

Total area: approx. 59.9 sq. metres (644.3 sq. feet)

Please note this floor plan is only a guide and not to scale.  
Plan produced using PlanUp.

29 Plane Tree Way, Filey

29 PLANE TREE WAY, FILEY

**Upvc Front Door to ENTRANCE PORCH**

**LOUNGE**

**3.96m x 3.61m (13'0" x 11'10")**

Feature fireplace. Wall lights. Radiator. Upvc double glazed window.



**KITCHEN / DINER**

**4.50m x 2.62m (14'9" x 8'7")**

Inset granite style sink and drainer. Base cupboards with worktops over. Matching wall cupboards. Wall mounted gas combination boiler. Electric cooker point with extractor hood over. Plumbing for automatic washing machine. Space for tall 'fridge / freezer. Understairs cupboard. Radiator. Upvc double glazed window. **Upvc double glazed French door to garden.**



/ continued over

**Open plan staircase from Lounge to:**

**FIRST FLOOR:**

**LANDING**

Built-in cupboard.

**BEDROOM ONE**

**3.51m x 3.05m** (11'6" x 10'0")

Built-in cupboard. Radiator. Upvc double glazed window.



**BEDROOM TWO**

**3.35m x 2.51m** (11'0" x 8'3")

Radiator. Upvc double glazed window.



**SHOWER ROOM**

Quadrant shower with 'Triton' shower. Handbasin and wc. Tiled walls. Chrome towel radiator. Upvc double glazed window.



**OUTSIDE:**

Small front garden. Enclosed low maintenance rear garden. **SHED. GREENHOUSE.** Concrete **GARAGE 5.41m x 2.54m** (17'9" x 8'8") in adjacent block.



**Council Tax Band**

**B.**

**DIRECTIONS:**

Take the Scarborough road out of Filey and take the last turning on the right off Scarborough Road onto Sycamore Avenue. Plane Tree Way is the first turning on the left and the property is located at the top of the cul-de-sac.

**Viewing strictly by appointment only through DMA Estate Agents**