



19 St. Georges Avenue, Timperley

£430,000 Freehold

Council Tax band: C

Tenure: Freehold



**HIBBERT
HOMES**

SALES & LETTINGS

This extended three bedroom semi detached house presents an excellent opportunity for families seeking a good size family home in a highly desirable location. Situated within close proximity to Timperley Village, this property benefits from easy access to local amenities, reputable schools, and convenient transport links, including nearby motorways. The spacious interior features two generously sized double bedrooms and a further single bedroom, offering flexible accommodation for growing families or those requiring a home office. The ground floor comprises a welcoming entrance hall leading to a bright and airy lounge, a separate dining area, and a modern fitted kitchen, providing ample space. Additional features include off road parking, gas central heating, and double glazing throughout. The property's thoughtful extension enhances the living space, making it an ideal family home that combines practicality with comfort. Viewing is highly recommended to fully appreciate the quality and potential this home has to offer. Whether you are upsizing or relocating to the area, this property is perfectly positioned to meet the



- Extended Three Bedroom Semi Detached
- Off Road Parking
- Ideal Family Home
- Located Within Close Proximity To Timperley Village
- Easy Access To The Motorways and Transport Links
- Viewing Highly Recommended
- Located Close Proximity To Local Schools
- Two Double Bedrooms





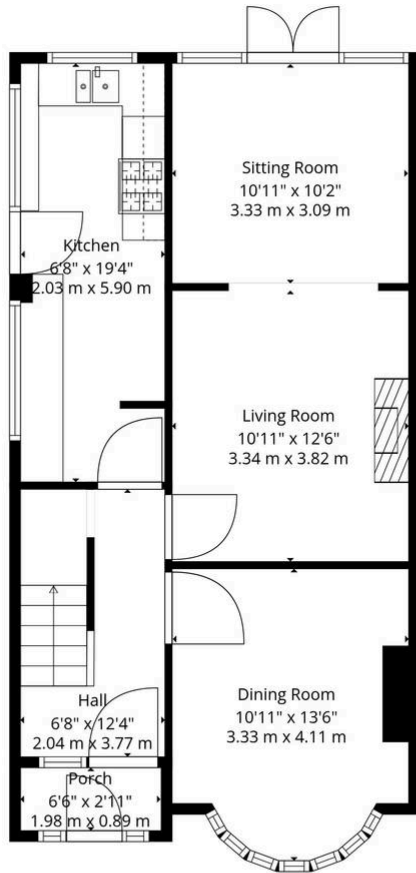

1st Floor

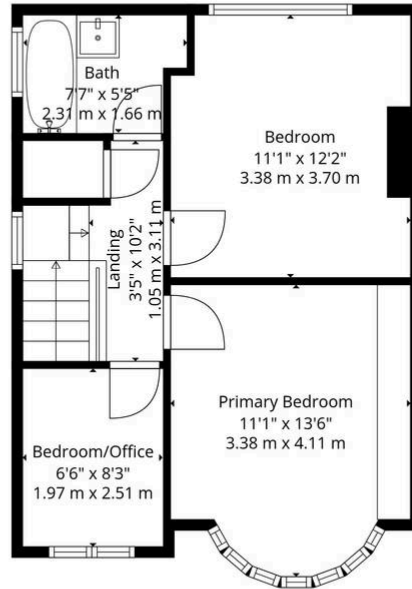

2nd Floor

TOTAL: 1062 sq. ft, 99 m2
 1st floor: 619 sq. ft, 58 m2, 2nd floor: 443 sq. ft, 41 m2
 EXCLUDED AREAS: PORCH: 20 sq. ft, 2 m2, WALLS: 97 sq. ft, 8 m2

Floor Plan Created By Cubicasa App. Measurements Deemed Highly Reliable But Not Guaranteed.



You can include any text here. The text can be modified upon generating your brochure.

