



Connells

Jireh Court
HAYWARDS HEATH



Property Description

New to the market is this impressive split level maisonette in the popular development of Jireh Court and within walking distance to Haywards Heath train station, you can be on the platform in 5 minutes - making this perfect for commuters! The Broadway is just around the corner offering ample restaurants and restaurants and with Haywards Heath town centre also close.

Split over two levels makes this maisonette feel more like a house with it's own private front door. The accommodation comprises entrance hall with stairs to first floor, lounge with door to balcony and door to kitchen.

The first floor offers two double bedrooms and a bathroom.

Jireh Court has permit parking and each flat comes with one permit and one guest permit however this property also comes with a garage.









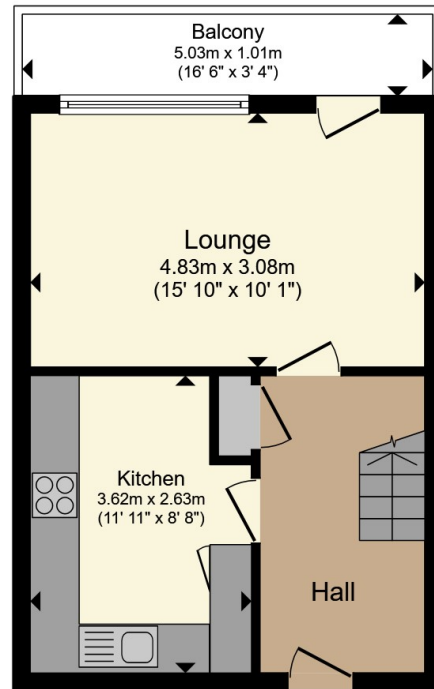

Ground Floor

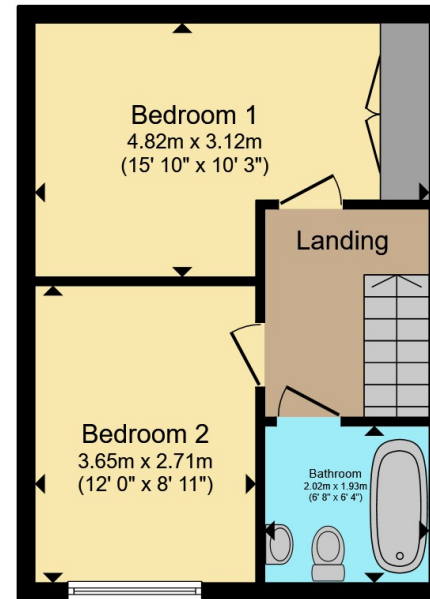

First Floor

Total floor area 66.4 m² (715 sq.ft.) approx

This floor plan is for illustrative purposes only. It is not drawn to scale. Any measurements, floor areas (including any total floor area), openings and orientation are approximate. No details are guaranteed, they cannot be relied upon for any purpose and they do not form part of any agreement. No liability is taken for any error, omission or misstatement. A party must rely upon its own inspection(s). Powered by www.propertybox.io



To view this property please contact Connells on

T 01444 441 441
E haywardsheath@connells.co.uk

135 South Road
HAYWARDS HEATH RH16 4LY

EPC Rating: C Council Tax Band: B

Service Charge: 2325.00

Ground Rent: 5.00

Tenure: Leasehold

view this property online connells.co.uk/Property/HAY405704

This is a Leasehold property with details as follows; Term of Lease 999 years from 29 Sep 1959. Should you require further information please contact the branch. Please Note additional fees could be incurred for items such as

1. MONEY LAUNDERING REGULATIONS Intending purchasers will be asked to produce identification documentation at a later stage and we would ask for your co-operation in order that there will be no delay in agreeing the sale. 2. These particulars do not constitute part or all of an offer or contract. 3. The measurements indicated are supplied for guidance only and as such must be considered incorrect. Potential buyers are advised to recheck measurements before committing to any expense. 4. We have not tested any apparatus, equipment, fixtures, fittings or services and it is in the buyers interest to check the working condition of any appliances.

Connells Residential is registered in England and Wales under company number 1489613, Registered Office is Cumbria House, 16-20 Hockliffe Street, Leighton Buzzard, Bedfordshire, LU7 1GN. VAT Registration Number is 500 2481 05.



See all our properties at www.connells.co.uk | www.rightmove.co.uk | www.zoopla.co.uk

Property Ref: HAY405704 - 0002