



**Taylor's**

# Redholme Court, Red Hill, Oldswinford, DY8 1ND

🛏️ 2 🚿 1 🚗 1



This well presented and modernised two bedroom first floor flat is ideally situated in Redholme Court, Red Hill, offering convenient access to Stourbridge Town Centre, local transport links including the train station and nearby bus stops.

The property briefly comprises a welcoming entrance hall leading to a modern re fitted kitchen, complete with a built in oven and hob. The spacious living room provides ample room for both relaxation and a designated dining area, making it perfect for everyday living and entertaining.

There are two bedrooms, each benefiting from a useful storage cupboard ideal for wardrobe space. The accommodation is further enhanced by a modern refitted shower room.

Additional features include a practical storage cupboard housing the electric boiler, washing machine and tumble dryer, ensuring efficient use of space.

Externally, the property enjoys access to well maintained communal gardens, communal parking, and the added benefit of a garage.

Offered in ready to move into condition, this property is perfectly suited anyone looking for a conveniently located home with modern finishes throughout.

Early viewing is highly recommended.

Tenure: Leasehold, Lease term: from 18 October 2016 to 24 December 2137, Service charge: £1200 per year, Ground rent: £40 per year, Construction: Standard/Purpose built, Services: All mains (No gas). Broadband/Mobile coverage: Visit: [checker.ofcom.org.uk/en-gb/broadband-coverage](http://checker.ofcom.org.uk/en-gb/broadband-coverage). Council Tax Band B. EPC D.

**Entrance Hall** - 0.84m x 2.97m (2'9" x 9'9") L Shaped x 0.84m x 4.78m (2'9" x 15'8")

**Kitchen** - 3.45m x 1.68m (11'4" x 5'6")

**Living Room** - 5.66m x 3.1m (18'7" x 10'2")

**Bedroom One** - 4.11m x 3.07m (13'6" x 10'1") Plus storage cupboard

**Bedroom Two** - 2.84m x 1.91m (9'4" x 6'3") plus storage cupboard

**Shower Room** - 2.01m x 1.75m (6'7" x 5'9") At widest points

**Storage cupboard** - 1.09m x 0.81m (3'7" x 2'8")

**Garage**





- FANTASTIC RE FITTED MODERN KITCHEN
- TWO BEDROOMS
- CONVENIENTLY LOCATED
- TASTEFULLY DECORATED THROUGHOUT
- MODERN SHOWER ROOM
- IDEAL FOR FIRST TIME BUYERS OR DOWNSIZERS

### Redholme Court, Red Hill, Oldswinford, DY8 1ND

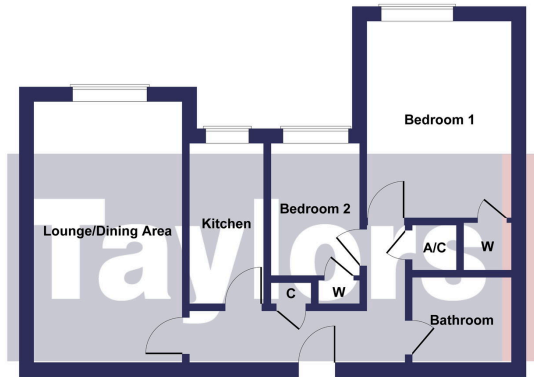

**FOR GUIDE PURPOSES ONLY:**

Whilst every attempt has been made to ensure the accuracy of the floor plan contained here, measurements of doors, windows, rooms and any other items are approximate and no responsibility is taken for any error, omission, or mis-statement. This plan is for illustrative purposes only and should be used as such by any prospective purchaser. The services, systems and appliances shown have not been tested and no guarantee as to their operability or efficiency can be given. This floor plan is provided strictly for the purpose of providing a guide and is not intended to be sufficiently accurate for any purpose. Taylors Estate Agents do not accept any responsibility for errors or misuse. Prospective buyers must always seek their own verification of a layout, or seek the advice of their own professional advisors (surveyor or solicitor).

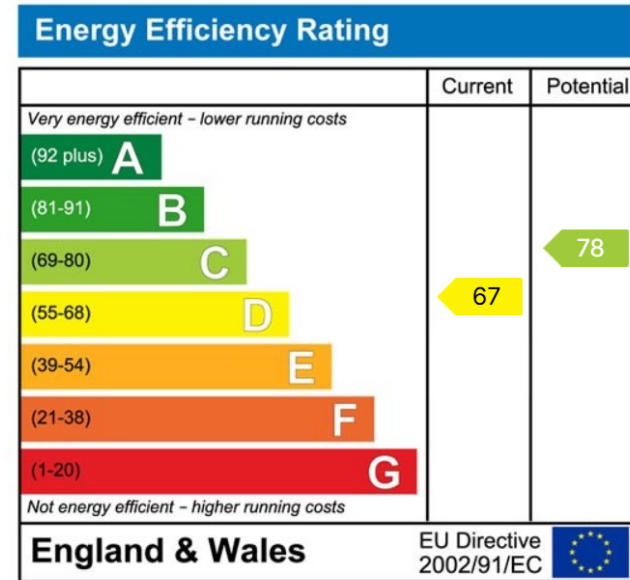

**MISREPRESENTATION ACT 1967:** These particulars do not constitute any part of an offer or a contract. Whilst every care is taken to ensure accuracy, no responsibility for errors or misdescription is accepted. Any intending purchaser must satisfy themselves by inspection or otherwise as to the correctness of each of the statements in these particulars. The vendor does not make nor give, and neither Taylors nor any person in their employment has any authority to make or give any representation or warranty whatsoever about this property. As the seller's estate agents, we are not surveyors or conveyancing experts, and we cannot comment on the property's condition or issues relating to the title or other legal issues that may affect this property unless we have been made aware of such matters. Interested parties should employ professionals to make such enquiries before making transactional decisions. **EPC:** can be supplied free of charge. **CONSUMER PROTECTION REGULATIONS (2008):** These particulars have been prepared with care and approved by the vendors (where possible) but are intended as a guide only, with measurements being approximate and usually the maximum size, which may include alcoves, recesses or otherwise as described, and you must NOT rely on them for any other purpose. The appearance of an item in any photograph does not mean that it forms part of the property or sale price. **FIXTURES AND FITTINGS:** Only those items specifically mentioned in these sales particulars are included in the sale price. Taylors have NOT tested any apparatus, equipment, fixture or fitting and cannot verify they are in working order or fit for their purpose. **PLANNING PERMISSION / BUILDING REGULATIONS:** Any reference to the property being extended, altered or converted in any way does not infer that planning permission or building regulations have been granted or applied for, nor do Taylors accept any responsibility for such not having been obtained. **FLOOR PLAN:** This plan is for illustrative purposes only. The services, systems and appliances shown have not been tested and no guarantee as to their operability or efficiency can be given.