



Rosina Street, E9

£595,000

A two double bedroom top floor flat in a modern, secure development in a convenient E9 location. Built in 2017, the development has secure entry, secure bike storage and lift access. The flat sits at the top corner of the building with views over East London & Canary Wharf. There is an open plan kitchen living room with floor to ceiling windows, wooden flooring and underfloor heating. It is being sold chain free.

Homerton High Street & Chatsworth Road offers an abundance of local restaurants, shops and a Sunday market on your doorstep. Victoria Park, Mare Street and Broadway Market are a short cycle away, and Homerton Overground is 500ft away offering direct access to Stratford and the Elizabeth Line.

Features

- Two Double Bedrooms
- Top Floor
- Roof Terrace
- Unobstructed Views
- Chain Free
- Lift Access & Bike Storage

Rosina Street, London, E9

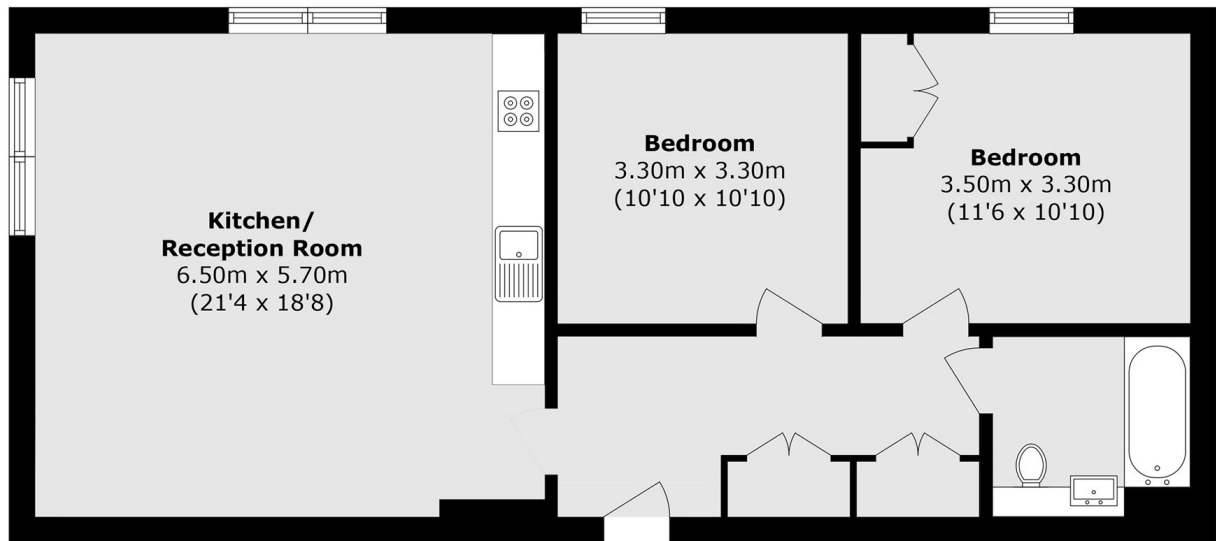

Total area (approx.): 72.3 sq. m (778.2 sq. ft)