

Annan

Call 01461 202 866/867

Offers Over £105,000

CULLEN KILSHAW
SOLICITORS & ESTATE AGENTS

WWW.CULLENKILSHAW.COM



**14 Tweedie Terrace,
Annan, DG12 6SN**



Attractive two bedroom bungalow in popular and sought after area of Annan which has good sized accommodation and ease of maintenance gardens. The property is close to a local shop and also the town centre for all local amenities. Being freshly decorated gives the property a nice bright feel. Viewing is highly recommended to fully appreciate and this would ideally suit a first-time buyer, retirement downsize or investor.

Features

Freshly decorated, new carpets and inners doors

Good-sized accommodation

Close to local shop

Ease of maintenance gardens

Short walk to town centre

Ideal for first-time buyers or retirement downsize

Accommodation

Accommodation comprises:-

Living room, kitchen, two bedrooms and bathroom.

Gardens to front and back

14 Tweedie Terrace, Annan

Approximate Gross Internal Area = 58.6 sq m / 631 sq ft

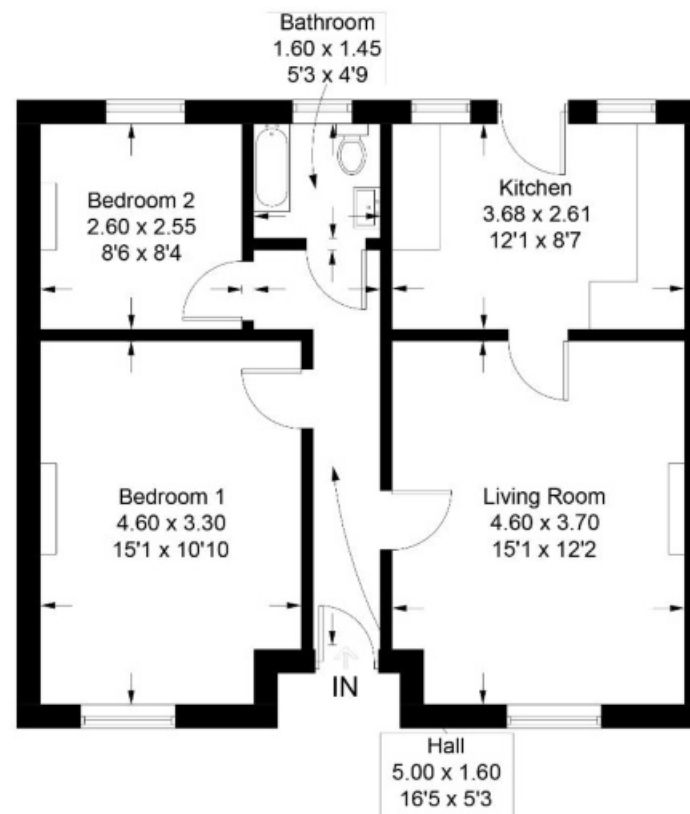

Illustration for identification purposes only, measurements are approximate, not to scale. Fourlabs.co © (ID1315357)

Situation

ANNAN

Annan is a town on the north shore of the Solway Firth and is just eight miles from the English border. Annan lies on the east side of the River Annan and gives access to the Annan harbour. Annan enjoys easy access to major road links both north and south. The Royal Burgh of Annan has a bustling high street with a good range of locally run shops, supermarkets and several cafes and restaurants. It has a selection of leisure facilities and has both primary and secondary schooling. Annan station has commuter links between Carlisle, Dumfries and Glasgow.

POWFOOT

Powfoot is a coastal village which lies on the shore of the Solway Firth. It is situated approximately 4 miles from the town of Annan. A local river runs through the village called The Pow water. This village is community orientated with public bowling green and gardens in which local events take place and retains a good amount of history throughout. The village brings tourism year after year with hotel, caravan and glamping site and golf course. Powfoot gives you access to beach walks and lovely picturesque scenes over the Solway Firth to the Cumbrian Hills beyond.

GRENA

Grena is just 2 miles from the Scottish/England border and gives easy access to major road links north and south. Grena Green is famous for tying the knot and caters for thousands of eloping couples every year. It is an ever growing tourist spot with the historic Grena Green Famous Blacksmith's Shop and in recent years a developing retail outlet village (Grena Gateway). The town has a number of hotels and places to stay as well as places to eat. Local shops and small retail units including pharmacy line Central Avenue and the railway station is a short walk from the town.

DUMFRIES

This bustling town of Dumfries is set along the banks of the River Nith and is the largest town in South West Scotland. Dumfries has been a Royal Burgh since 1186. Dumfries is perhaps most well known for its many associations with Robert Burns, who lived here in the 1790s. The Robert Burns Centre is situated in an 18th century watermill and tells the story of Burns' last years in the town. The town was also home to J M Barrie for 5 years, the playwright best known for his work Peter Pan. Barrie played with friends at the Georgian house Moat Brae, which was restored and opened as a visitor attraction. It is now the National Centre for Children's Literature and Storytelling.

Dumfries has a wide variety of shops, large retail units, restaurants and places to stay, leisure facilities and commuter links making it a favourite of visitors to this part of Scotland.

LOCKERBIE

Lockerbie is a good-sized town 75 miles from Glasgow and 18 miles from the Scotland/England Border. It is a popular place to live and has a variety of local shops and has a supermarket. Lockerbie boasts the oldest ice rink in the UK and hosts curling events. It has Primary School and Secondary School, Town Hall, Library and Doctor's Surgery, Vets, Police Station. There are also a number of hospitality venues including hotels, cafes and takeaways and local pubs. Lockerbie has the main road and rail routes between Glasgow, Edinburgh and Carlisle. In the surrounding area of Lockerbie there are great places of historical interest and plenty of

outdoor leisure facilities.

SOUTH WEST

The South West of Scotland is well-known as having attractive unspoilt countryside and the diversity of sporting and recreational pursuits. There are good hill walking opportunities in the nearby Galloway Hills and cycling along the newly-designated cycle routes, as well as the Seven Stanes mountain bike routes in the Galloway Forest Park. The nearest of these is Dalbeattie Forest with its extensive network of specialist cycle paths, bridle ways and footpaths. There are varied sporting opportunities such as shooting as well as trout and salmon fishing on the regions numerous lochs and rivers. For golf enthusiasts, there is the championship course at Southemess and several other courses nearby, including the 9-hole courses at Castle Douglas, Dalbeattie, and New Galloway. Beautiful Loch Ken has a popular sailing centre with a number of water sports and activities available. The Solway coast is also popular with sailors with both Kippford and Kirkcubright having safe moorings. The National Trust for Scotland has a wonderful garden and house at Threave Estate which provides training for a number of horticulture students each year and a modern Visitor Centre with an excellent cafe and shop. In addition, Kirkcubright is the local 'Artists' Town' with a number of galleries offering a range of exhibitions throughout the year. Communications within the area are very good. There is a mainline railway station in Dumfries and Lockerbie, providing excellent links to both the north and south.

Fixtures and Fittings

All floor coverings, light fittings and blinds

Services

Main gas, electricity, water and drainage.

Central heating is provided by a gas-fired Viessmann Vitodens boiler, which is located in the kitchen and serves wall mounted radiators throughout the property. The heating would appear to be controlled by a central programmer/thermostat and by individual thermostatic valves fitted to radiators.

Domestic hot water is provided by the central heating boiler, on demand. As the boiler is of a combi design, no additional water storage tanks are required in the property.

EPC

D

Council Tax

B

Offers

Offers should be submitted in proper legal form to the Selling Agents. Any prospective purchaser wishing to be informed of a closing date should notify the Selling Agents as soon as possible. The Selling Agents reserve the right to sell the property without setting a closing date and do not bind themselves to accept the highest of any offer.

Interested in this property?

Annan

Call 01461 202

866/867

27 Bank Street, Annan,
Dumfries & Galloway, DG12 6AU
Phone: 01461 202 866/867
Email: Annan@cullenkilshaw.com

Opening Hours:
Monday to Friday: 9.00am to 5.00pm



Also At:

Galashiels, Tel 01896 758 311
Jedburgh, Tel 01835 863 202
Hawick, Tel 01450 3723 36
Kelso, Tel 01573 400 399
Melrose, Tel 01896 822 796
Peebles, Tel 01721 723 999
Selkirk, Tel 01750 723 868
Langholm, Tel 013873 80482
Annan, Tel 01461 202 866/867
Tranent, Tel 01875 611211

Full members of:



Whilst these particulars are prepared with care and are believed to be accurate neither the Selling Agent nor the vendor warrant the accuracy of the information contained herein and intending purchasers will be held to have satisfied themselves that the information given is correct.