

# Jukes & Co

## Estate Agents



## Alverston Gardens

, London, SE25 6LR

Price Guide £450,000



Guide price £450,000 to £475,000

A beautifully presented three-bedroom family home, ideally situated within a quiet and sought-after cul-de-sac in the heart of South Norwood.

This stunning property offers spacious and well-balanced accommodation throughout, including a bright and generous lounge, a stylish 20ft modern kitchen, three well-proportioned bedrooms and a luxurious contemporary shower room finished to an excellent standard. Outside, the home benefits from a neat and private rear garden together with valuable off-street parking.

A standout feature is the attached side garage, offering exciting potential to convert into a large playroom, home office, additional lounge or gym, subject to the usual consents.

Perfectly positioned a short walk to Norwood Junction Station, providing the fast and convenient 12-minute link into London Bridge, the property is ideal for commuters. South Norwood also offers an excellent range of local



## Area Map

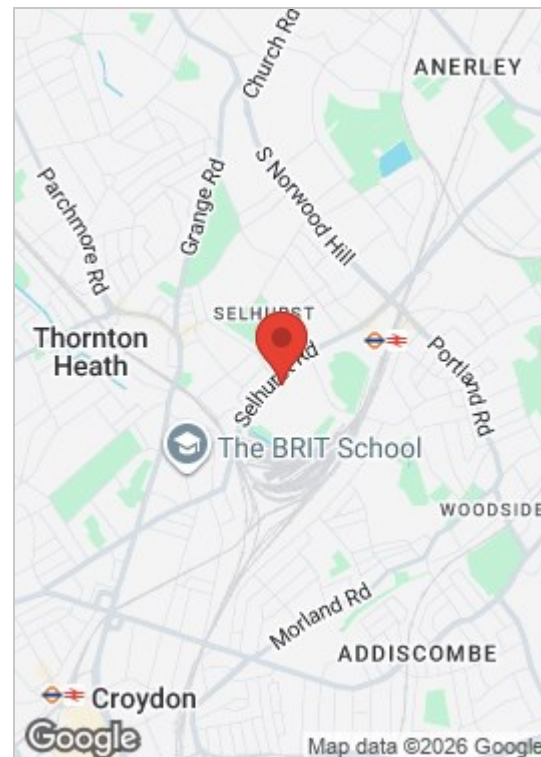

## Floor Plan

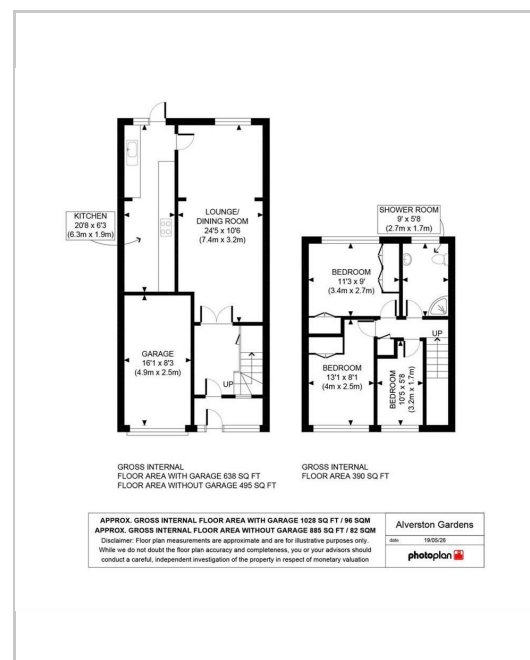

## Energy Efficiency Graph

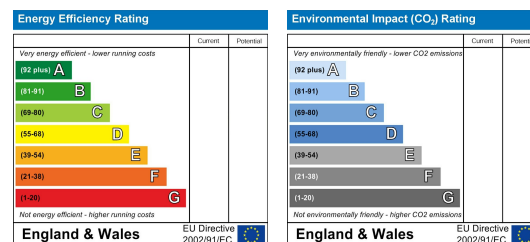

These particulars, whilst believed to be accurate are set out as a general outline only for guidance and do not constitute any part of an offer or contract. Intending purchasers should not rely on them as statements of representation of fact, but must satisfy themselves by inspection or otherwise as to their accuracy. No person in this firm's employment has the authority to make or give any representation or warranty in respect of the property.

### Sales and Lettings

76 High Street, South Norwood, London SE25 6EB

T: 020 8653 9393 · F: 020 8771 5551 · E: sales@jukesestateagents.com · E: lettings@jukesestateagents.com

W: jukesestateagents.com