

KEYSTONE



Stokebridge Maltings, Dock Street, Ipswich, IP2 8EU

£725 PCM

- Unfurnished One Bedroom Ground Floor Apartment
- NEW KITCHEN inc Oven & Hob, plumbing for washing machine
- Lounge
- EPC rating D
- NEW Flooring
- Entrance hall
- Electric Storage Heating
- New Decoration
- Double bedroom
- NO PARKING

GROUND FLOOR
458 sq.ft. (42.6 sq.m.) approx.

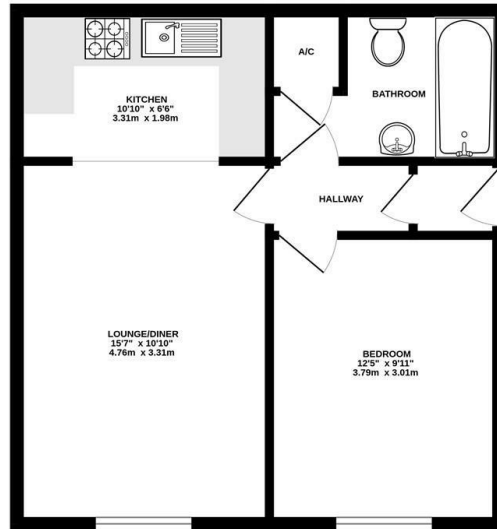

TOTAL FLOOR AREA: 458 sq.ft. (42.6 sq.m.) approx.
While every attempt has been made to ensure the accuracy of the floorplan contained here, measurements of doors, windows, rooms and any other items are approximate and no responsibility is taken for any error, omission or misstatement. This plan is for illustrative purposes only and should be used as such by any prospective purchaser. The services, systems and appliances shown have not been tested and no guarantee as to their operation or efficiency can be given.
Made with Metropix C2020

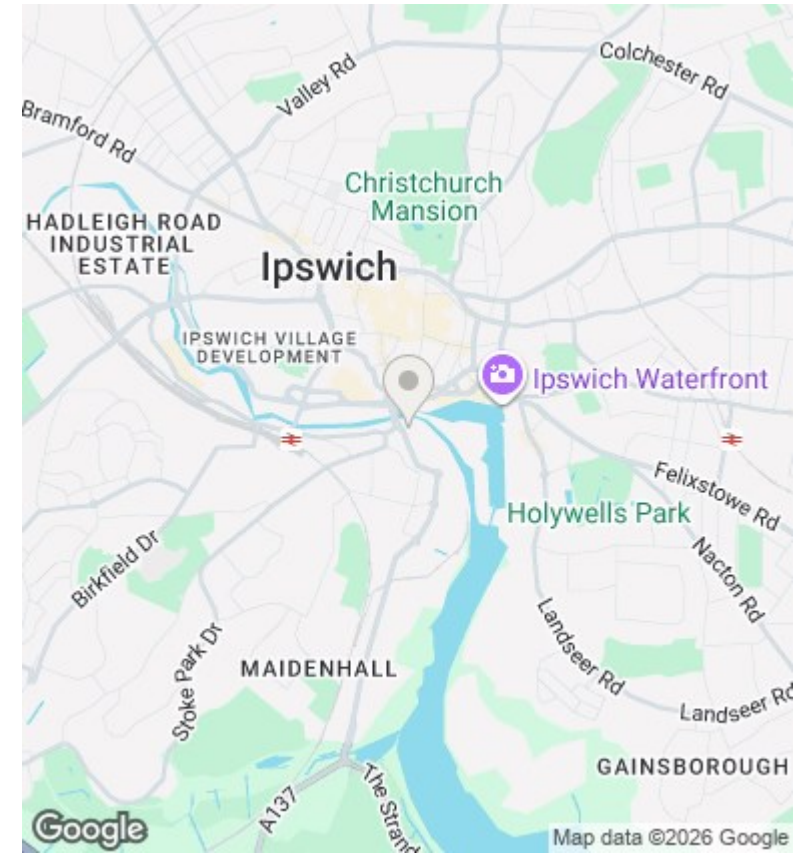

Directions

Viewings

Viewings by arrangement only. Call 01473 221 399 to make an appointment.

EPC Rating:
D

Energy Efficiency Rating		Current	Potential
<i>Very energy efficient - lower running costs</i>			
(92 plus) A			
(81-91) B			
(69-80) C			80
(55-68) D		59	
(39-54) E			
(21-38) F			
(1-20) G			
<i>Not energy efficient - higher running costs</i>			
England & Wales		EU Directive 2002/91/EC	