



## Chesson Road, W14

£475,000

A smart one bedroom apartment with a private patio garden, situated on a popular residential road. The property offers has an excellent layout with a double bedroom, spacious living space with access to the garden and a modern kitchen.

Chesson Road is just off North End Road and is very close to West Brompton Underground. The closest superstore is Tesco's on the North End Road and there are many bus routes on the North End Road that lead into the city.

### Features

- Share Of Freehold
- One Bedroom
- Patio Garden
- Close To Tubes
- Popular Location
- Private Entrance

# Chesson Road, London, W14

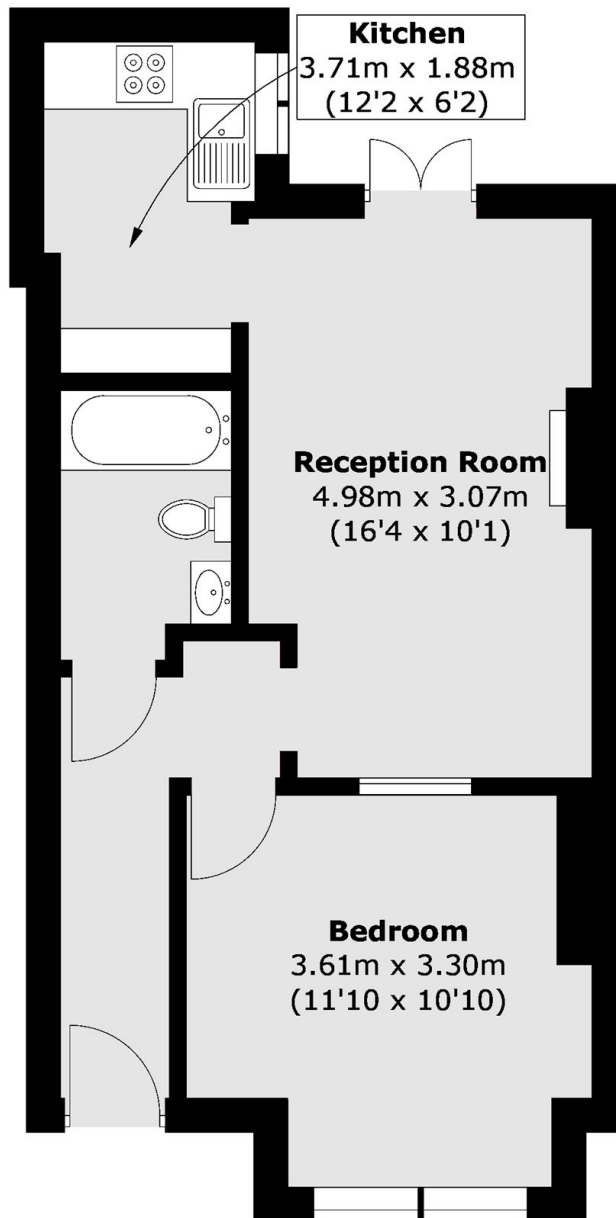

Total area (approx.): 42.2 sq. m (454.2 sq. ft)