



## Hartington Road, SW8

£295,000

A well presented one-bedroom purpose-built flat in good condition throughout. Spacious and well proportioned, the property features a separate kitchen and bright living room, with an abundance of natural light and excellent storage throughout. Further benefits include a private balcony and access to communal gardens.

Hartington Road is a fantastic street, quietly located just moments from Nine Elms Tube station and within a short walk of Stockwell tube and Vauxhall bus, train and tube stations. Perfectly suited for commuters, the area offers excellent transport links with numerous nearby bus routes, while also benefiting from a wide range of local amenities including a Sainsbury's superstore, coffee shops, and everyday conveniences.

### Features

- One Bedroom
- Purpose Built
- Separate living room and kitchen
- Balcony
- Communal Gardens

# Hartington Road, London, SW8

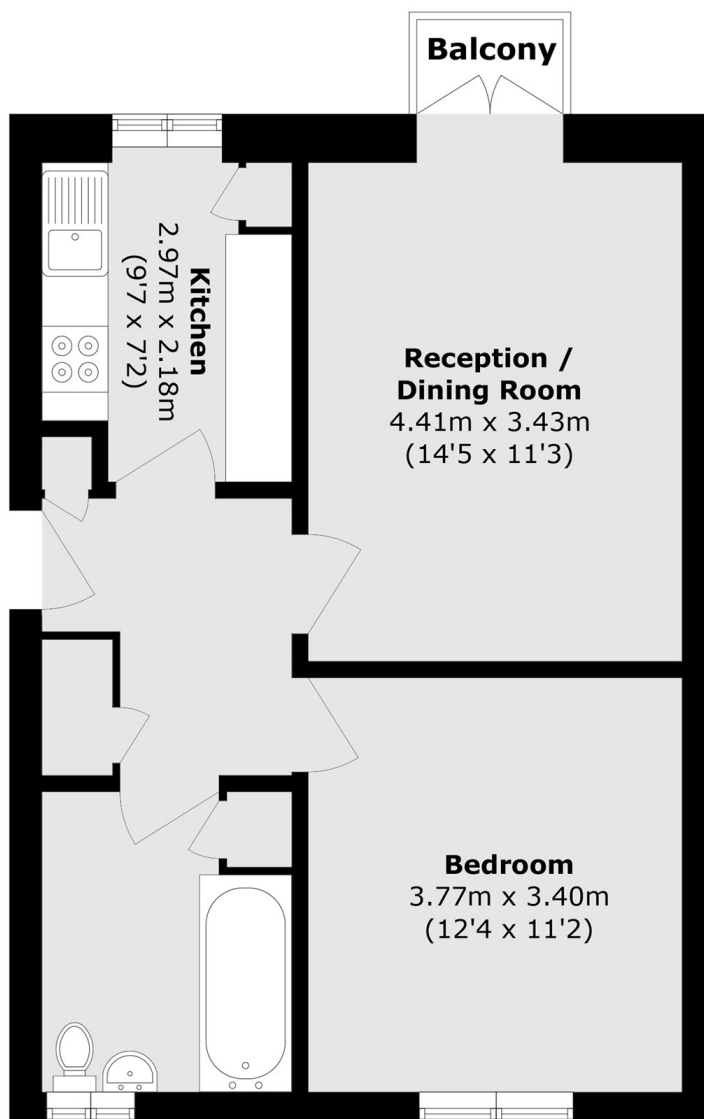

Total area (approx.): 50.1 sq. m (539.3 sq. ft)

Balcony area (approx.): 1.1 sq. m (11.8 sq. ft)