



jordan fishwick

WHALLEY RANGE
Withington Road



Withington Road, Whalley Range, M16 8RP

£1,100 Per Calendar Month



The Property

*** AVAILABLE JULY *** A good sized two-bedroom apartment located within this highly desirable purpose built complex. Close by to Whalley Range and Chorlton's amenities, the property is located in a great location. The accommodation comprises of living room, fully fitted kitchen, one generous double bedroom with a second double room- all with built in storage and three-piece bathroom with shower over bath. Available furnished. Unallocated gated on-site parking to the rear, subject to availability. Additional on street parking available close by without the need for a permit from the council, at the time of writing. Contact our Didsbury office to arrange a viewing.

EPC Rating C // Council Tax Band A

Directions

M16 8RP



- Available July
- Two Double Bedrooms
- Apartment
- Furnished
- Great Location of Whalley Range
- Close to all Local Amenities
- Gated On Site Parking
- Council Tax Band A
- EPC Rating C

Postcode - M16 8RP

EPC Rating - C

Floor Area - sq ft

Local Authority - Manchester

Council Tax - A



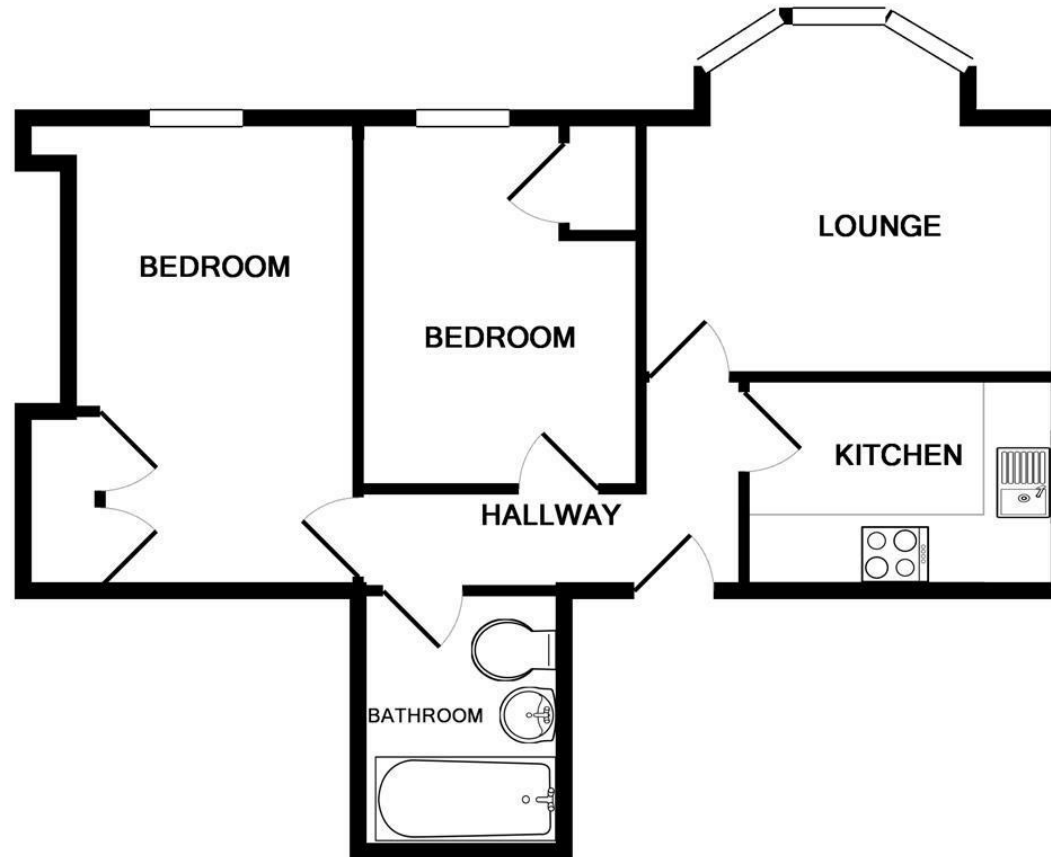

TOTAL APPROX. FLOOR AREA 474 SQ.FT. (44.1 SQ.M.)

Whilst every attempt has been made to ensure the accuracy of the floor plan contained here, measurements of doors, windows, rooms and any other items are approximate and no responsibility is taken for any error, omission, or mis-statement. This plan is for illustrative purposes only and should be used as such by any prospective purchaser. The services, systems and appliances shown have not been tested and no guarantee as to their operability or efficiency can be given

Made with Metropix ©2016



These particulars are believed to be accurate but they are not guaranteed and do not form a contract. Neither Jordan Fishwick nor the vendor or lessor accept any responsibility in respect of these particulars, which are not intended to be statements or representations of fact and any intending purchaser or lessee must satisfy himself by inspection or otherwise as to the correctness of each of the statements contained in these particulars. Any floorplans on this brochure are for illustrative purposes only and are not necessarily to scale.

Offices also at: Wilmslow, Macclesfield, Hale, Sale, Chorlton, Glossop, Manchester & Salford

757-759 Wilmslow Road, Didsbury Village, Manchester

0161 445 4480

didsbury@jordanfishwick.co.uk
www.jordanfishwick.co.uk