



Clements estate agents



Marlowes, Hemel Hempstead, HP1 1BE

£130,000

Located in Hemel Hempstead Town Centre is this spacious and well presented split level flat. Boasting two double bedrooms, 14'10 living room, fitted kitchen, double glazing and is being sold with the benefit of no upper chain.

Situated close to all of the Towns shopping, restaurant and travel facilities and within easy reach of the M1, M25 and A41 road links this is the perfect first time purchase or buy to let opportunity.

Communal Hallway

Entrance Hall

Living Room 14'10 x 11'7 (4.52m x 3.53m)

Fitted Kitchen 12'4 x 7'6 (3.76m x 2.29m)

Bathroom

Landing

Bedroom One 14'10 x 10'6 (4.52m x 3.20m)

Bedroom Two 14'9 x 8'10 (4.50m x 2.69m)

Floor Plan

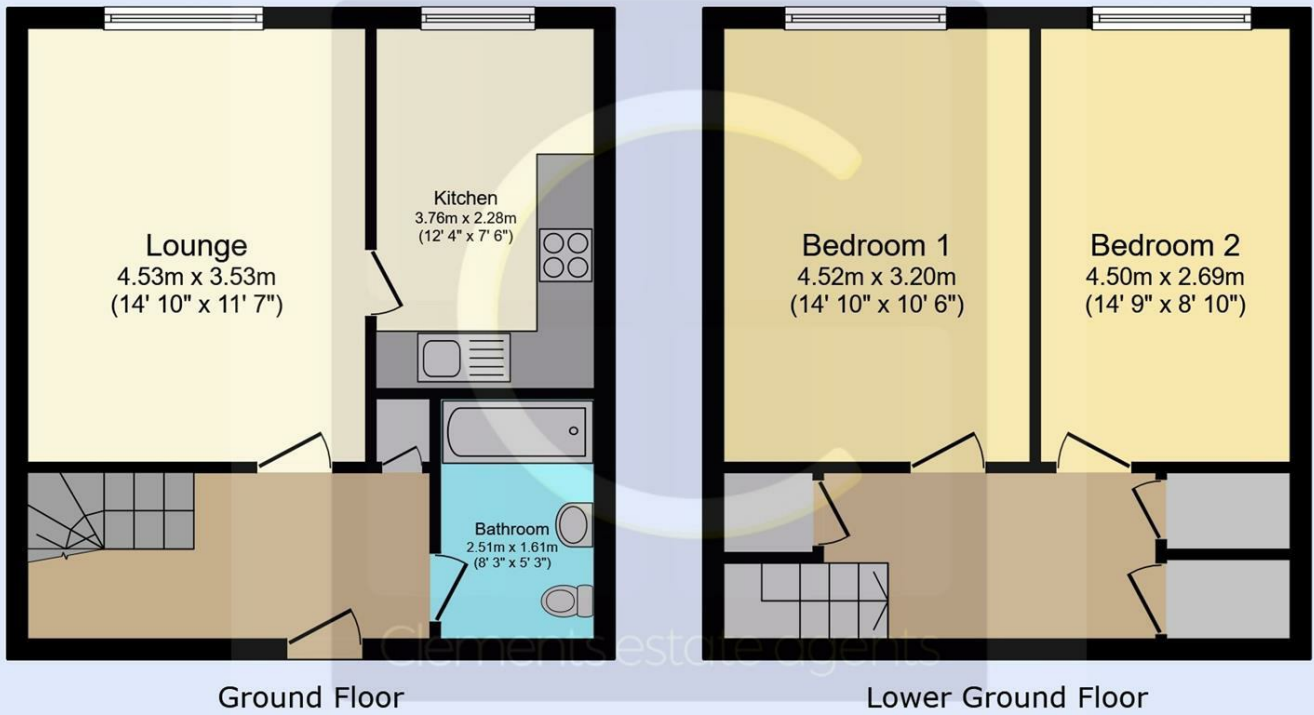

This floor plan is for illustrative purposes only. It is not drawn to scale. Any measurements, floor areas (including any total floor area), openings and orientations are approximate. No details are guaranteed, they cannot be relied upon for any purpose and do not form any part of any agreement. No liability is taken for any error, omission or misstatement. A party must rely upon its own inspection(s). Powered by www.Propertybox.io



Area Map



Energy Efficiency Graph

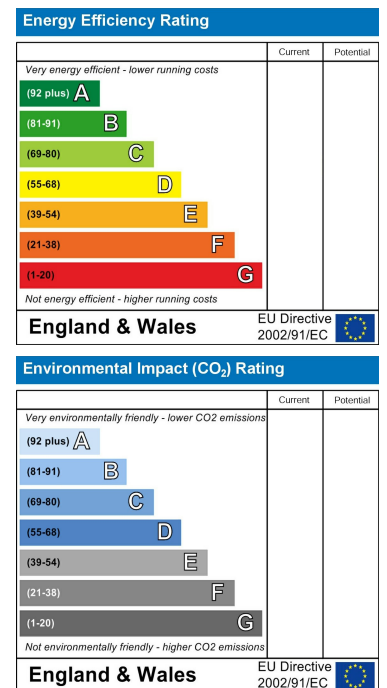

These particulars, whilst believed to be accurate are set out as a general outline only for guidance and do not constitute any part of an offer or contract. Intending purchasers should not rely on them as statements of representation of fact, but must satisfy themselves by inspection or otherwise as to their accuracy. No person in this firm's employment has the authority to make or give any representation or warranty in respect of the property.