



55 Rossington Street

, Manchester, M40 1PG

£850 Per Month



AVAILABLE DECEMBER***TWO BEDROOMS***TWO RECEPTION ROOMS***WELL PRESENTED***SPACIOUS***CENTRAL LOCATION***GREEN ASPECT*** Cousins Estate Agents are pleased to bring this ATTRACTIVE TWO BEDROOM TERRACE for LET centrally located in Newton Heath, Manchester.

Well presented throughout, the accommodation comprises: Entrance Vestibule, Living room, Lounge/Diner, Fitted kitchen, two spacious bedroom with ancillary storage and a bathroom suite.

Externally, the property is garden fronted and there is a private, low maintenance yard area to the rear.

This centrally located, spacious home will appeal to a small family or investor!



Entrance Hall 3'3"*3'3" (1*1)
Living Room 13'1"*11'3" (4*3.45)
Lounge/Diner 13'1"*11'9" (4*3.6)
Kitchen 7'10"*6'11" (2.4*2.12)
Front Bedroom 13'1"*11'3" (4*3.45)
Back Bedroom 12'0"*6'6" (3.67*2)
Bathroom 8'10"*6'3" (2.7*1.93)

Area Map

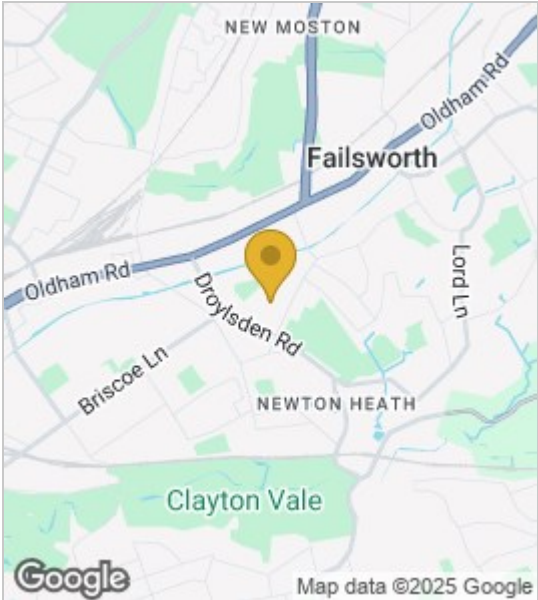

Floor Plans

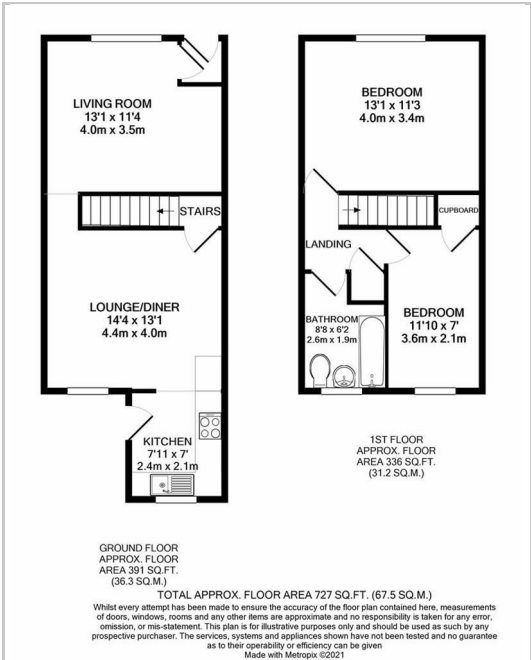

Energy Efficiency Graph

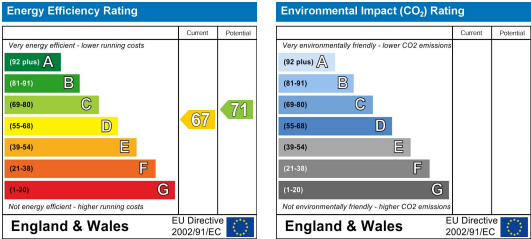

These particulars, whilst believed to be accurate are set out as a general outline only for guidance and do not constitute any part of an offer or contract. Intending purchasers should not rely on them as statements of representation of fact, but must satisfy themselves by inspection or otherwise as to their accuracy. No person in this firms employment has the authority to make or give any representation or warranty in respect of the property.

