



Roxton Court, Kimberley
£925 PCM

 **Comfort**
Estates



Roxton Court

Kimberley, Nottingham

Comfort Estates are delighted to present this two-bedroom mid-terraced home, ideally situated in the popular residential location of Roxton Court, Kimberley.

Offering modern and comfortable accommodation throughout, the property comprises two generous double bedrooms, a contemporary bathroom, a fully fitted kitchen complete with integrated appliances, and a spacious living area perfect for relaxing and entertaining.

To the rear, the property benefits from a private enclosed garden with a patio area, providing an ideal outdoor space to enjoy during the warmer months.

Conveniently located within walking distance of local shops, supermarkets and other amenities, the property also offers excellent transport links, including easy access to the M1 via Junction 26, making it ideal for commuters.

Further benefits include an allocated parking space outside the property. The property is offered unfurnished and is available from 1st August 2026.

Perfect for a professional individual, couple or small family, early viewing is highly recommended.





Kitchen

The kitchen is fitted with a range of wall and base units, offering ample storage and generous worktop space. Integrated appliances include an electric hob, oven, extractor fan and fridge/freezer, with a dedicated space and plumbing for a washing machine. Finished with laminate flooring, white tiled splashbacks and neutrally painted walls, the kitchen provides a practical and contemporary space.

Lounge/Diner

Located at the rear of the property, the living and dining area is bright and spacious, offering ample room for both lounge and dining furniture. Finished with grey carpet and white walls, the room provides a neutral backdrop to suit a range of styles. French doors open directly onto the enclosed rear garden, allowing plenty of natural light to flood the space and creating an excellent indoor-outdoor connection.

Rear Bedroom

Spacious bedroom with a large window, filling the space with natural light. The room is decorated with grey carpet and white walls.

Front Bedroom

A further bedroom is located at the front of the property and is neutrally decorated with grey carpet and white walls. The room offers a bright and versatile space, ideal as a bedroom or home office.

Bathroom

A modern bathroom finished with stylish grey wall tiles, laminate flooring and white painted walls. The suite comprises a bath with shower over, wash hand basin, WC and a wall-mounted mirror, creating a bright, contemporary and practical space.





Comfort Estates

GROUND FLOOR

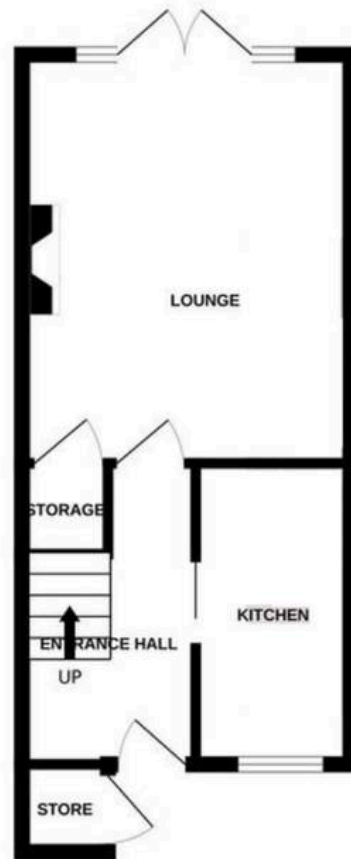

1ST FLOOR

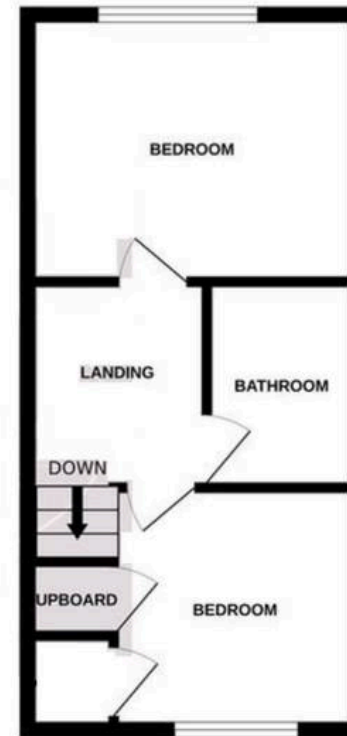

Total approx: 59m²



Comfort Estates

Comfort Estates, 47 Derby Road - NG1 5AW

0115 933 8997 • info@comfortestates.co.uk • www.comfortestates.co.uk