





S Stuart
Rushton



S Stuart
Rushton



S Stuart
Rushton



S Stuart
Rushton

Land at Piggishaw, Altrincham Road

Wilmslow

An excellent small residential development site of just over an acre, situated on the outskirts of Wilmslow, tucked away off Altrincham Road in a pretty and peaceful spot with a charming backdrop over Piggishaw Brook.

Planning permission in principle (PIP) has been granted by Cheshire East in March this year for four detached dwellings with a total of 10,462 square feet (inc garages).

Tenure: Freehold

- Excellent residential development site for four detached houses on the edge of Wilmslow town centre
- Permission in principle application granted by Cheshire East in 2026 (25/3610/OUT)
- In all just over an acre, bordering a pretty brook and set back off Altrincham Road
- Offers invited for the Freehold interest



Schedule:

4no. detached 2 storey houses with double garages

**Total area (incl. garages) -
972sqm (10,462sqft) indicated
max 1,000sqm (10,764sqft)**

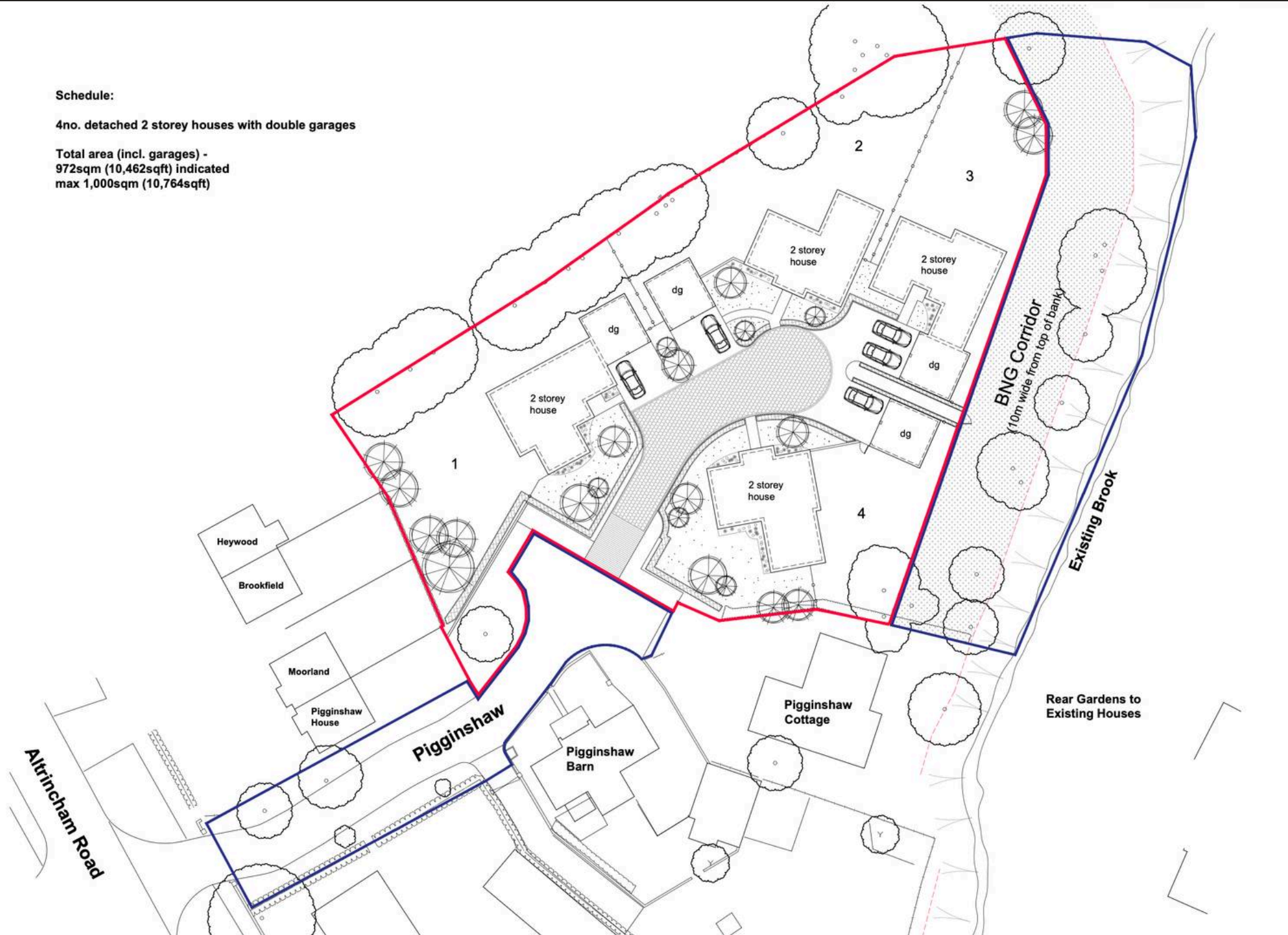



Stuart Rushton & Company

Stuart Rushton & Co, 35 King Street – WA16 6DW

01565 757000

enquiries@srushton.co.uk

www.srushton.co.uk



**Stuart
Rushton**
& COMPANY

We are not authorised to make or give any representations or warranties in relation to the property either here or elsewhere. We assume no responsibility for any statement that may be made in these particulars, and they do not form part of any offer or contract and must not be relied upon as statements or representation of fact. Any areas, measurements or distances are approximate. The text, photographs and plans are for guidance only. Importantly, it should not be assumed that the property has all necessary planning, building regulations or other consents and we have not tested any services, equipment or facilities. Purchasers must satisfy themselves by inspection or otherwise.