



Pelton Road

Greenwich, SE10

£2,050 per month
(£473.08 per week)

A well-presented two-bedroom furnished apartment close to Greenwich Park, offering a spacious reception room, modern kitchen and contemporary bathroom. The property further benefits from bike storage and access to a communal garden.

CHESTERTONS



Pelton Road

Greenwich, SE10

- Situated in the heart of Greenwich
- Spacious layout with well-sized rooms
- Close to local shops, schools, and amenities
- Excellent transport links to Central London



A well-presented two-bedroom furnished apartment located on Pelton Road, SE10, in the heart of Greenwich. The property offers a spacious reception room, two well-proportioned bedrooms, a modern fitted kitchen and a contemporary bathroom. It is offered fully furnished and is available for immediate occupation.

Additional benefits include bike storage and access to a communal garden.

Ideally positioned close to Greenwich Park, the River Thames and a wide range of local shops, cafés and restaurants. Excellent transport links are within easy reach, including Maze Hill Station and local bus

Minimum Term: 12 months
Deposit Required: £2,365.38
Local Authority: Royal Borough Of Greenwich
Council Tax Band: C
EPC Rating: C
Furnished

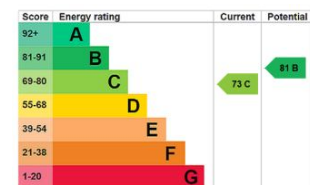

Chestertons Canary Wharf & Greenwich Lettings

Harbour Island
 28 Harbour Exchange Square
 Canary Wharf & Docklands
 London
 E14 9GE
 canarywharflettingsusers@chestertons.co.uk
 02075108310

Additional tenant charges apply (fees apply to non-AST tenancies only)
 Tenancy Agreement Fee: £300
 References per Tenant/Guarantor: £60
 Inventory check (approx. £100 – £250 inc. VAT)
 chestertons.co.uk/property-to-rent/applicable-fees

Pelton Road,
Greenwich, SE10

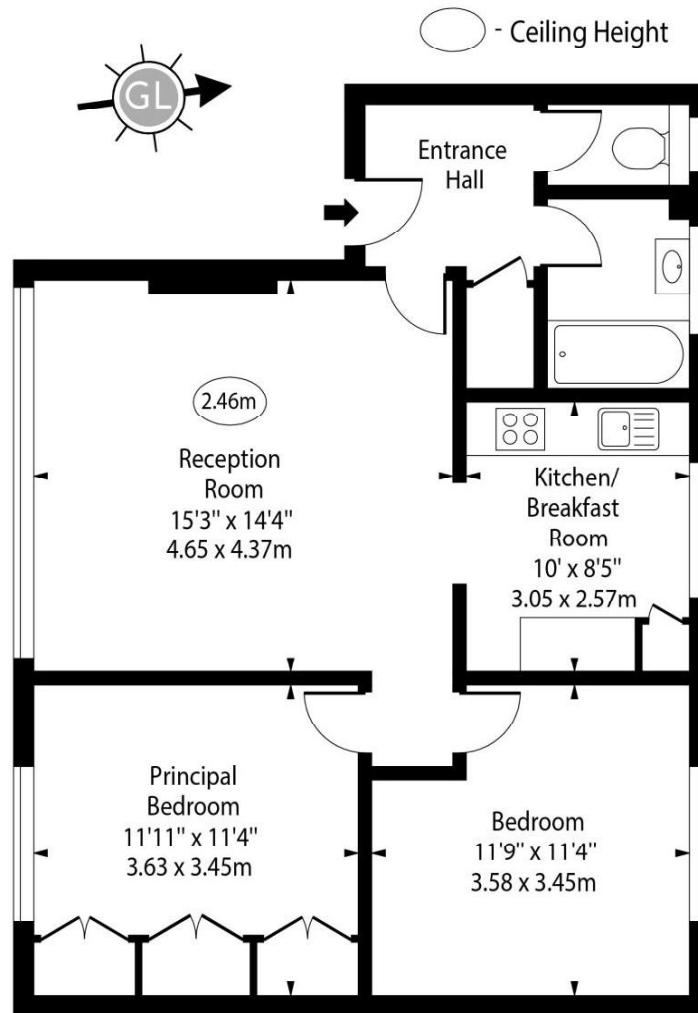

First Floor

Approx Gross Internal Area 720 Sq Ft - 66.89 Sq M

Every attempt has been made to ensure the accuracy of the floor plan shown. However, all measurements, fixtures, fittings, and data shown are approximate interpretations and for illustrative purposes only. Measured according to the RICS. Not To Scale.

www.goldlens.co.uk

Ref. No. 030544K

Chesterton UK Services Limited trading as Chestertons for themselves and for the vendor of this property whose agents they are, give notice that (i) these particulars do not constitute any part of an offer or contract, (ii) all statements contained within these particulars are made without responsibility on the part of Chestertons or the vendor, (iii) whilst made in good faith, none of the statements contained within these particulars are to be relied upon as a statement or representation of fact, (iv) any intending purchasers must satisfy themselves by inspection or otherwise as to the correctness of each of the statements contained within these particulars, (v) the vendor does not make or give either Chestertons or any person in their employment any authority to make or give representation or warranty whatsoever in relation to this property. Wide angle lenses may be used. ©Copyright Chestertons | Chesterton Global Ltd | Registered Office 40 Connaught Street, Hyde Park, London W2 2AB Registered Company Number 05334580.



This paper is
100% recyclable