

ALLDAY
& MILLER

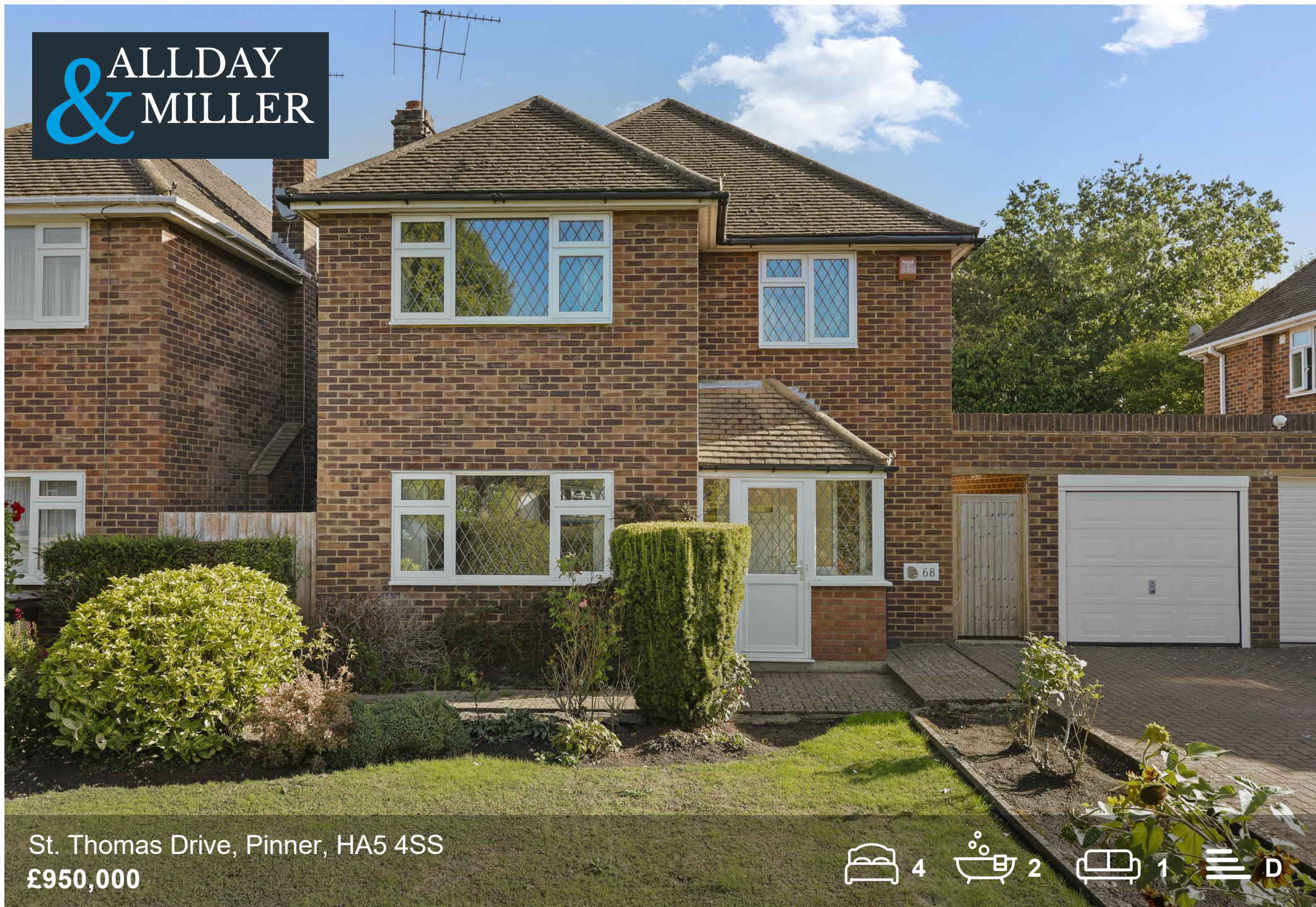

St. Thomas Drive, Pinner, HA5 4SS
£950,000

4 2 1 D



St. Thomas Drive, Pinner, HA5 4SS

£950,000

- Four Bedrooms
- Detached
- Two Reception Rooms
- Off Street Parking
- Close to Hatch End & Pinner High Road
- Chain Free
- Two Bathrooms
- Private Rear Garden
- Garage
- Highly Regarded Schools Nearby

Description

The ground floor features a spacious entrance hallway leading to a cosy lounge, a separate dining area, a well-appointed kitchen with ample storage, and a contemporary shower room.

Upstairs, the impressive master bedroom includes built-in wardrobes and plenty of natural light, complemented by three further bedrooms each with fitted wardrobes and a stylish family bathroom.

Outside, the property enjoys a meticulously maintained rear garden, mainly laid to lawn with a patio area ideal for al fresco dining and entertaining. To the front, a private driveway offers off-street parking and access to a double-length garage, providing additional storage or workshop potential.

Situation

Conveniently situated for both Hatch End and Pinner high streets where you can find a variety of shopping facilities, coffee houses, restaurants and supermarkets. For commuters, there are excellent transport facilities nearby with the Overground services available at Hatch End station and the Metropolitan line at Pinner station, both providing regular links into the City. The area is well served by local primary and secondary schooling, children's play areas and recreational facilities.



Floor Plans

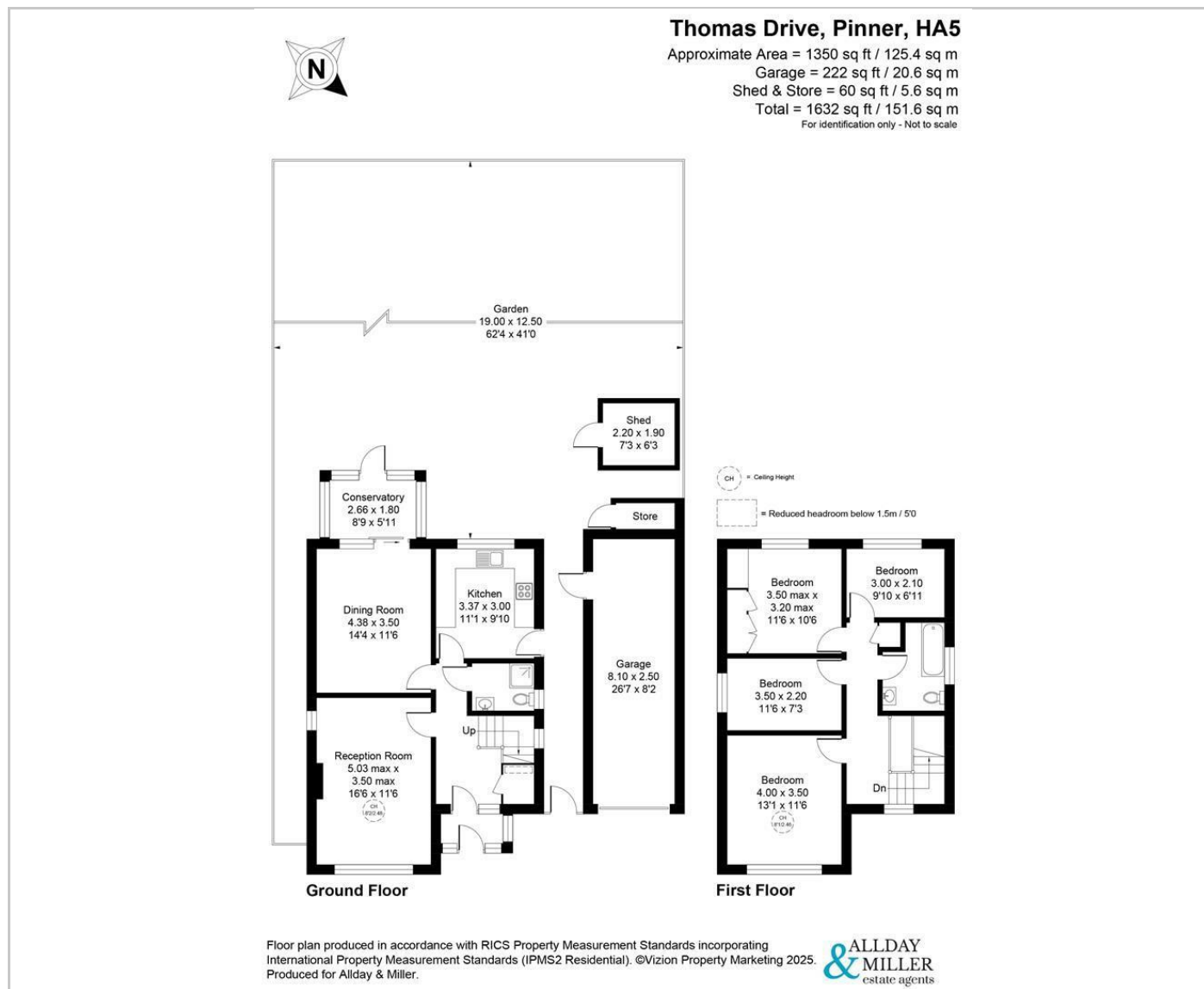

Area Map

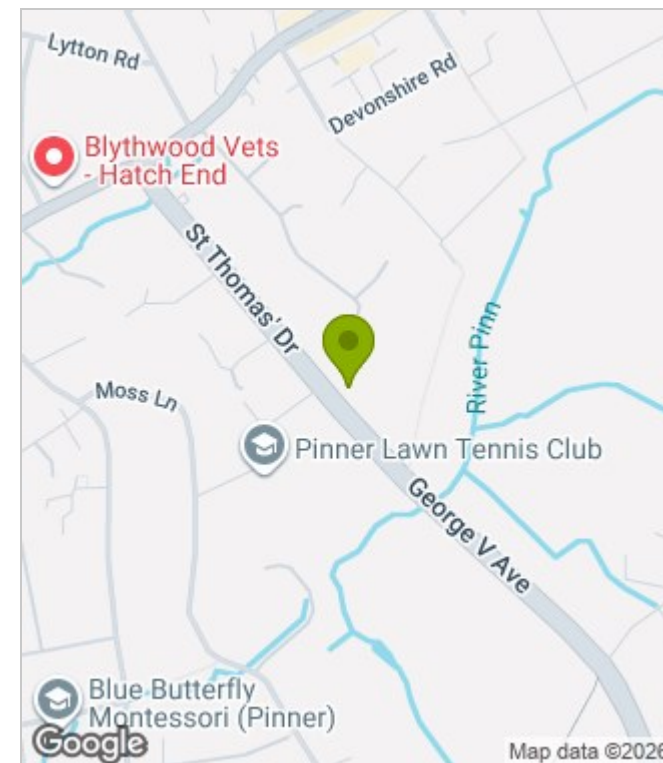

Energy Performance Graph

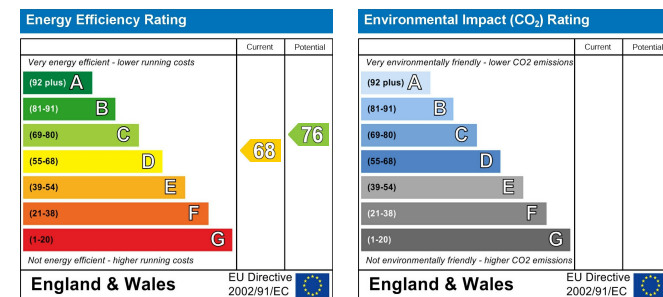

These particulars, whilst believed to be accurate are set out as a general outline only for guidance and do not constitute any part of an offer or contract. Intending purchasers should not rely on them as statements of representation of fact, but must satisfy themselves by inspection or otherwise as to their accuracy. No person in this firm's employment has the authority to make or give any representation or warranty in respect of the property.